



SECTIONS 2, 3, 4, 8, 9, 10, 11, 16, 17, 20, & 21, T4N, R25E, W.M.,  
 Marrow County, Oregon

Application S-53657, Permit S-40336  
 PARTIAL PERFECTION CLAIM OF BENEFICIAL USE MAP  
 City of Boardman



RECEIVED  
 DEC 29 2015  
 OWRD

EXPLANATION

-  PERMIT S-40336 - MUNICIPAL RIGHTS  
CITY OF BOARDMAN - PRIORITY: 9/22/1975
-  URBAN GROWTH BOUNDARY
-  COLLECTOR No. 1
- COLLECTOR No. 1 LOCATION: 2900 FT W AND 170 FT S  
FROM THE NE CORNER OF SECTION 9
- FLOWMETER LOCATION: 2460 FT W AND 920 FT S  
FROM THE NE CORNER OF SECTION 9

Site inspection conducted  
 December 10, 2015

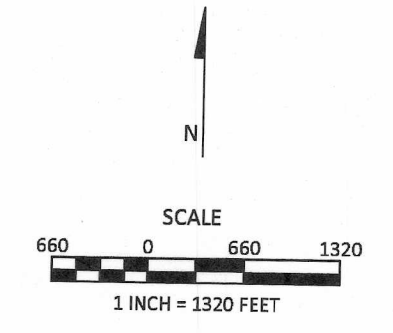
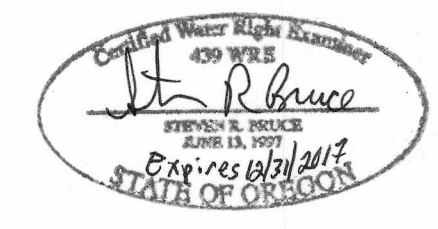

**SKOOKUM**  
 WATER ASSOCIATES, INC.  
 P.O. BOX 80174  
 PORTLAND, OR 97280  
 (503) 319-8926

COBU MAP # 967

December 23, 2015  
 This map is not intended to provide legal  
 dimensions or locations of property  
 ownership lines

FIGURE 1