

RECEIVED BY OWRD

JUL 13 2015

SALEM, OR

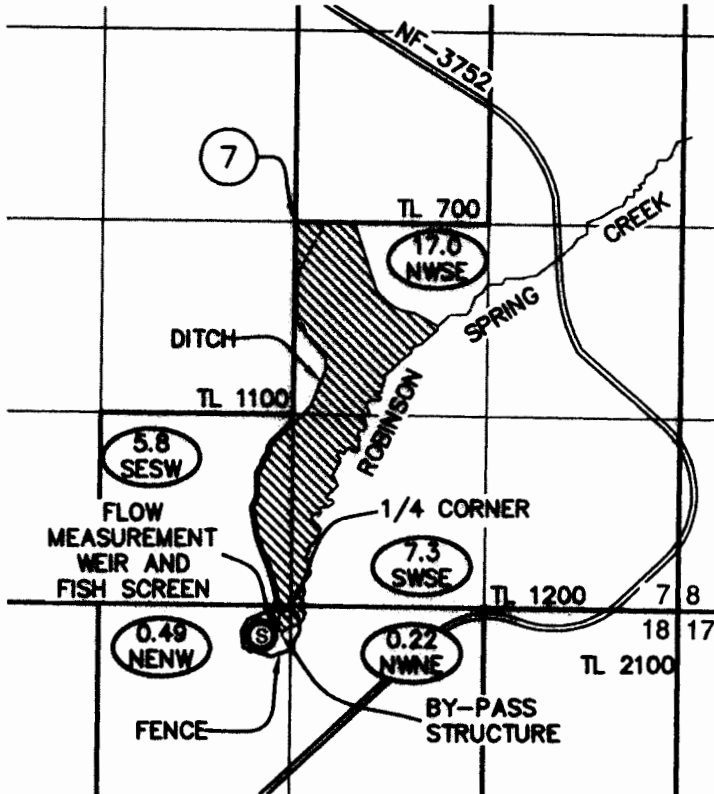
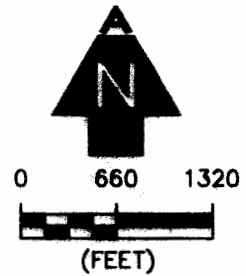

**LEGEND**

- SECTION LINE
- 1/4 1/4 LINE
- TAX LOT LINE
- CREEK
- DITCH LINE
- FENCE
- ROAD
- SECTION CORNER
- SECTION CENTER
- TAX LOT NUMBER
- POD (SPRING)
- IRRIGATED UNDER PERMIT S-53654
- IRRIGATED ACRES
- 1/4 1/4 SECTION

**NOTES**

1. THIS MAP WAS PREPARED FROM FIELD MEASUREMENTS, 2011 NAIP AERIAL PHOTOGRAPHY, AND KLAMATH COUNTY TAX MAP T38S, R15E W.M.
2. THIS MAP IS FOR THE PURPOSE OF IDENTIFYING THE LOCATION OF THE WATER RIGHT ONLY AND HAS NO INTENT TO PROVIDE DIMENSIONS OR LOCATION OF PROPERTY LINES.
3. FOR TAX LOT INFORMATION, SEE TAX MAPS INCLUDED WITH THIS COBU.
4. DATE OF PRIORITY FOR THIS APPLICATION IS APRIL 13, 1992.

**POD TIE**

POD 1-SPRING: SOUTH 45° 35' WEST 294 FEET FROM THE SOUTH 1/4 CORNER OF SECTION 7.

*Sylvia Bruce*  
APPLICANT

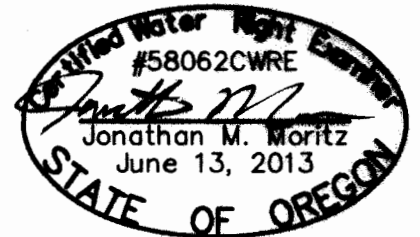

RENEWAL 12/31/16

**ADKINS**

CONSULTING  
ENGINEERING, LLP

Engineers ▲ Planners ▲ Surveyors

2950 Shasta Way · Klamath Falls, Oregon 97603 · (541) 884-4666 · FAX (541) 884-5335

Oregon · California

5-13-2015

1501-01

**CLAIM OF BENEFICIAL USE  
AND FINAL PROOF MAP**

FOR  
SYLVIA BRUCE  
T38S, R15E, WM  
KLAMATH COUNTY, OREGON  
APPLICATION No. S-72323  
PERMIT No. S-53654