

FINAL PROOF SURVEY MAP

T 10 S R 2 W, W.M. Section 9

prepared for: MILLER FORESTS, INC.

transfers: T-8845 & T-9922

RECEIVED

DEC 08 2006

**WATER RESOURCES DEPT
SALEM, OREGON**

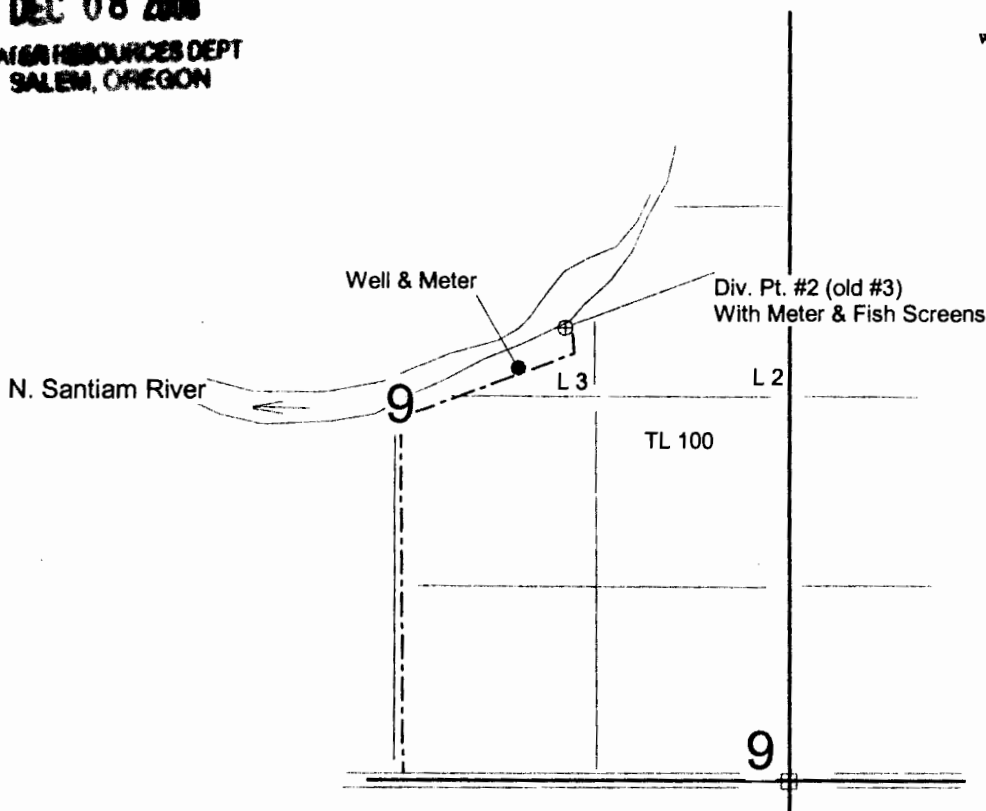

Div. Pt. #2 (old #3): 3150' N & 1540' W
Well: 2750' N & 1760' W
both from the SE corner Section 9

4" = 1 mile



This map is not intended to provide legal dimensions or locations of property ownership lines.



RENEWAL DATE: 6-30-2007

T.10S.R2W.WM

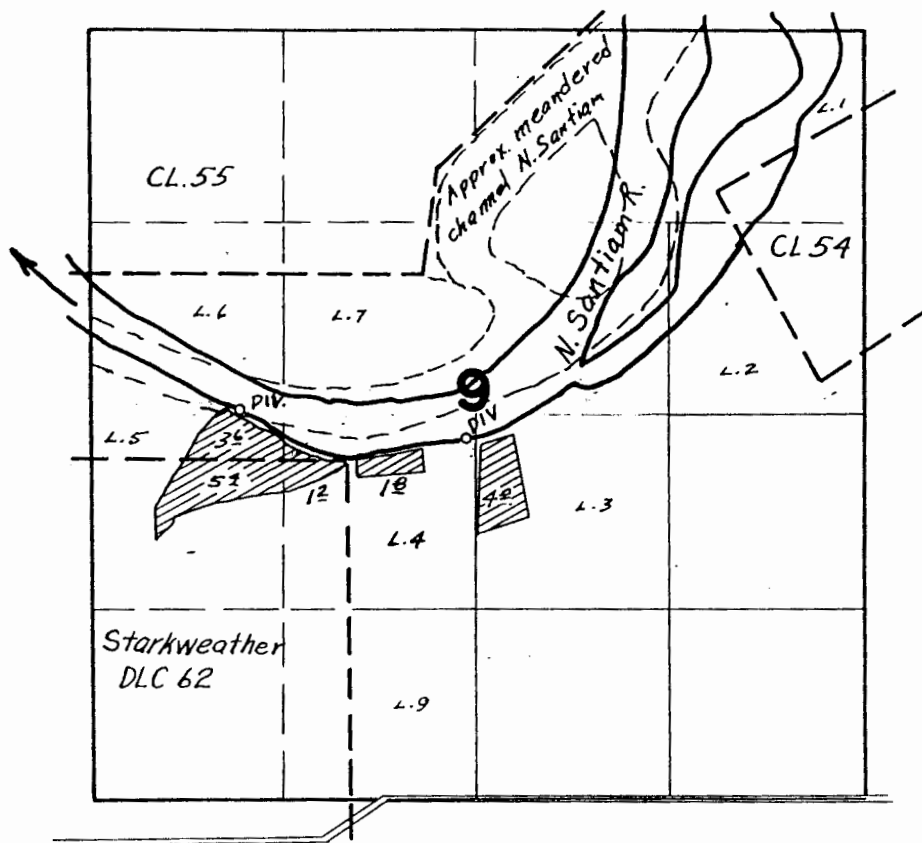

FINAL PROOF SURVEY

UNDER

Application No. 23598 Permit No. 18686

IN NAME OF

Kenneth F. Ellis

Surveyed July 8, 1954, by H. L. Coffman

DFN-3D-204