

# FINAL PROOF SURVEY MAP

T 10 S R 2 W, W.M. Section 9

prepared for: MILLER FORESTS, INC.

transfers: T-8845 & T-9922

**RECEIVED**

**DEC 08 2006**

**WATER RESOURCES DEPT  
SALEM, OREGON**

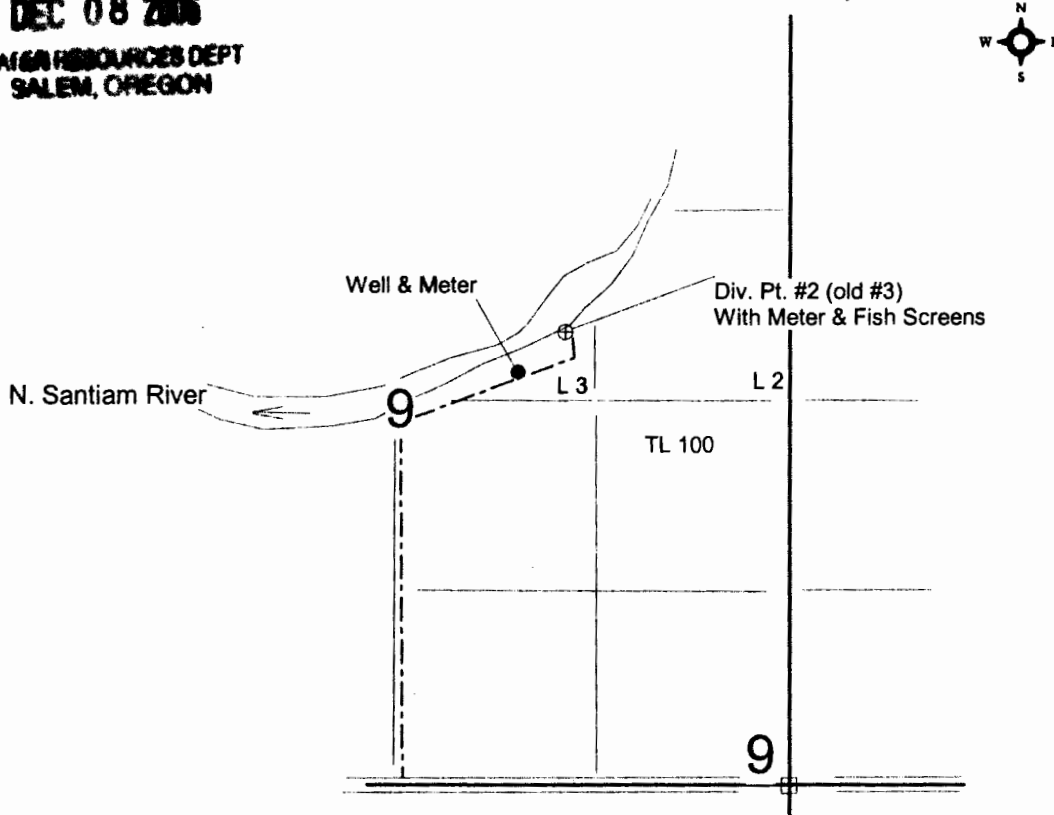

Div. Pt. #2 (old #3): 3150' N & 1540' W  
Well: 2750' N & 1760' W  
both from the SE corner Section 9

4" = 1 mile

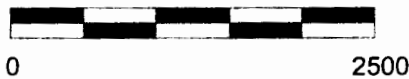

This map is not intended to provide legal dimensions or locations of property ownership lines.



RENEWAL DATE: 6-30-2007

# T.10S.R.2W.W.M.

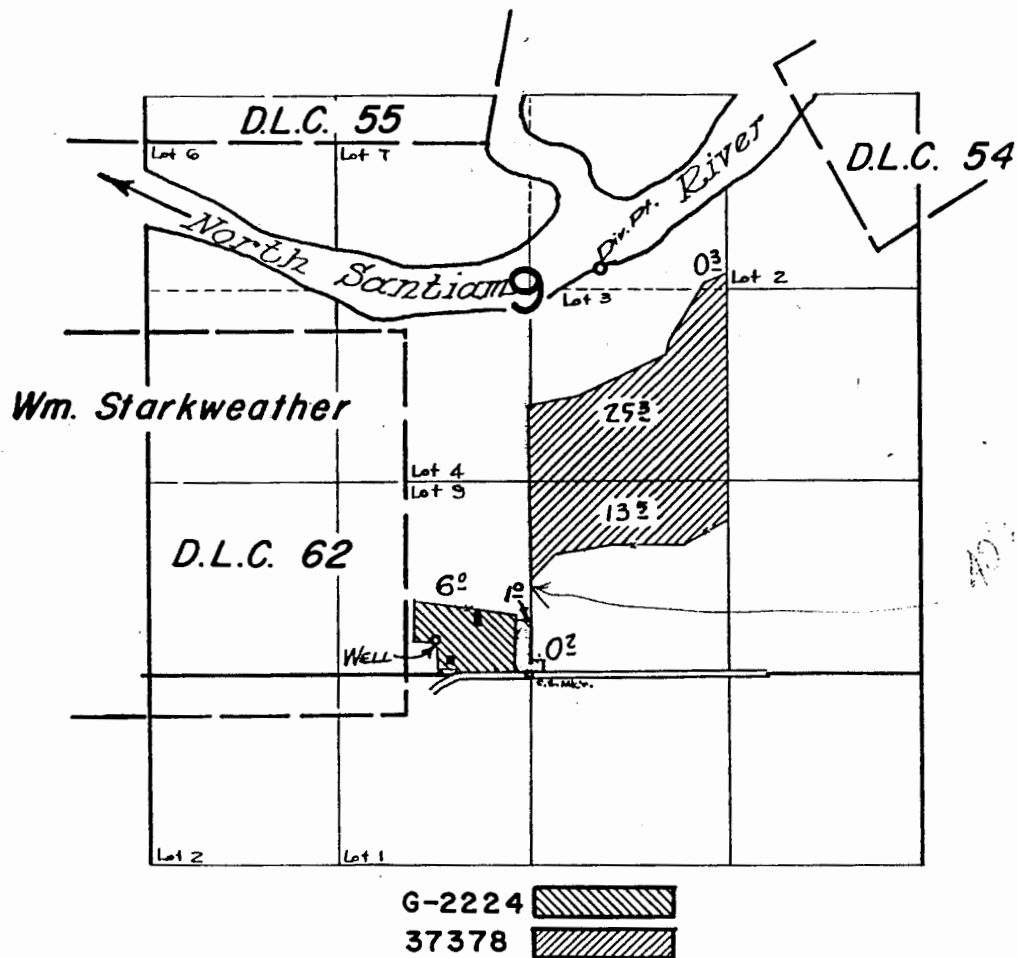

## FINAL PROOF SURVEY UNDER

G-2224                      G-2046  
Application No. 37378... Permit No. 27823...  
IN NAME OF

KENNETH ELLIS

Surveyed May 1, 1964, by