

T.10S.R.2W., W.M.

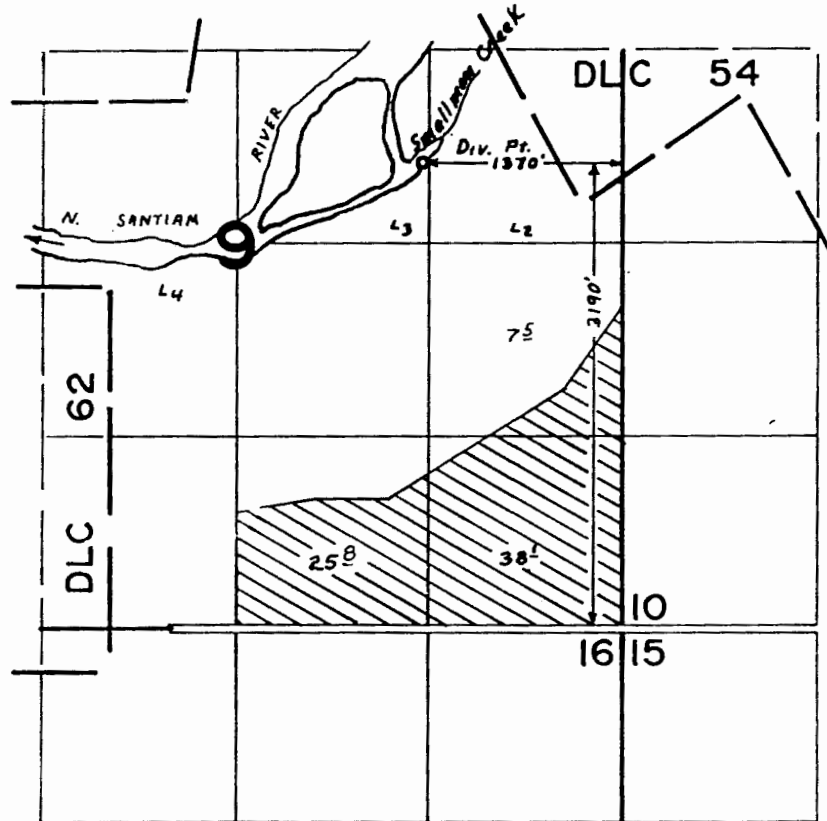

FINAL PROOF SURVEY UNDER

Application No. 50066... Permit No. 37628...
IN NAME OF

KENNETH & MYRTLE ELLIS

Surveyed APR. 12. 1978. by S.P. APPLIGATE

37378
23598
22300

FINAL PROOF SURVEY MAP

T 10 S R 2 W, W.M. Section 9

prepared for: MILLER FORESTS, INC.

transfers: T-8845 & T-9922

RECEIVED

DEC 08 2006

WATER RESOURCES DEPT
SALEM, OREGON

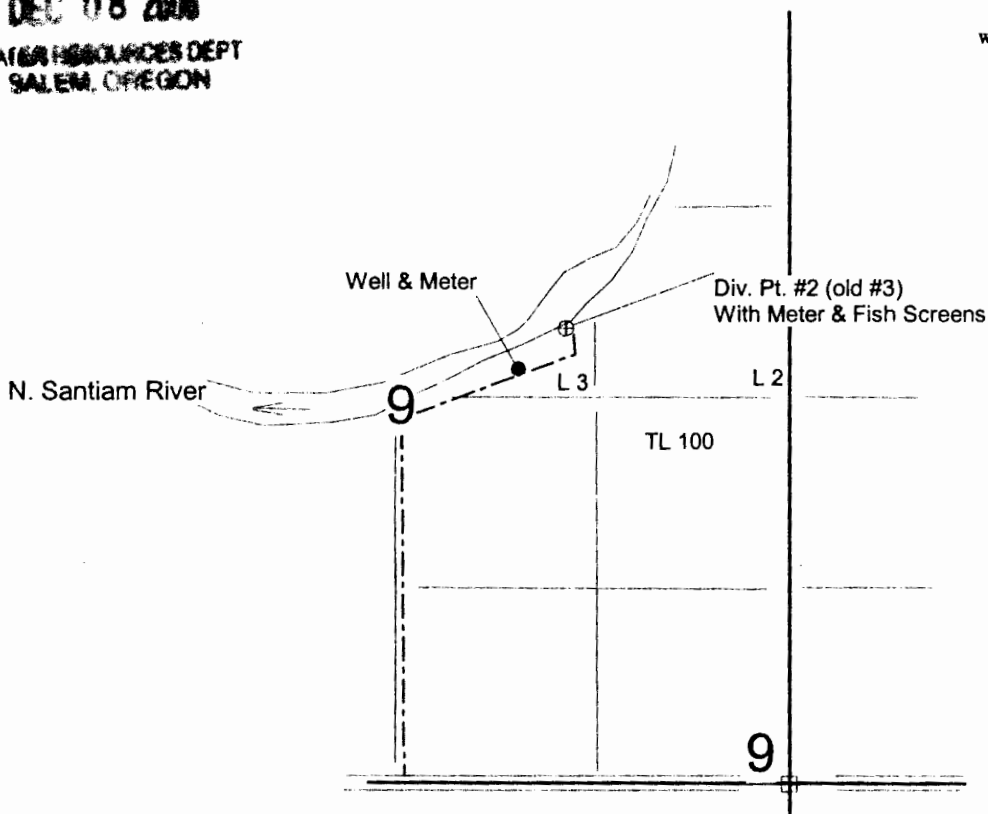

Div. Pt. #2 (old #3): 3150' N & 1540' W
Well: 2750' N & 1760' W
both from the SE corner Section 9

4" = 1 mile



This map is not intended to provide legal dimensions or locations of property ownership lines.



RENEWAL DATE: 6-30-2007