

FINAL PROOF SURVEY MAP IN THE NAME OF MILTON SMITH

APPLICATION R-73402
S-73403

PERMIT R-12109
53004

SECTION 26, TOWNSHIP 30 SOUTH, RANGE 15 WEST, W.M.

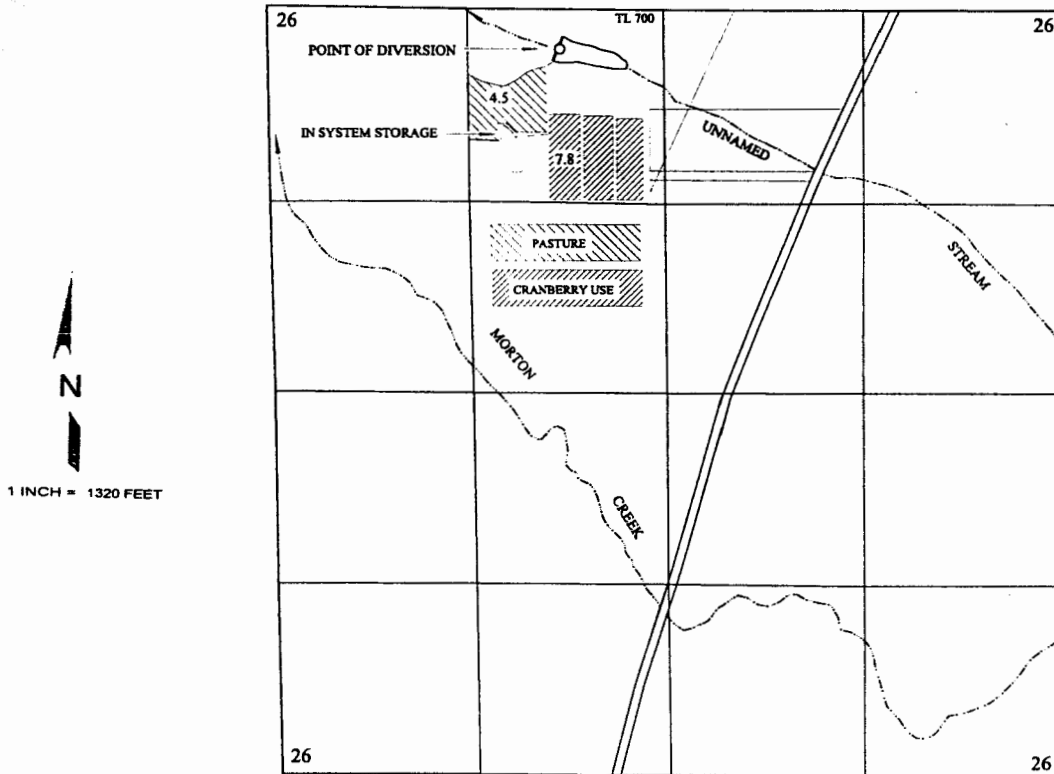

THE POINT OF DIVERSION IS LOCATED 300 FEET SOUTH AND 1980 FEET EAST FROM THE NORTHWEST CORNER OF SECTION 26, BEING WITHIN THE NE $\frac{1}{4}$ NW $\frac{1}{4}$ OF SECTION 26, TOWNSHIP 30 SOUTH, RANGE 15 WEST, W.M.; COOS COUNTY.

RECEIVED

NOV 19 1987

WATER RESOURCES DEPT
SALEM OREGON

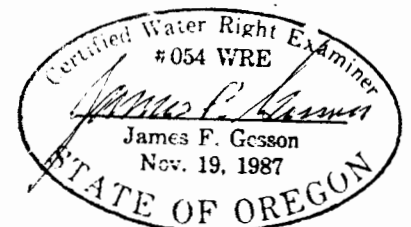

THE PURPOSE OF THIS MAP IS TO IDENTIFY THE LOCATION OF THE WATER RIGHT. IT IS NOT INTENDED TO PROVIDE INFORMATION RELATIVE TO THE LOCATION OF PROPERTY OWNERSHIP BOUNDARY LINES.