



SECTIONS 2, 3, 4, 8, 9, 10, 11, 16, 17, 20, & 21, T4N, R25E, W.M.,
Marrow County, Oregon

Application S-53657, Permit S-40336
PARTIAL PERFECTION CLAIM OF BENEFICIAL USE MAP
City of Boardman



RECEIVED
DEC 29 2015
OWRD

EXPLANATION

-  PERMIT S-40336 - MUNICIPAL RIGHTS
CITY OF BOARDMAN - PRIORITY: 9/22/1975
-  URBAN GROWTH BOUNDARY
-  COLLECTOR No. 1
- COLLECTOR No. 1 LOCATION: 2900 FT W AND 170 FT S
FROM THE NE CORNER OF SECTION 9
- FLOWMETER LOCATION: 2460 FT W AND 920 FT S
FROM THE NE CORNER OF SECTION 9

Site inspection conducted
December 10, 2015

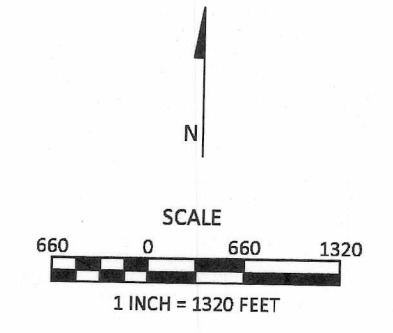

SKOOKUM
WATER ASSOCIATES, INC.
P.O. BOX 80174
PORTLAND, OR 97280
(503) 319-8926

COBU MAP # 967

December 23, 2015
This map is not intended to provide legal
dimensions or locations of property
ownership lines

FIGURE 1