

PREPARED FOR:
 MICHAEL HINTERMEYER
 13501 FORD ROAD
 GASTON, OREGON

CLAIM OF BENEFICIAL USE MAP

SECTION 12, T2S, R5W, W.M.
 YAMHILL COUNTY, OREGON
 APPLICATIONS #S-80298 & R-80297,
 PERMITS #S-52053 & R-11739

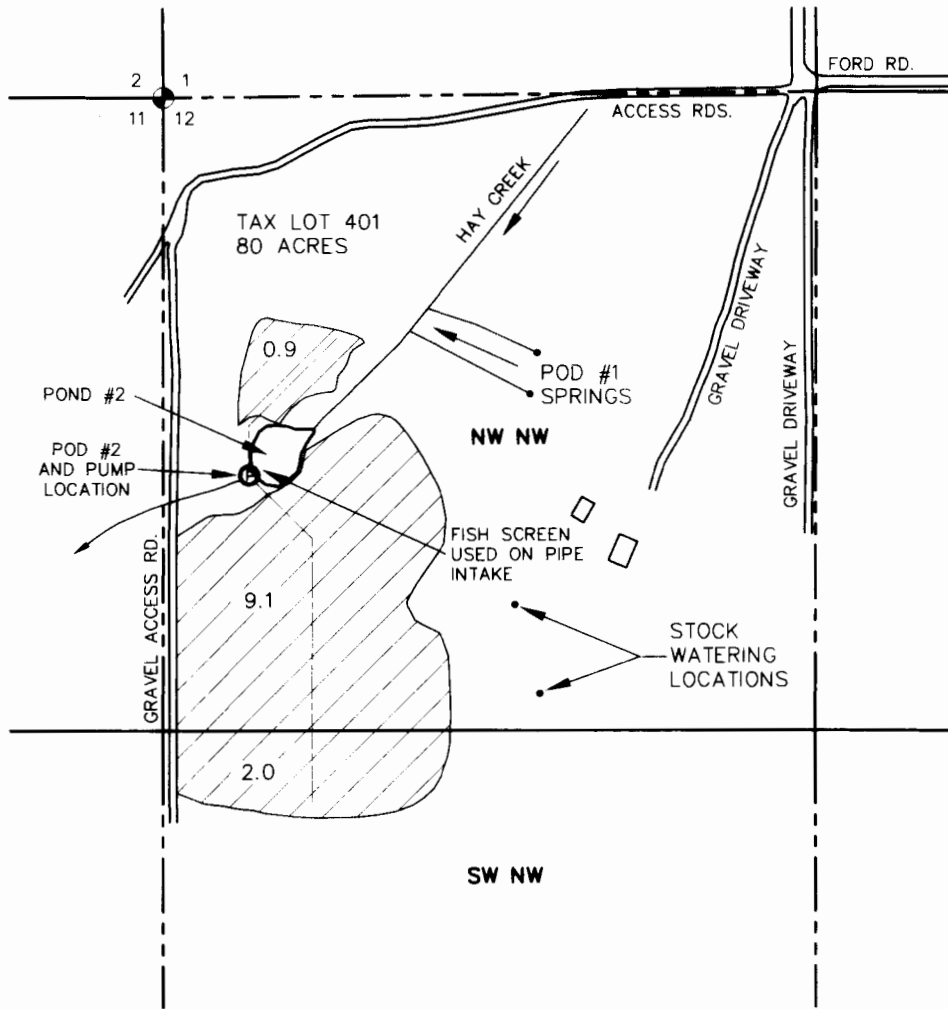

LEGEND:

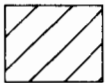

IRRIGATION AREAS



POINT OF DIVERSION #2 IS LOCATED
 790' SOUTH & 180' EAST OF NW
 CORNER OF SECTION 12

MAIN IRRIGATION LINE (ABOVE-
 GROUND HAND PLACED)

PROPERTY LINE (APPROX.)

MAP BASE: 2009 DIGITALGLOBE AERIAL, 2S 5 12
 TAX MAP & KLEIN WATER RIGHT APPLICATION MAP.

INSPECTED ON FEBRUARY 6, 2010
 BY WILLIAM KNESS

THE PURPOSE OF THIS MAP IS TO IDENTIFY THE
 LOCATION OF A WATER RIGHT ONLY. IT IS NOT
 INTENDED TO PROVIDE DIMENSIONS OR LOCATIONS
 OF PROPERTY OWNERSHIP LINES.

RECEIVED

APR 07 2010

WATER RESOURCES DEPT
 SALEM, OREGON



EXPIRES 06/30/2011

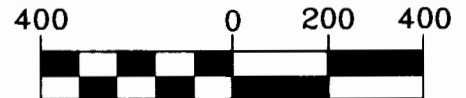

1 inch = 400 ft.



Project: 309-2-071
 File: 3092071 COBU Map.dwg
 By: WPK
 Checked by: EAU
 Date: 01-06-2010
 Rev: 03-05-2010