

RECEIVED BY OWRD

DEC 09 2015

SALEM, OR

Claim of Beneficial Use Map
Water Right in the Name of City of Rogue River
 T-10024 (Permit G-3387, Application G-3600)
 Jackson County, Oregon
 Township 36 South, Range 4 West (W.M.)

1 of 2

963

5963

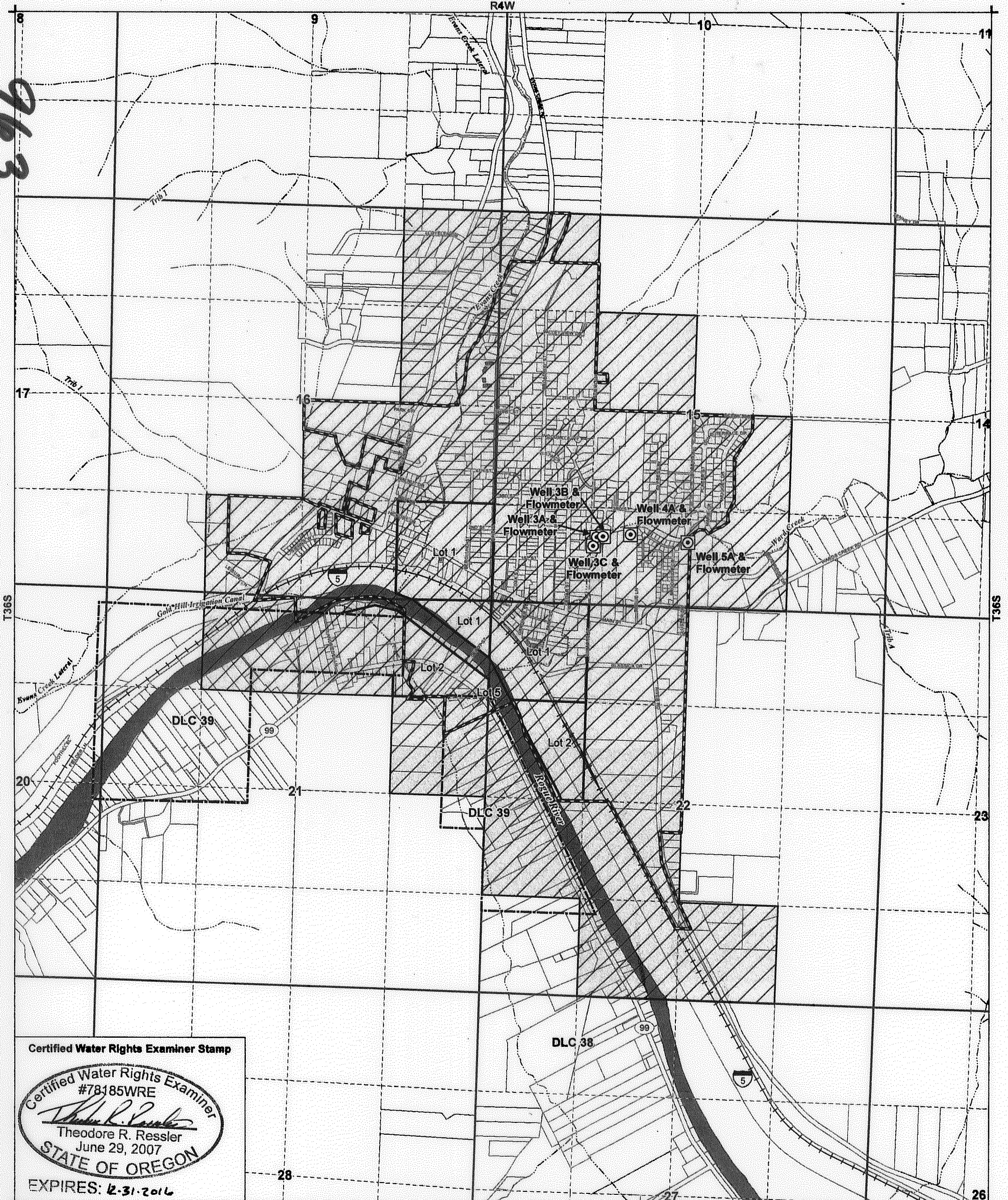

Certified Water Rights Examiner Stamp

Certified Water Rights Examiner
 #78185WRE
Theodore R. Ressler
 Theodore R. Ressler
 June 29, 2007
 STATE OF OREGON

EXPIRES: 12-31-2016

- LEGEND**
- Place of Use (POU)
 - Point of Appropriation (POA)
 - Rogue River City Limits
 - Donation Land Claim (DLC)
 - Government Lot
 - Tax Lots
 - Railroad
 - Watercourses
 - Waterbodies

- POA LOCATION DESCRIPTIONS**
- Well 3A**
 Located 920 feet North and 1,245 feet West from the S1/4 corner of Section 15, Township 36 South, Range 4 West (W.M.)
- Well 3B**
 Located 915 feet North and 1,175 feet West from the S1/4 corner of Section 15, Township 36 South, Range 4 West (W.M.)
- Well 3C**
 Located 790 feet North and 1,272 feet West from the S1/4 corner of Section 15, Township 36 South, Range 4 West (W.M.)
- Well 4A**
 Located 980 feet North and 838 feet West from the S1/4 corner of Section 15, Township 36 South, Range 4 West (W.M.)
- Well 5A**
 Located 890 feet North and 27 feet West from the S1/4 corner of Section 15, Township 36 South, Range 4 West (W.M.)

DISCLAIMER

This map was prepared for the purpose of identifying the location of a water right only and it is not intended to provide legal dimensions or location of property ownership lines.

MAP NOTES

Date: November 5, 2015
 Data Sources: OWRD, Jackson Co. GIS, US BLM
 Prepared By: GSI Water Solutions, Inc.

0 660 1,320
 1 inch = 1,320 feet

Claim of Beneficial Use Map
Water Right in the Name of City of Rogue River
 T-10024 (Permit G-1471, Application G-1591)
 Jackson County, Oregon
 Township 36 South, Range 4 West (W.M.)

963
2 of 2

963

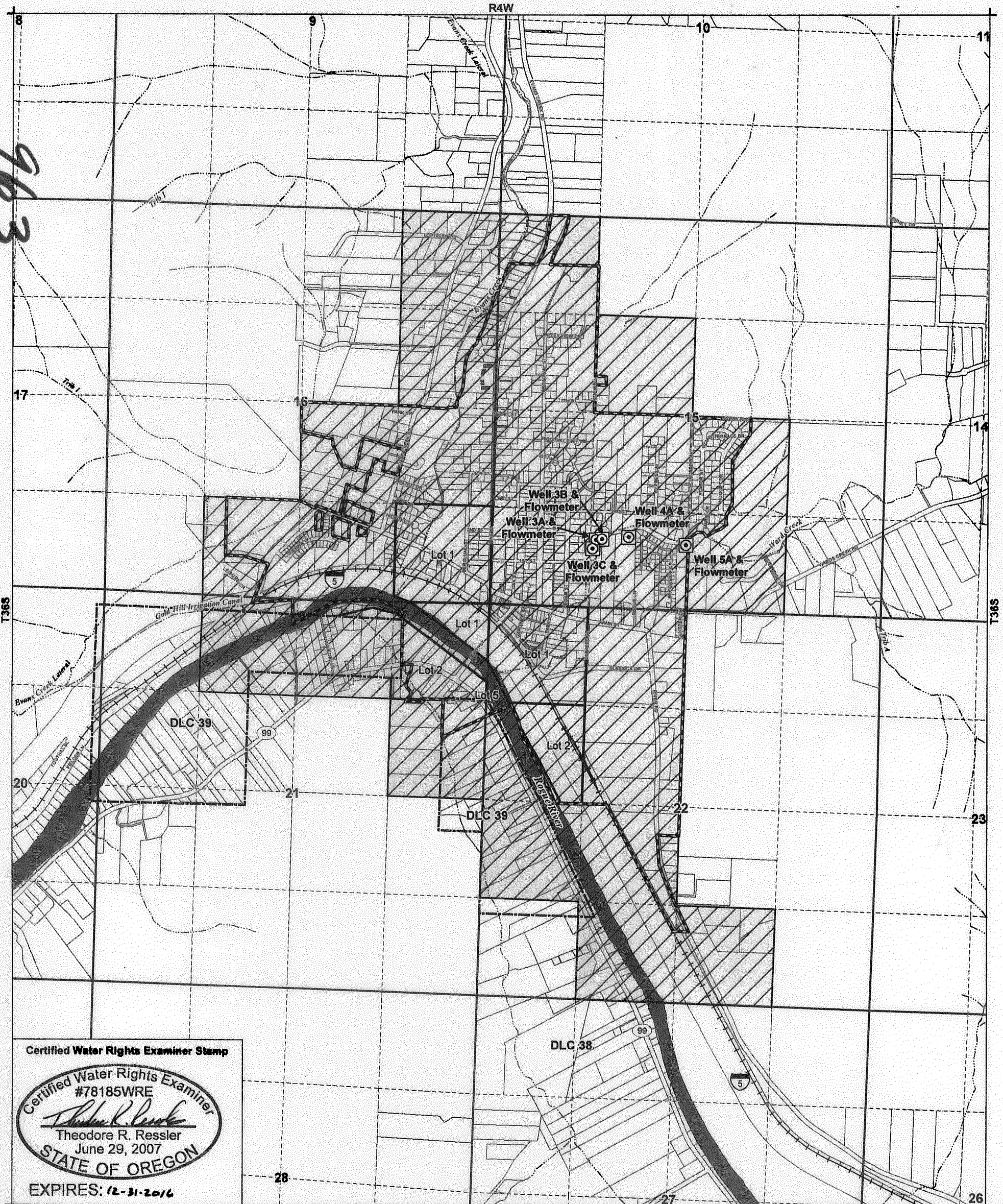

Certified Water Rights Examiner Stamp

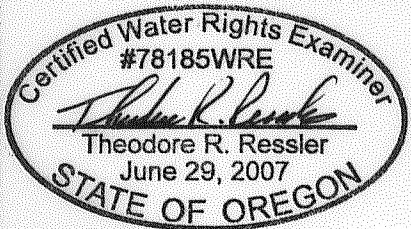

EXPIRES: 12-31-2016

LEGEND

- Place of Use (POU)
- Point of Appropriation (POA)
- Rogue River City Limits
- Donation Land Claim (DLC)
- Government Lot
- Tax Lots
- Railroad
- Watercourses
- Waterbodies

POA LOCATION DESCRIPTIONS

- Well 3A**
Located 920 feet North and 1,245 feet West from the S1/4 corner of Section 15, Township 36 South, Range 4 West (W.M.)
- Well 3B**
Located 915 feet North and 1,175 feet West from the S1/4 corner of Section 15, Township 36 South, Range 4 West (W.M.)
- Well 3C**
Located 790 feet North and 1,272 feet West from the S1/4 corner of Section 15, Township 36 South, Range 4 West (W.M.)
- Well 4A**
Located 980 feet North and 838 feet West from the S1/4 corner of Section 15, Township 36 South, Range 4 West (W.M.)
- Well 5A**
Located 890 feet North and 27 feet West from the S1/4 corner of Section 15, Township 36 South, Range 4 West (W.M.)

DISCLAIMER

This map was prepared for the purpose of identifying the location of a water right only and it is not intended to provide legal dimensions or location of property ownership lines.

MAP NOTES

Date: November 4, 2015
 Data Sources: OWRD, Jackson Co. GIS, US BLM
 Prepared By: GSI Water Solutions, Inc.

