

RECEIVED BY OWRD

DEC 09 2015

SALEM, OR

**Claim of Beneficial Use Map**  
**Water Right in the Name of City of Rogue River**  
 T-10024 (Permit G-3387, Application G-3600)  
 Jackson County, Oregon  
 Township 36 South, Range 4 West (W.M.)

1 of 2

963

5963

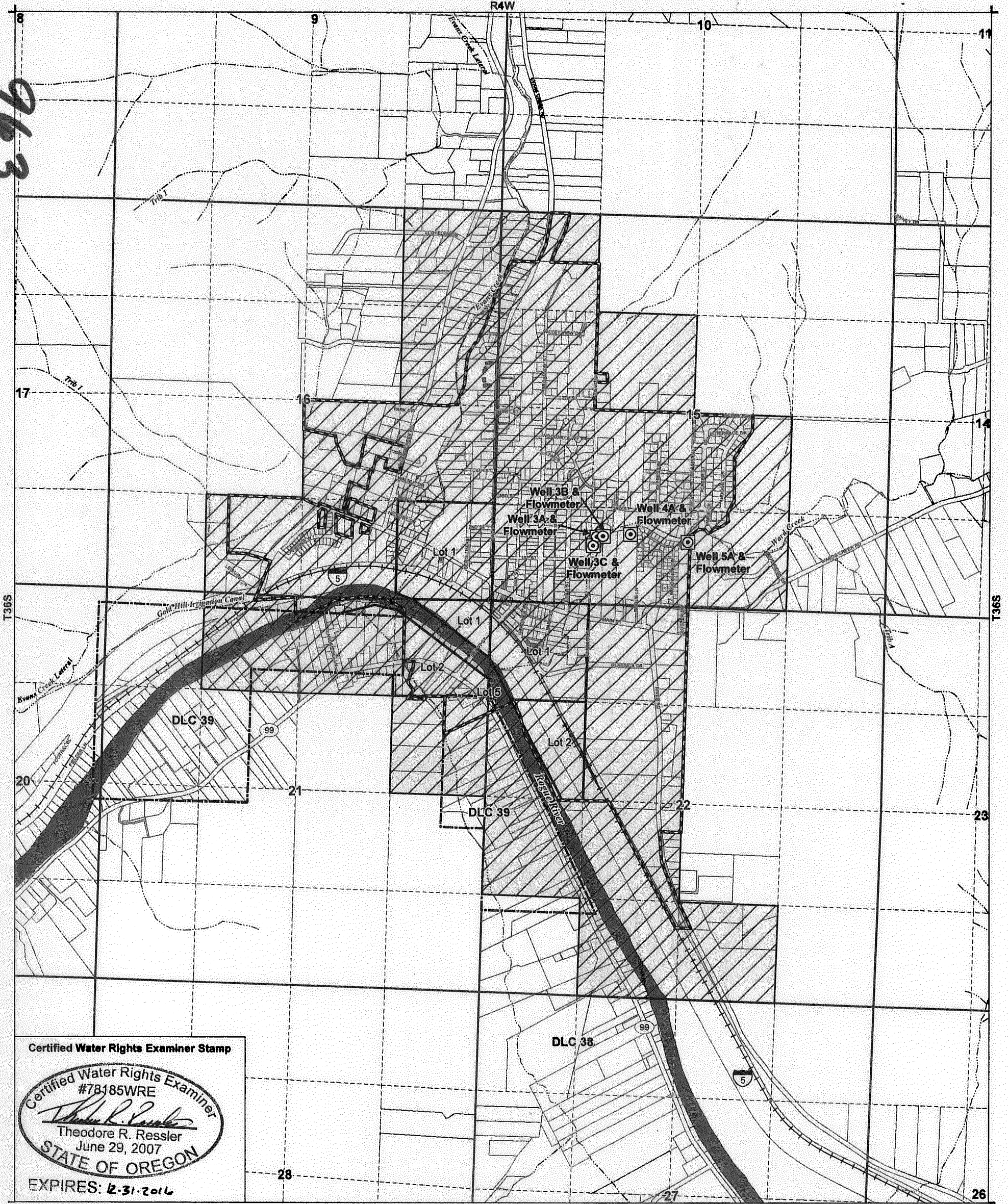

**Certified Water Rights Examiner Stamp**

Certified Water Rights Examiner  
 #78185WRE  
*Theodore R. Ressler*  
 Theodore R. Ressler  
 June 29, 2007  
 STATE OF OREGON

EXPIRES: 12-31-2016

- LEGEND**
- Place of Use (POU)
  - Point of Appropriation (POA)
  - Rogue River City Limits
  - Donation Land Claim (DLC)
  - Government Lot
  - Tax Lots
  - Railroad
  - Watercourses
  - Waterbodies

**POA LOCATION DESCRIPTIONS**

**Well 3A**  
 Located 920 feet North and 1,245 feet West from the S1/4 corner of Section 15, Township 36 South, Range 4 West (W.M.)

**Well 3B**  
 Located 915 feet North and 1,175 feet West from the S1/4 corner of Section 15, Township 36 South, Range 4 West (W.M.)

**Well 3C**  
 Located 790 feet North and 1,272 feet West from the S1/4 corner of Section 15, Township 36 South, Range 4 West (W.M.)

**Well 4A**  
 Located 980 feet North and 838 feet West from the S1/4 corner of Section 15, Township 36 South, Range 4 West (W.M.)

**Well 5A**  
 Located 890 feet North and 27 feet West from the S1/4 corner of Section 15, Township 36 South, Range 4 West (W.M.)

**DISCLAIMER**

This map was prepared for the purpose of identifying the location of a water right only and it is not intended to provide legal dimensions or location of property ownership lines.

**MAP NOTES**

Date: November 5, 2015  
 Data Sources: OWRD, Jackson Co. GIS, US BLM  
 Prepared By: GSI Water Solutions, Inc.

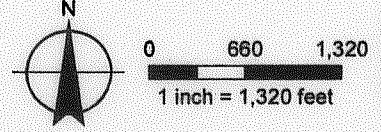

**Claim of Beneficial Use Map**  
**Water Right in the Name of City of Rogue River**  
 T-10024 (Permit G-1471, Application G-1591)  
 Jackson County, Oregon  
 Township 36 South, Range 4 West (W.M.)

963  
2 of 2

963

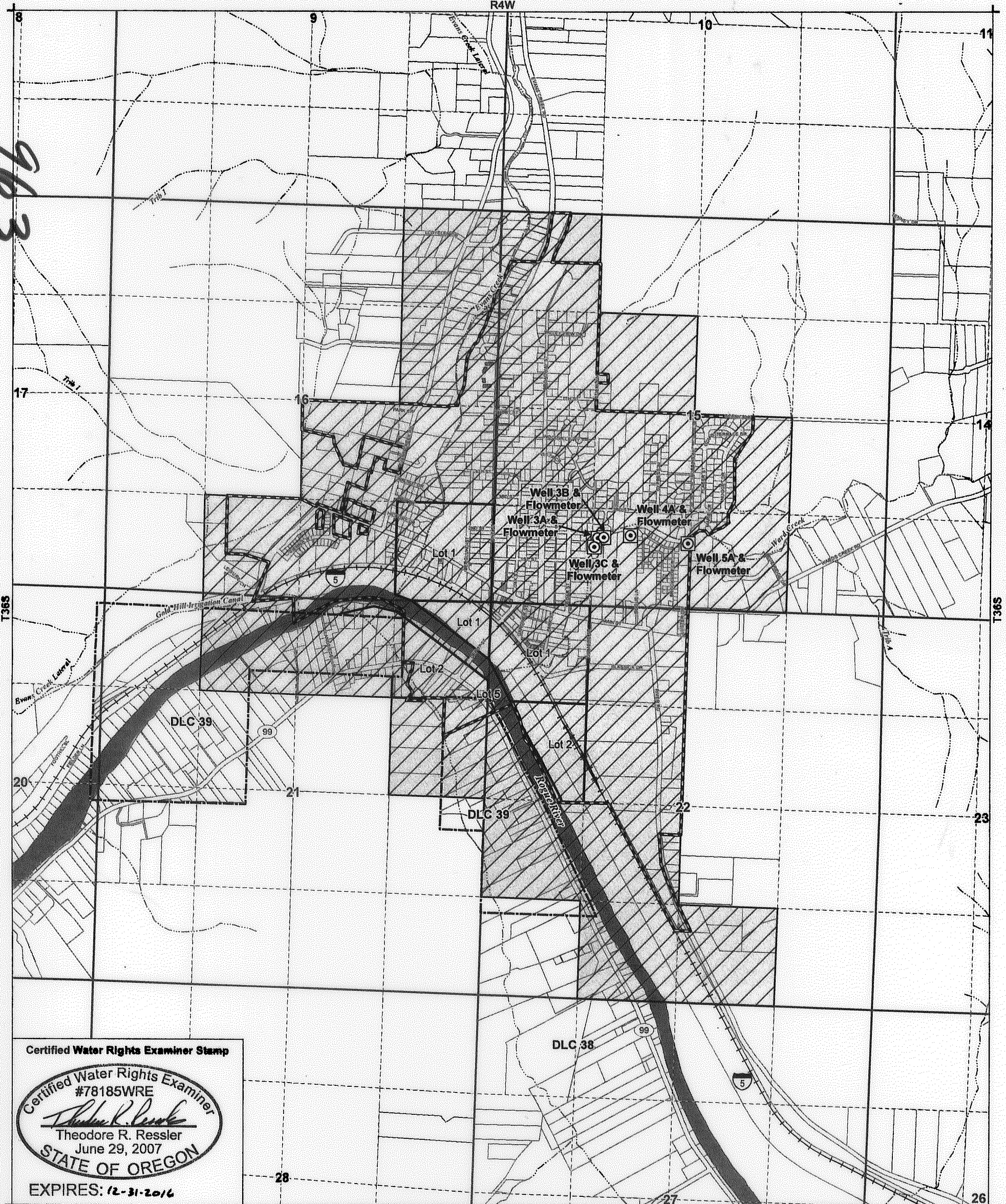

**Certified Water Rights Examiner Stamp**

- LEGEND**
- Place of Use (POU)
  - Point of Appropriation (POA)
  - Rogue River City Limits
  - Donation Land Claim (DLC)
  - Government Lot
  - Tax Lots
  - Railroad
  - Watercourses
  - Waterbodies

- POA LOCATION DESCRIPTIONS**
- Well 3A**  
 Located 920 feet North and 1,245 feet West from the S1/4 corner of Section 15, Township 36 South, Range 4 West (W.M.)
- Well 3B**  
 Located 915 feet North and 1,175 feet West from the S1/4 corner of Section 15, Township 36 South, Range 4 West (W.M.)
- Well 3C**  
 Located 790 feet North and 1,272 feet West from the S1/4 corner of Section 15, Township 36 South, Range 4 West (W.M.)
- Well 4A**  
 Located 980 feet North and 838 feet West from the S1/4 corner of Section 15, Township 36 South, Range 4 West (W.M.)
- Well 5A**  
 Located 890 feet North and 27 feet West from the S1/4 corner of Section 15, Township 36 South, Range 4 West (W.M.)

**DISCLAIMER**

This map was prepared for the purpose of identifying the location of a water right only and it is not intended to provide legal dimensions or location of property ownership lines.

**MAP NOTES**

Date: November 4, 2015  
 Data Sources: OWRD, Jackson Co. GIS, US BLM  
 Prepared By: GSI Water Solutions, Inc.