

TRANSFER APPLICATION MAP ASSOCIATED WITH CERT  
140, 171, 2380, AND A PORTION OF CERT 141  
IN THE NAME OF SKYE KREBS  
T3N, R22E, W.M. IN GILLIAM COUNTY  
SHEET 1 OF 2

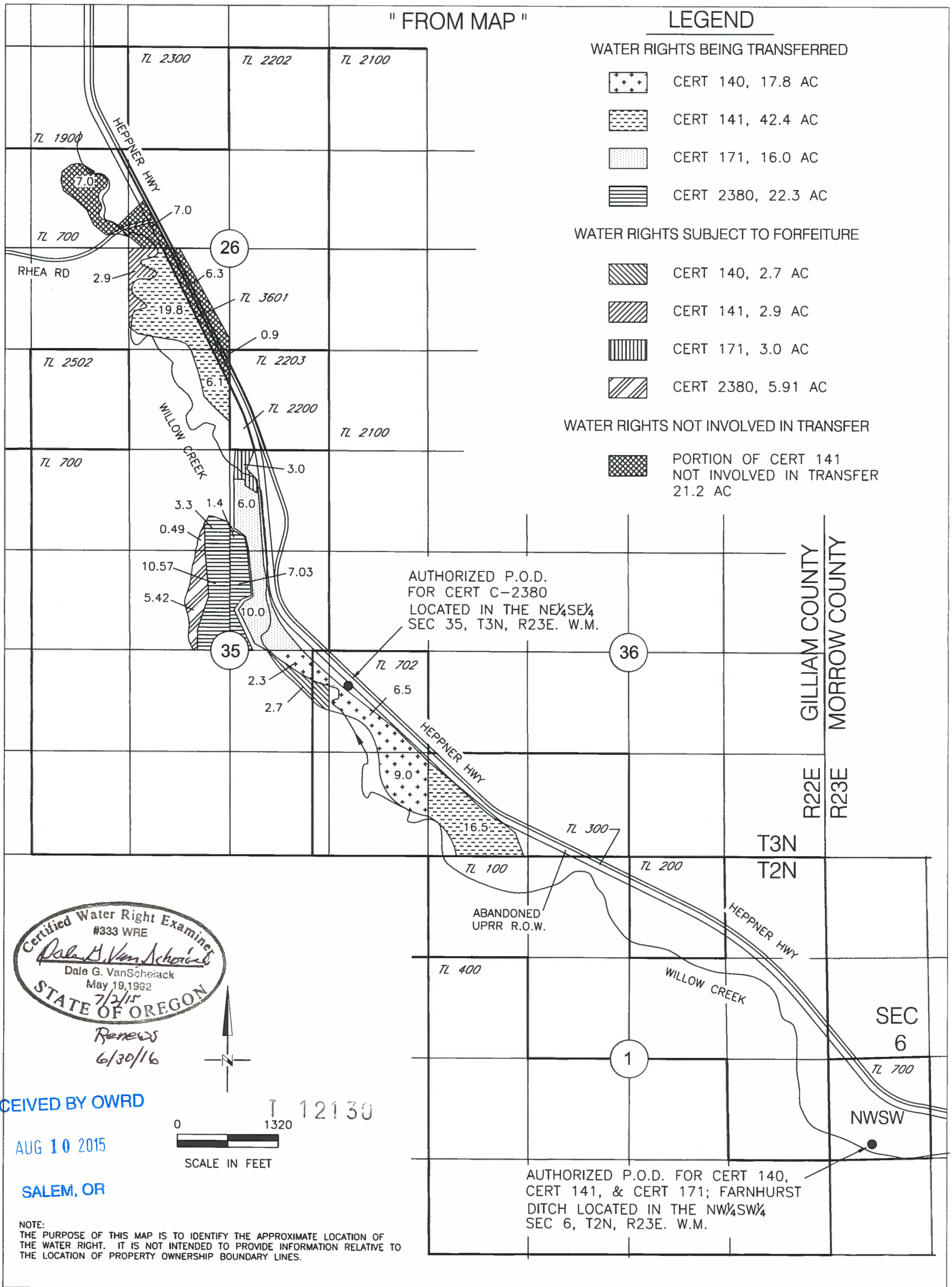

TRANSFER APPLICATION MAP ASSOCIATED WITH CERT  
 140, 171, 2380, AND A PORTION OF CERT 141  
 IN THE NAME OF SKYE KREBS  
 T3N, R22E, W.M. IN GILLIAM COUNTY  
 SHEET 2 OF 2

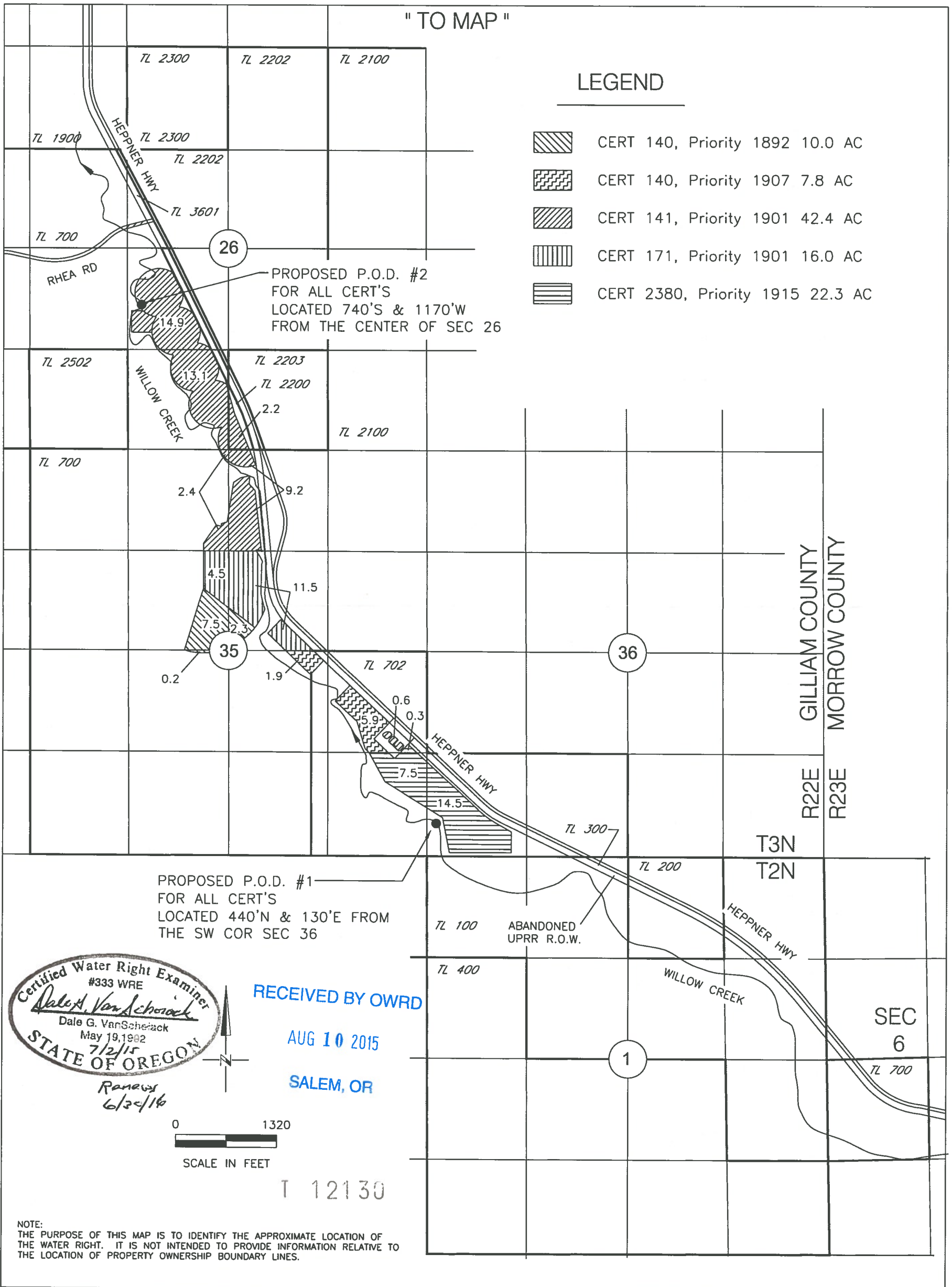

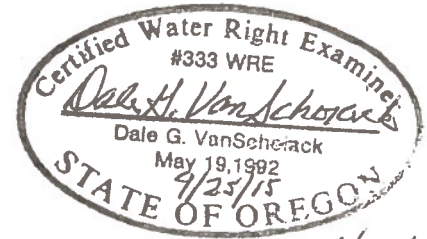

AMENDED TRANSFER T-12130 APPLICATION MAP ASSOCIATED WITH  
 CERT 112, 140, 171, 2380, AND A PORTION OF CERT 141  
 IN THE NAME OF SKYE KREBS  
 T3N, R22E, W.M. IN GILLIAM COUNTY (SHEET 1 OF 4)

" FROM MAP for CERT 112, 140, & 141 "





LEGEND

WATER RIGHTS BEING TRANSFERRED

-  CERT 112, 3.0 AC
-  CERT 140, 17.8 AC
-  CERT 141, 42.4 AC

WATER RIGHTS SUBJECT TO FORFEITURE

-  CERT 140, 2.7 AC
-  CERT 141, 2.9 AC

WATER RIGHTS NOT INVOLVED IN TRANSFER

-  PORTION OF CERT 141 NOT INVOLVED IN TRANSFER 21.2 AC

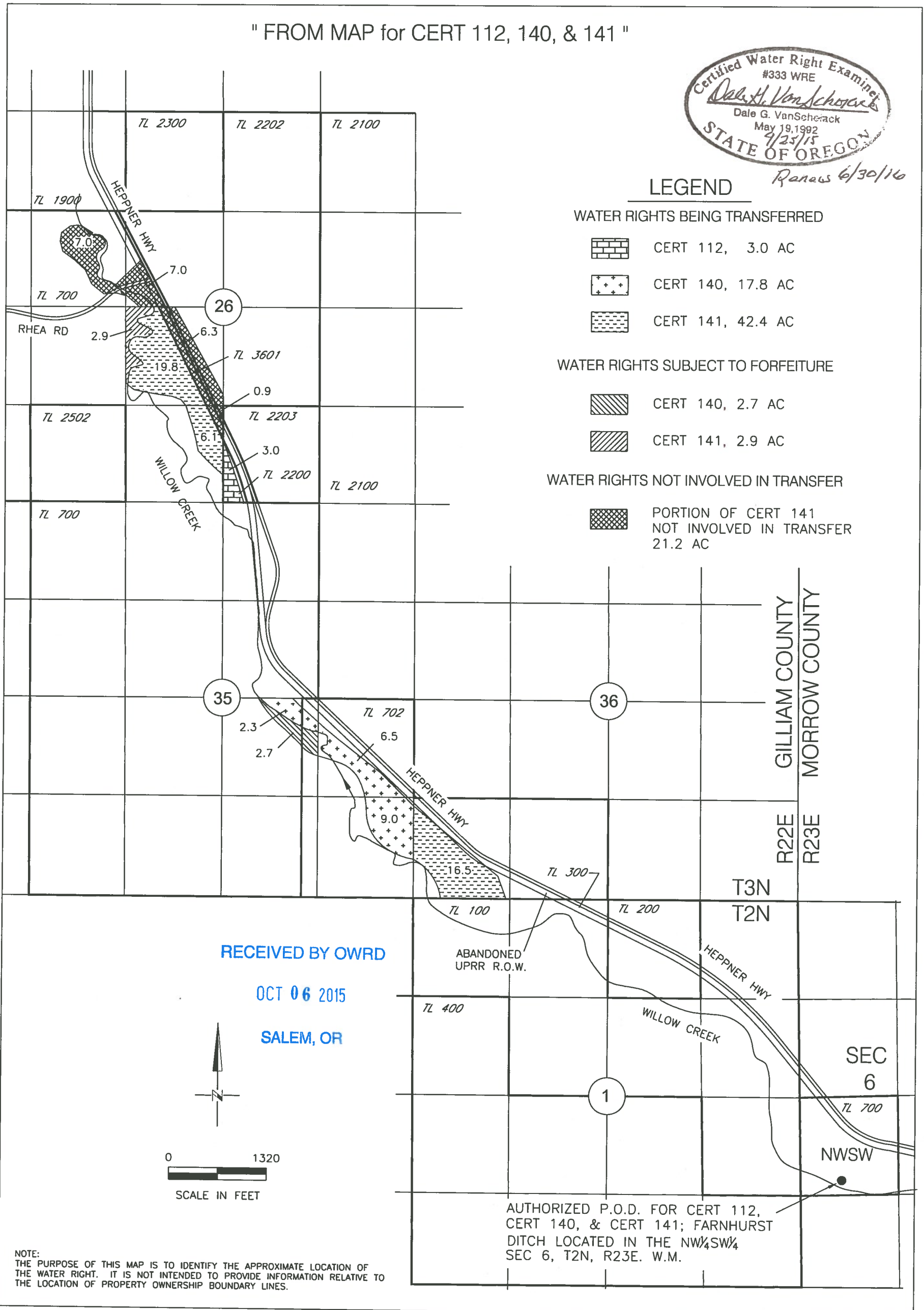

RECEIVED BY OWRD

OCT 06 2015

SALEM, OR

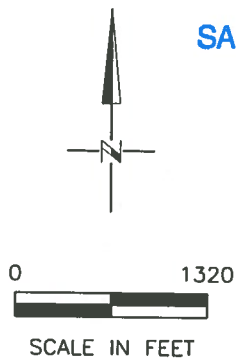

NOTE:  
 THE PURPOSE OF THIS MAP IS TO IDENTIFY THE APPROXIMATE LOCATION OF THE WATER RIGHT. IT IS NOT INTENDED TO PROVIDE INFORMATION RELATIVE TO THE LOCATION OF PROPERTY OWNERSHIP BOUNDARY LINES.



AUTHORIZED P.O.D. FOR CERT 112, CERT 140, & CERT 141; FARNHURST DITCH LOCATED IN THE NW $\frac{1}{4}$ SW $\frac{1}{4}$  SEC 6, T2N, R23E. W.M.

AMENDED TRANSFER T-12130 APPLICATION MAP ASSOCIATED WITH  
 CERT 112, 140, 171, 2380, AND A PORTION OF CERT 141  
 IN THE NAME OF SKYE KREBS  
 T3N, R22E, W.M. IN GILLIAM COUNTY (SHEET 2 OF 4)



" FROM MAP for CERT 171 & 2380"

LEGEND

WATER RIGHTS BEING TRANSFERRED

-  CERT 171, 16.0 AC
-  CERT 2380, 22.3 AC

WATER RIGHTS SUBJECT TO FORFEITURE

-  CERT 171, 3.0 AC
-  CERT 2380, 5.91 AC

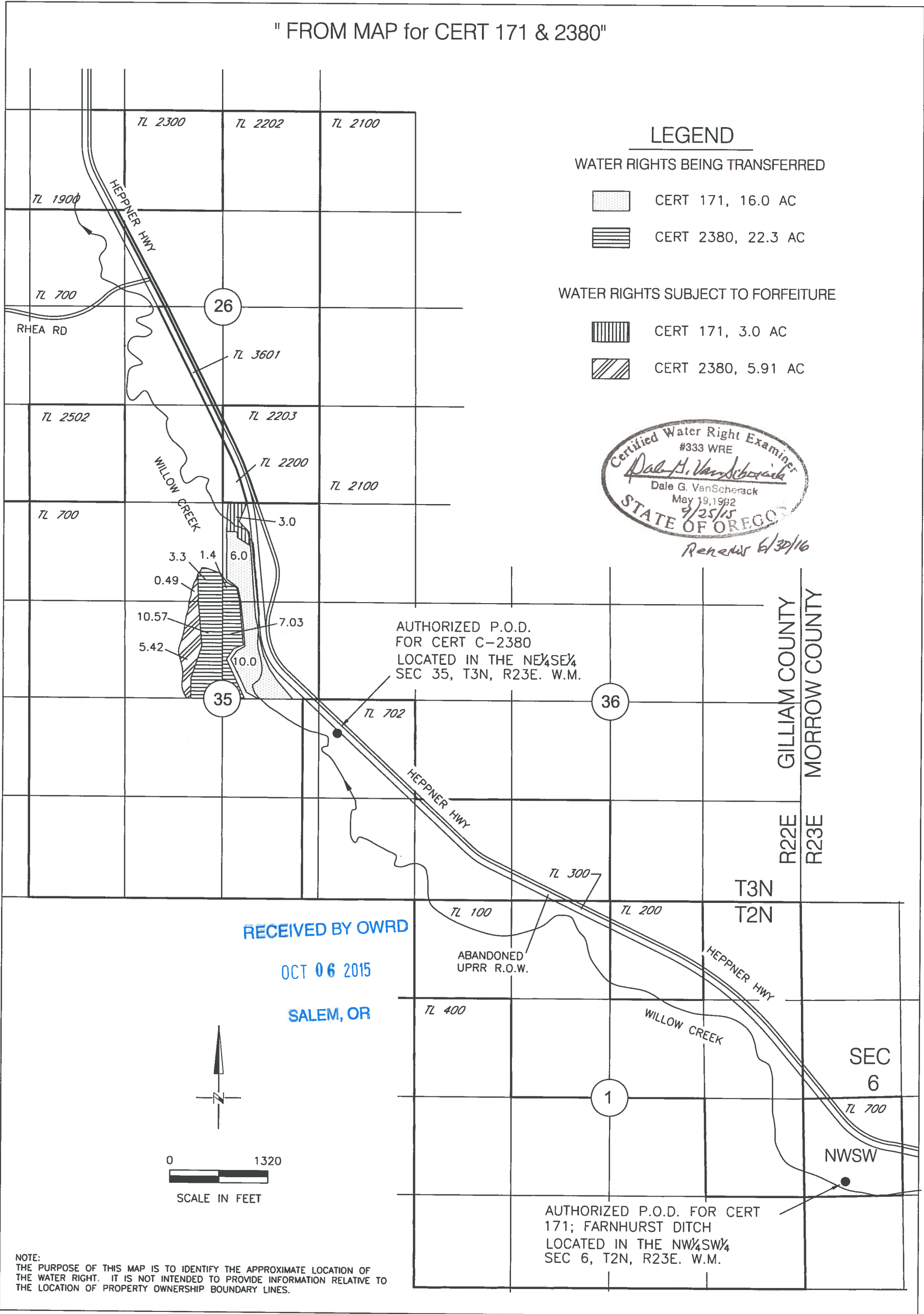
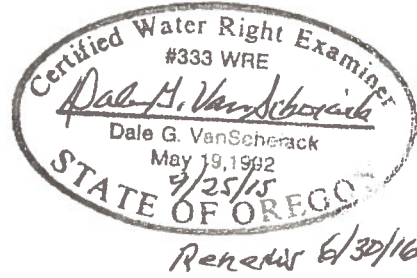

AUTHORIZED P.O.D. FOR CERT C-2380  
 LOCATED IN THE NE<sup>1</sup>/<sub>4</sub>SE<sup>1</sup>/<sub>4</sub>  
 SEC 35, T3N, R23E. W.M.

AUTHORIZED P.O.D. FOR CERT  
 171; FARNHURST DITCH  
 LOCATED IN THE NW<sup>1</sup>/<sub>4</sub>SW<sup>1</sup>/<sub>4</sub>  
 SEC 6, T2N, R23E. W.M.

RECEIVED BY OWRD  
 OCT 06 2015  
 SALEM, OR

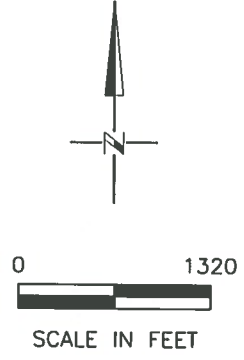

NOTE:  
 THE PURPOSE OF THIS MAP IS TO IDENTIFY THE APPROXIMATE LOCATION OF  
 THE WATER RIGHT. IT IS NOT INTENDED TO PROVIDE INFORMATION RELATIVE TO  
 THE LOCATION OF PROPERTY OWNERSHIP BOUNDARY LINES.

AMENDED TRANSFER T-12130 APPLICATION MAP ASSOCIATED WITH  
 CERT 112, 140, 171, 2380, AND A PORTION OF CERT 141  
 IN THE NAME OF SKYE KREBS  
 T3N, R22E, W.M. IN GILLIAM COUNTY (SHEET 3 OF 4)

" TO MAP for CERT 112, 140, & 141 "

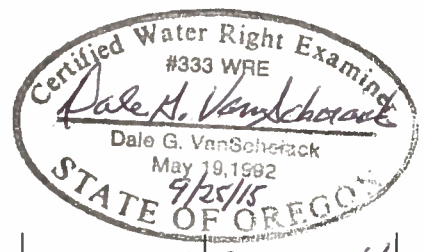
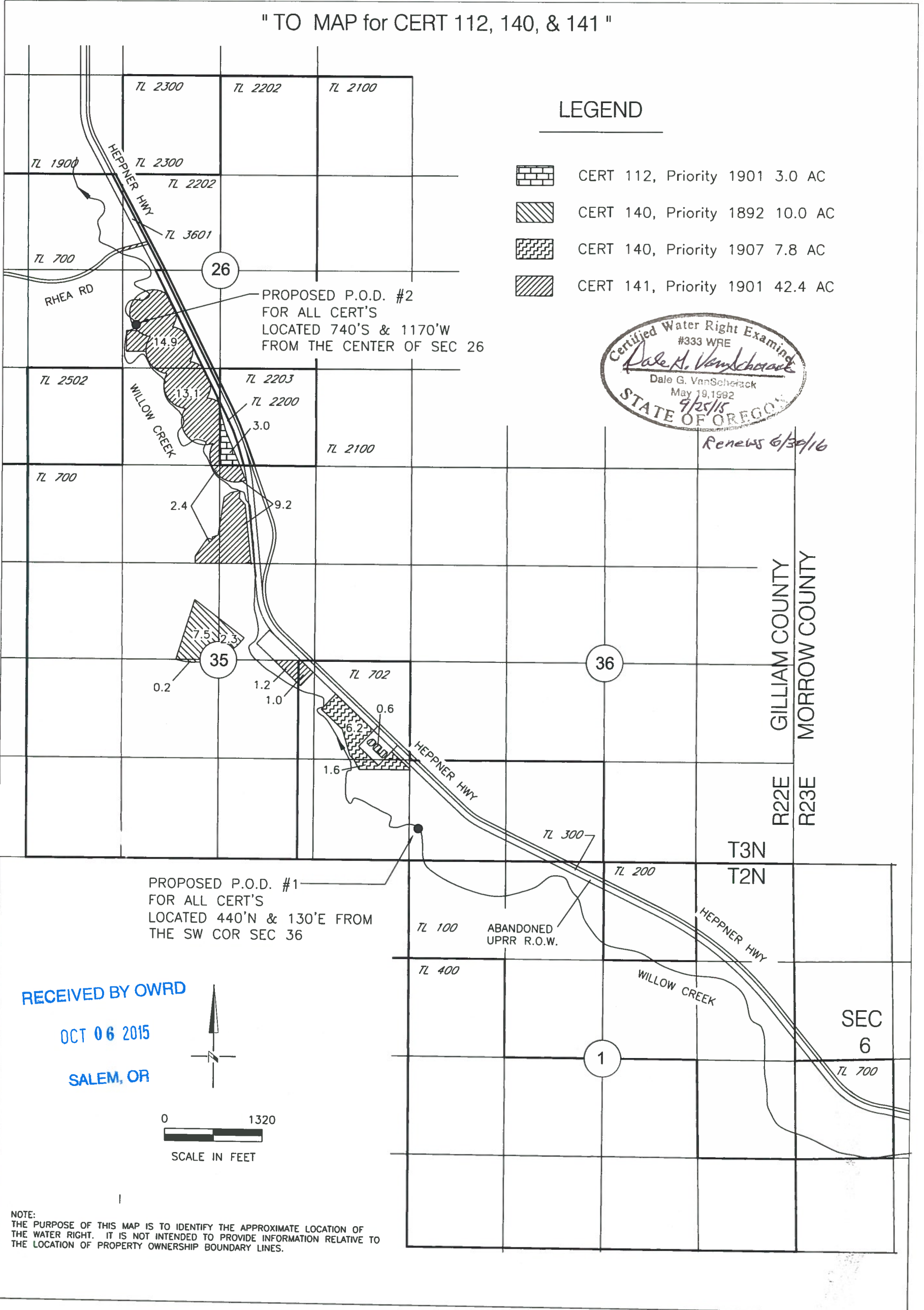



Renews 6/30/16

AMENDED TRANSFER T-12130 APPLICATION MAP ASSOCIATED WITH  
 CERT 112, 140, 171, 2380, AND A PORTION OF CERT 141  
 IN THE NAME OF SKYE KREBS  
 T3N, R22E, W.M. IN GILLIAM COUNTY (SHEET 4 OF 4)

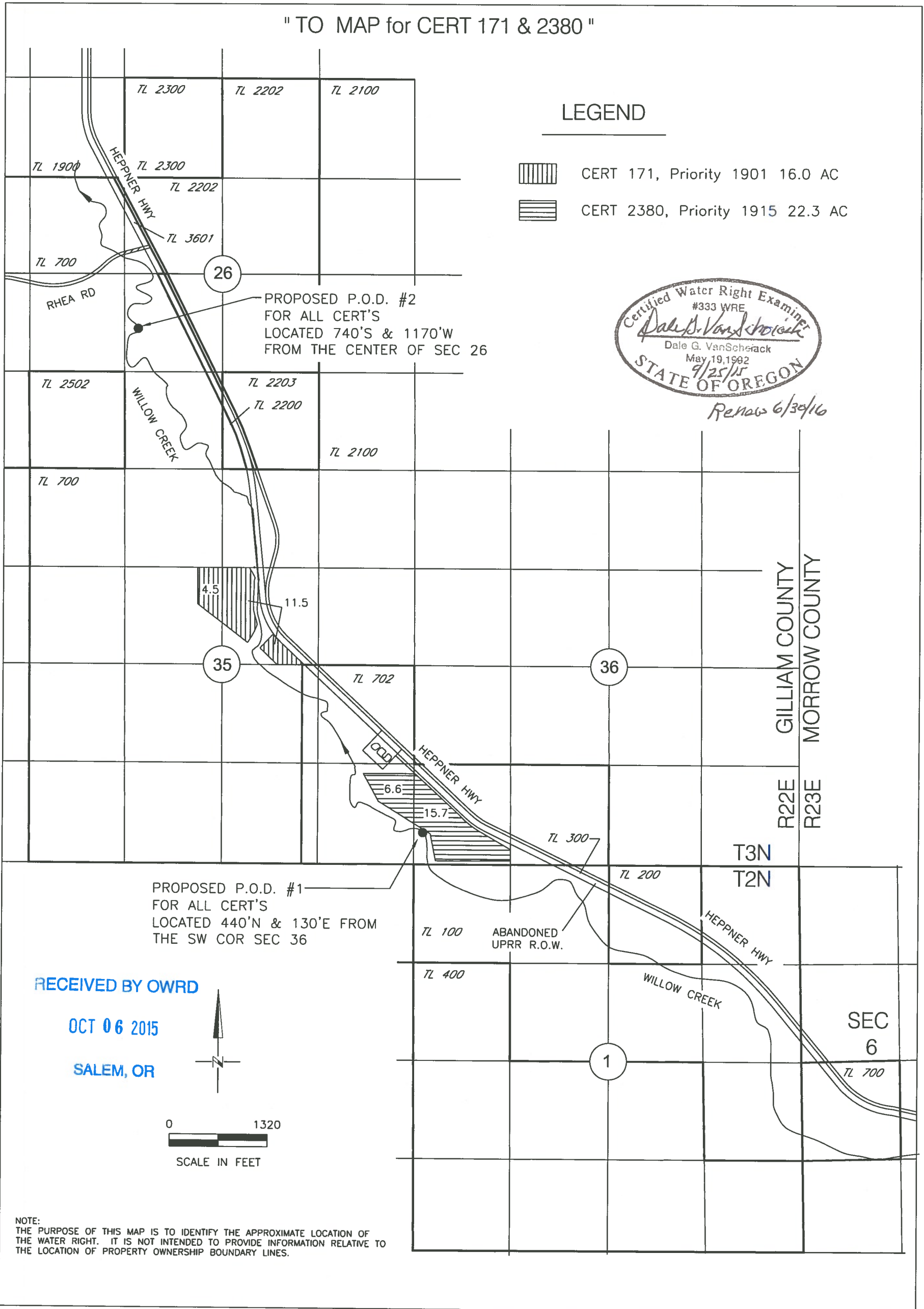
" TO MAP for CERT 171 & 2380 "



LEGEND

-  CERT 171, Priority 1901 16.0 AC
-  CERT 2380, Priority 1915 22.3 AC

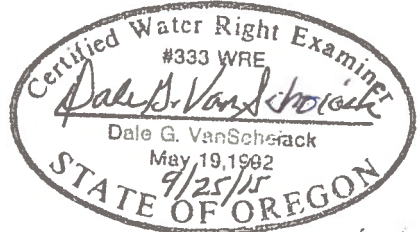

Renew 6/30/16

PROPOSED P.O.D. #1  
 FOR ALL CERT'S  
 LOCATED 440'N & 130'E FROM  
 THE SW COR SEC 36

RECEIVED BY OWRD

OCT 06 2015

SALEM, OR

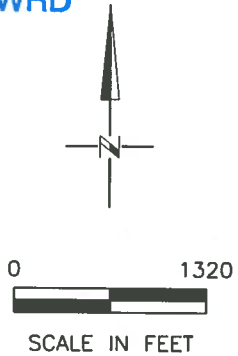

NOTE:  
 THE PURPOSE OF THIS MAP IS TO IDENTIFY THE APPROXIMATE LOCATION OF  
 THE WATER RIGHT. IT IS NOT INTENDED TO PROVIDE INFORMATION RELATIVE TO  
 THE LOCATION OF PROPERTY OWNERSHIP BOUNDARY LINES.