

T.5S & 6S, R.5W., W.M.

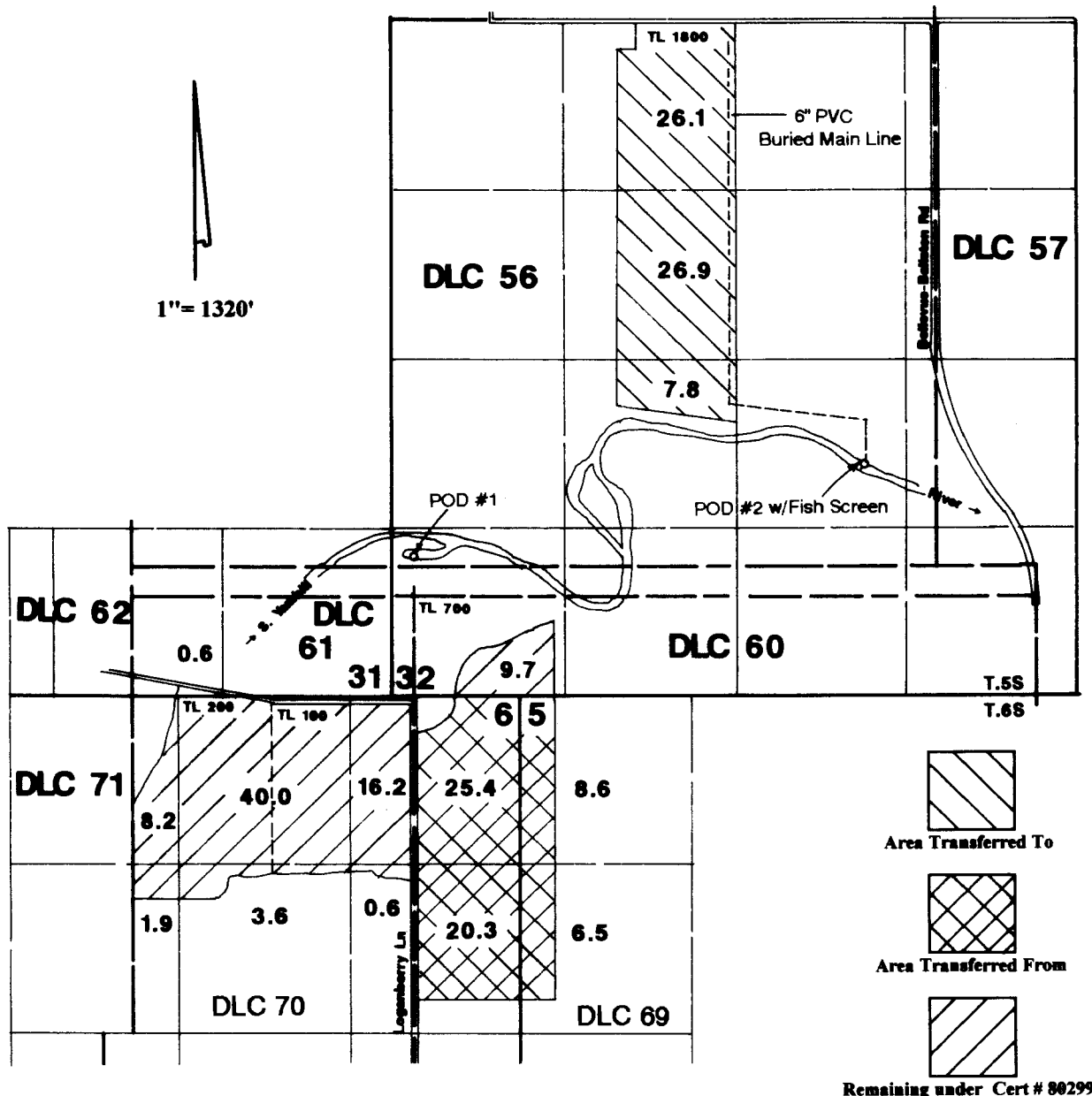

POD #1 (Lot 4 SW1/4 SW1/4) is located 200' N from the NW corner of McCune DLC 60.
 POD #2 (NW1/4 SE1/4) is located 790' N & 560' W from the SE corner of Toney DLC 56.

RECEIVED

MAR 30 2014

WATER RESOURCES DEPT
 SALEM, OREGON

Final Proof Survey

In the Name of

Daryl Fisher

Transfer #: T-9245

Surveyed on March 21, 2014 by JM Schuette

This Map was Prepared for the Purpose of Identifying the Location of a Water Right Only and is Not Intended to Provide Legal Dimensions or Location of Property Ownership Lines.

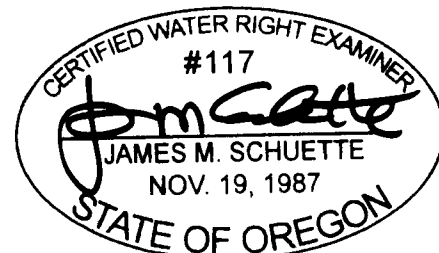

EXPIRES: 6/30/2014