

CLAIM OF BENEFICIAL USE  
 APPLICATION S-86274 PERMIT S-54309  
 SECTION 20, T 35 S, R 1 W, WM.  
 JACKSON COUNTY, OREGON  
 ASSESSOR'S MAPS No 35 1W 20 202

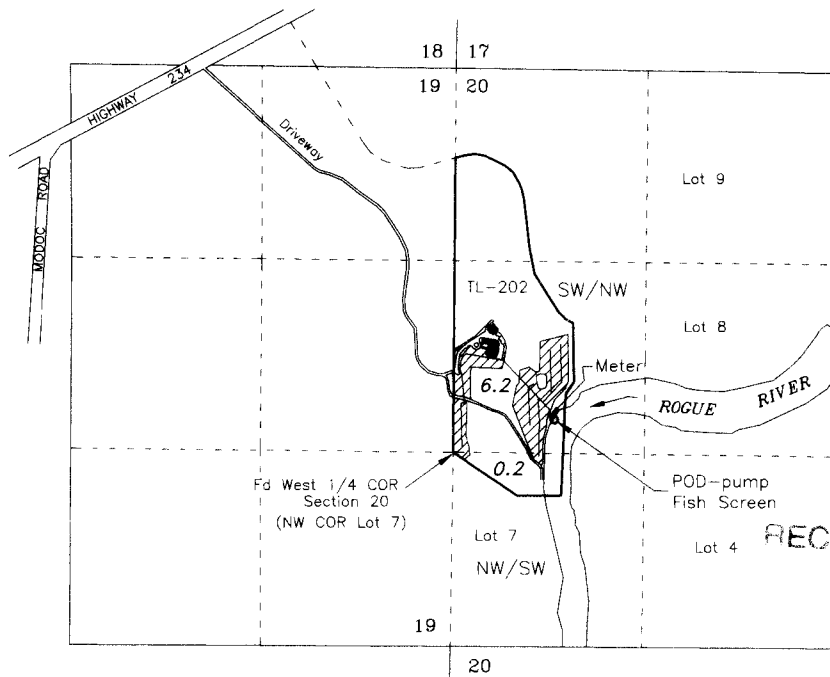



RECEIVED BY OWRD

JAN 27 2016

SALEM, OR

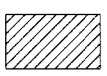
POD - SW/NW Section 20, 225 feet North & 695 feet East from the West 1/4 Corner Section 20

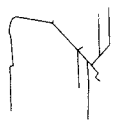
	Irrigation 6.4 Acres Source - Lost Creek Lake Reservoir under Permit R-8142
	Buildings
	Main irrigation lines (approximate location)

LEGEND

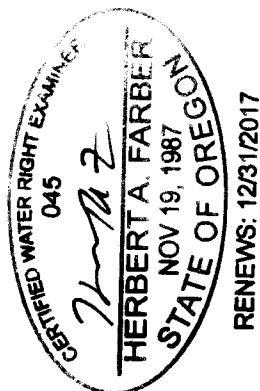

This map is not intended to provide legal dimensions or locations of property ownership lines.

SCALE: 1" = 1320'

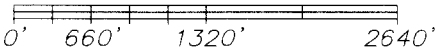

Prepared by:  
 FARBER & SONS, INC.  
 dba FARBER SURVEYING  
 (541) 664-5599  
 PO BOX 5286  
 431 OAK STREET  
 CENTRAL POINT, OREGON 97502

DATE: January 11, 2016 ned  
 JOB NO. 2438-15

Base Map: Recorded survey  
 CS-13115 over scaled Oregon  
 Map (11/25/15) & Google aerial  
 photo (7/4/14) for assumed  
 best fit

Prepared for:  
 Richard Gribble

Assigned To:  
 Richard C. Crown & Paula Jones-Crown  
 P.O. Box 250  
 Merlin, OR 97524