

T13S R28E W.M.

RECEIVED

JUN 23 2011

WATER RESOURCES DEPT
SALEM OREGON

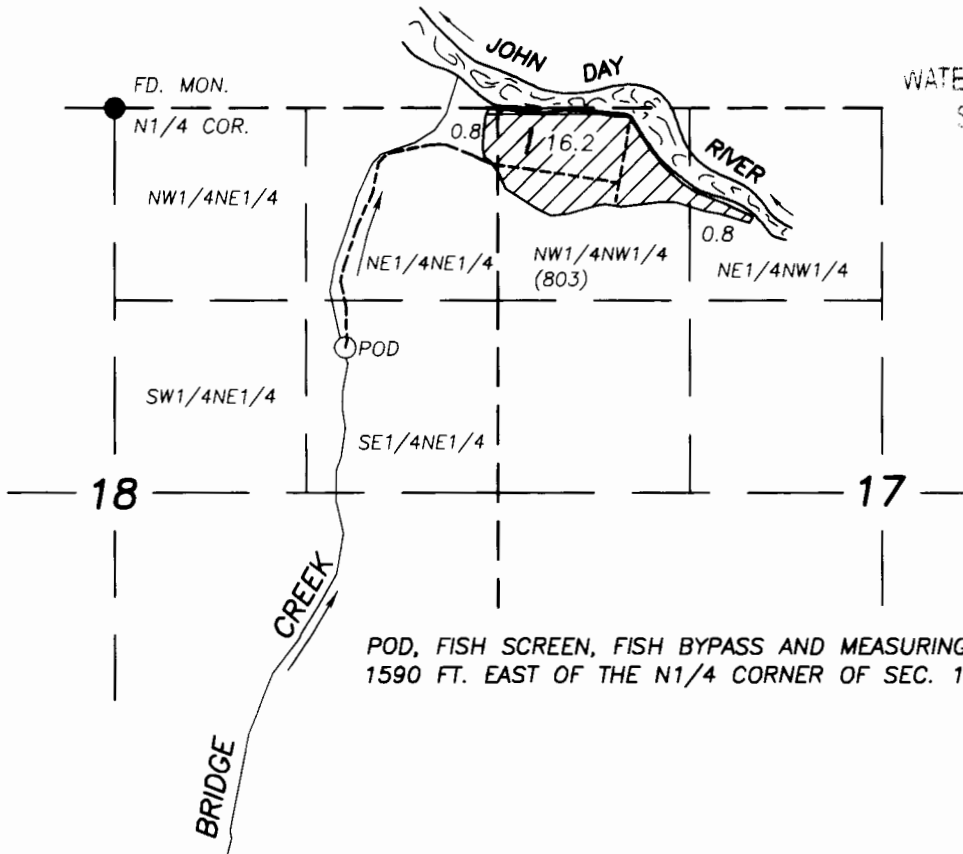

SCALE: 1" = 1320'

POD, FISH SCREEN, FISH BYPASS AND MEASURING DEVICE 1650 FT. SOUTH AND 1590 FT. EAST OF THE N1/4 CORNER OF SEC. 18, T.13S., R.28E., W.M.

**FINAL PROOF SURVEY
UNDER APPLICATION T8421
&
PERMIT SPECIAL ORDER VOL 56, PAGE 897**

IN NAME OF

**JAMES DOVENBERG
WIDOWS CREEK RANCH**

BY

**ROBERT D. BAGETT
BAGETT, GRIFFITH & BLACKMAN
217 N. CANYON BLVD.
JOHN DAY, OREGON
(541) 575-1251**

SURVEY COMPLETED SEPTEMBER 12, 2008

-  PLACE OF USE
- BURIED MAIN LINE
- () TAX LOT NO.

NOTE: THE PREPARATION OF THIS MAP WAS FOR THE PURPOSE OF IDENTIFYING THE LOCATION OF THE PROPOSED WATER RIGHT AND HAS NO INTENT TO PROVIDE DIMENSIONS OR LOCATION OF PROPERTY OWNERSHIP LINES.

