

ADDITIONAL POINT OF DIVERSION

CERTIFICATES:

16394 – PRIORITY DATE 1906
16396 – PRIORITY DATE 1872, 1897, AND 1900

FOR:

ROBERT BOOTH
6585 LITTLE APPLGATE ROAD
JACKSONVILLE, OREGON 97530

RECEIVED

DEC 28 2015

WATER RESOURCES DEPT
SALEM, OREGON

SITUATED IN:

SECTION 28, TOWNSHIP 39 SOUTH RANGE 2 WEST, W.M.
JACKSON COUNTY, OREGON

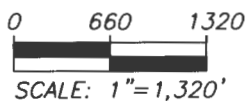
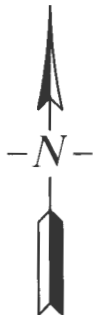
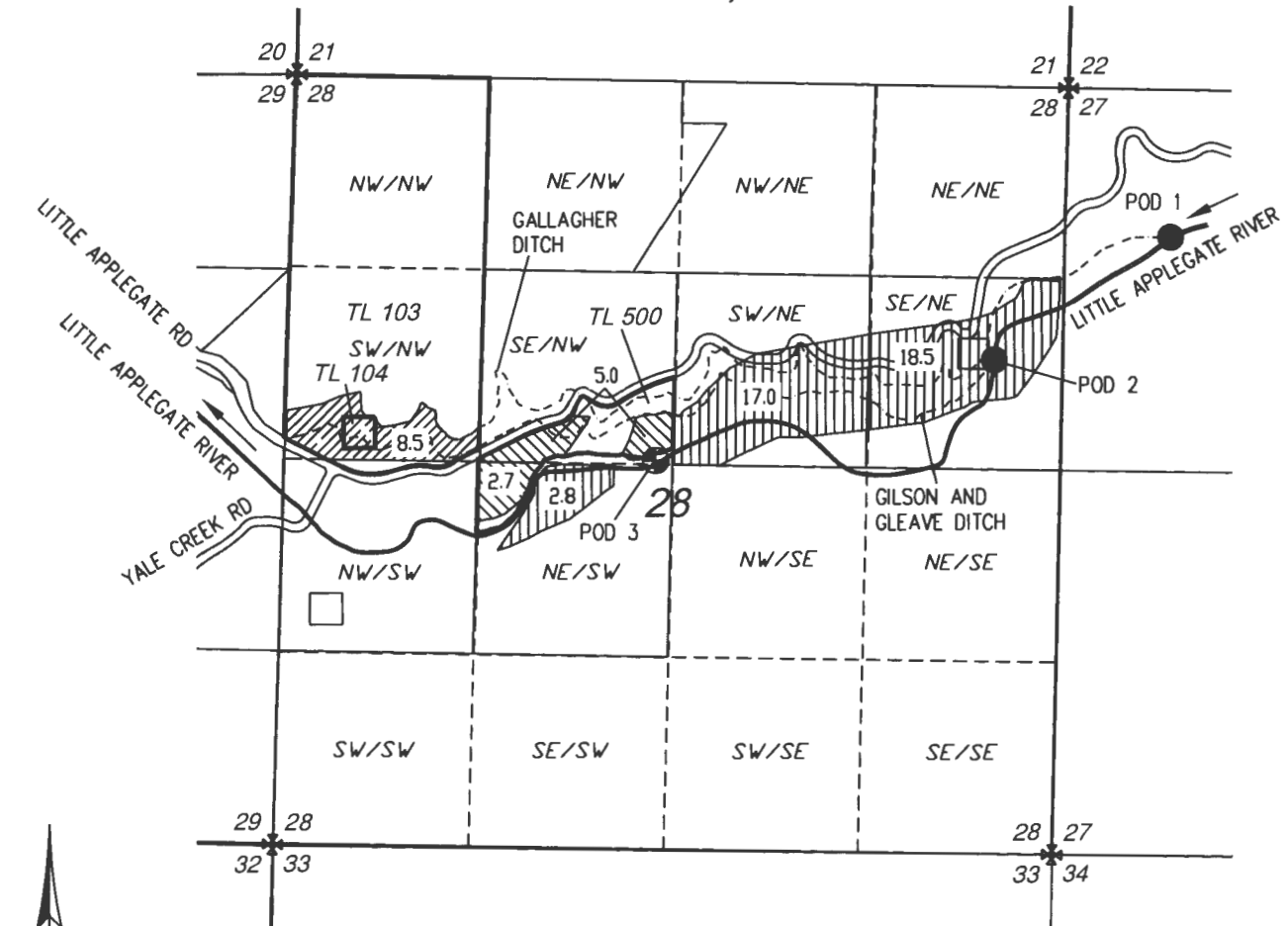

LEGEND

- **POD 1**
CERTIFICATE 16394 DOES NOT DESCRIBE THE LOCATION OF THE POINT OF DIVERSION. THE LOCATION SHOWN IS BASED ON REVIEW OF AERIAL PHOTOS.
APPROXIMATELY 1,040' SOUTH & 710' EAST FROM NE CORNER SECTION 28 (NO CHANGES)
- **POD 2**
CERTIFICATE 16396 DOES NOT DESCRIBE THE LOCATION OF THE POINT OF DIVERSION. THE LOCATION SHOWN IS BASED ON REVIEW OF AERIAL PHOTOS.
APPROXIMATELY 1,890' SOUTH & 520' WEST* FROM NE CORNER SECTION 28 (NO CHANGES)
- **POD 3 – ADDITIONAL POINT OF DIVERSION**
FOR CERT. 16394 AND 16396
2,580' SOUTH & 2,880' WEST FROM NE CORNER SECTION 28

- *AUTHORIZED PLACE OF USE – CERT. 16394
ADDITIONAL POD
- *AUTHORIZED PLACE OF USE – CERT. 16396
ADDITIONAL POD
- *AUTHORIZED PLACE OF USE – CERT. 16396
NO CHANGES
- DITCH/CANAL

*AUTHORIZED PLACE OF USE SHOWN IS BASED ON DECREE MAP.

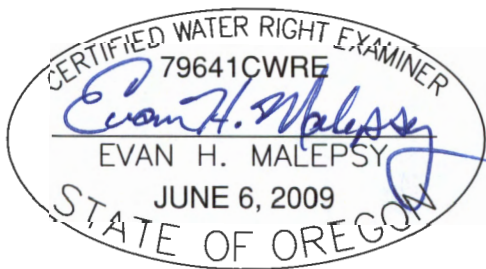

RENEWS: 12/31/2016

This map is not intended to provide legal dimensions or locations of property ownership lines.

December 23, 2015 – EHM

Property boundaries based on Jackson County GIS data downloaded January 1, 2014.

T 12225

RECEIVED BY OWDR