

Section 8, T18S, R2W, W.M. &
 Sections 1 & 2, T18S, R3W, W.M., Lane County, Oregon

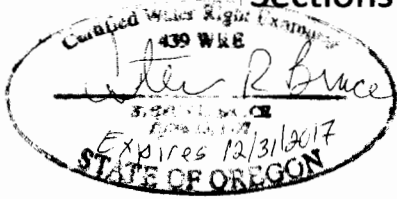

Transfer T-10968
 CLAIM OF BENEFICIAL USE MAP
 Knife River Corporation

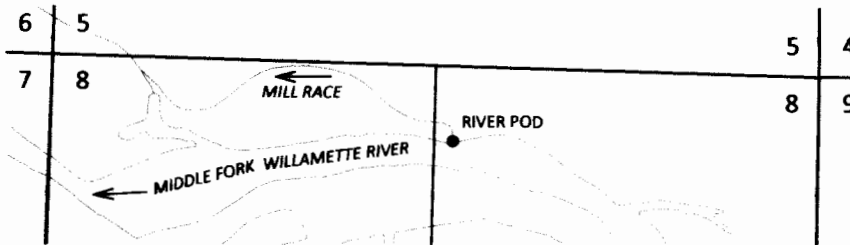
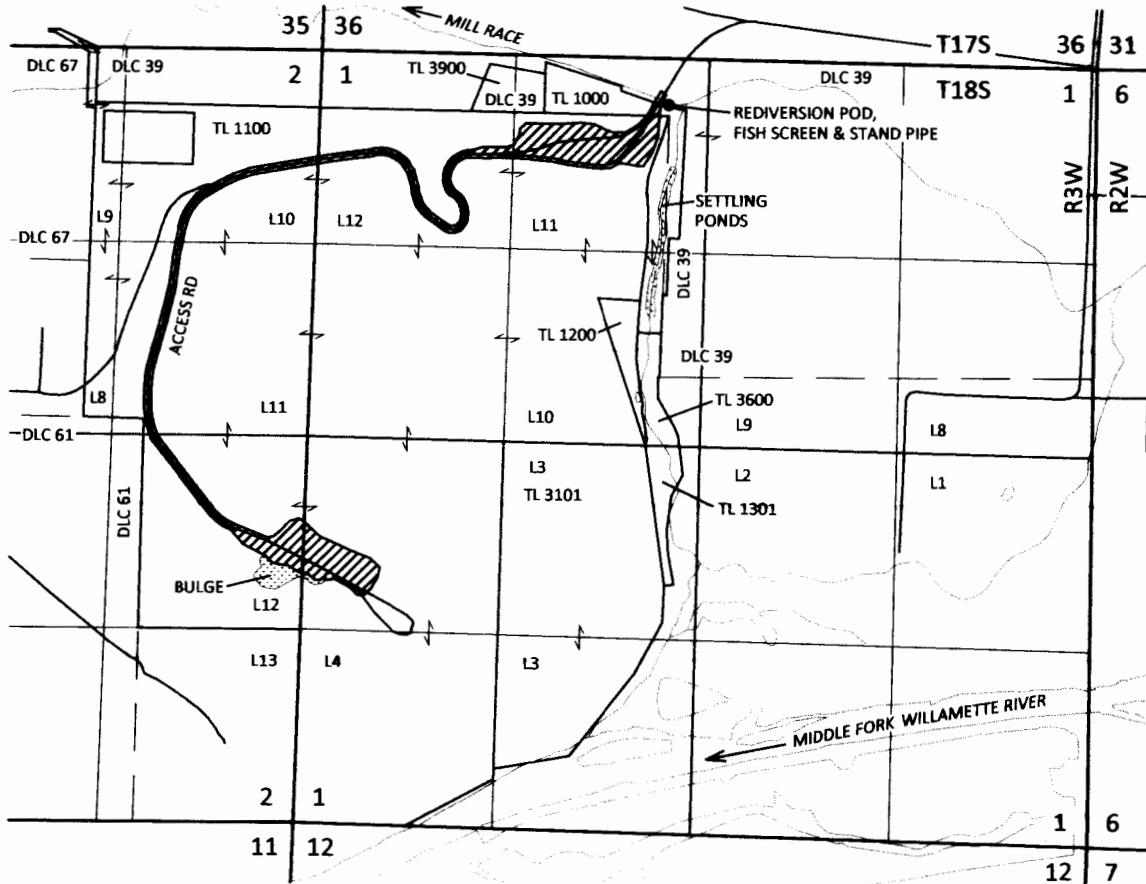

RIVER POD LOCATION: 450 FT S AND 2510 FT W FROM NE CORNER OF SECTION 8, T18S, R2W, W.M.

REDIVERSION POD LOCATION: 370 FT S AND 2370 FT E FROM NW CORNER OF SECTION 1, T18S, R3W, W.M.

SCALE



1 INCH = 1320 FEET

Site inspection conducted
 March 29, 2016

April 7, 2016

This map is not intended to provide legal dimensions or locations of property ownership lines

Figure 1

SKOOKUM
 WATER ASSOCIATES INC

1626 VICTORIAN WAY
 EUGENE, OR 97401
 (503) 319-8926

EXPLANATION



PLACE OF USE
 PRIORITY: 10/16/1963



POINT OF DIVERSION (POD)