

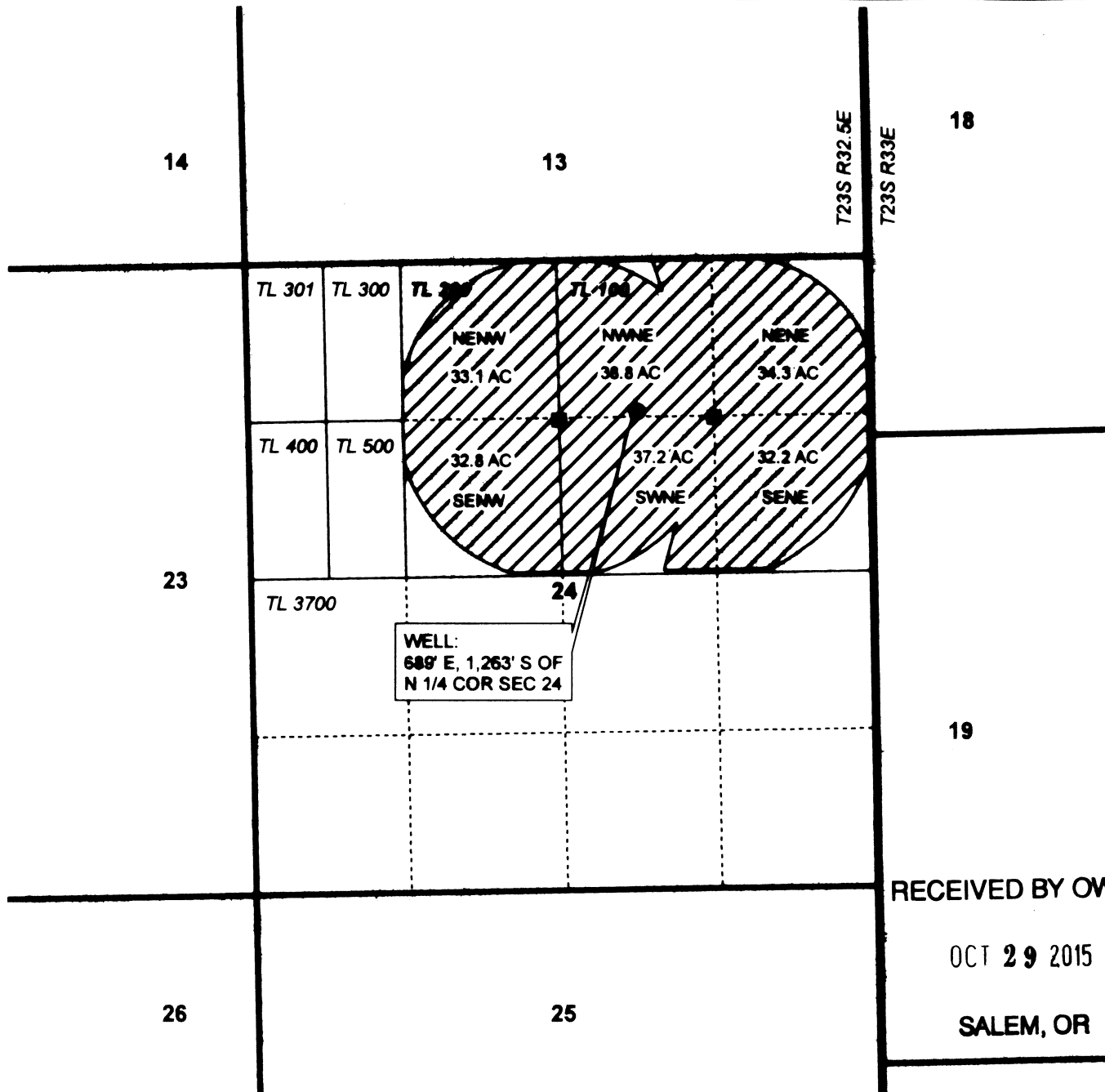

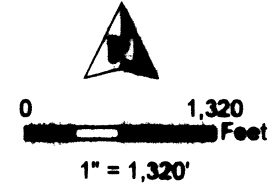





**T23S, R32.5 E,
SECTION 24, WM**

HARNEY COUNTY, OREGON



WELL:
689' E, 1,263' S OF
N 1/4 COR SEC 24



-  POU Irrigation (208.4 acres)
-  Township
-  Section
-  Quarter Quarter
-  Taxdot
-  Well
-  Meter

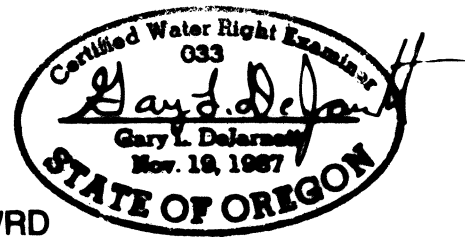

RECEIVED BY OWRD

RENEWAL DATE 12/31/2015

OCT 29 2015

SALEM, OR



CLAIM OF BENEFICIAL USE MAP
Ensz

NOTE: THIS MAP IS NOT INTENDED TO
PROVIDE LEGAL DIMENSIONS OR LOCATIONS
OF PROPERTY OWNERSHIP LINES.

WATER RIGHT SERVICES, LLC
PO BOX 1830, BEND, OR 97709
CCB# 197121 www.oregonwater.us
541-389-2837 JOHNSHORT@USA.COM

AP G-16420

PERMIT G-16039

PROJECT #14105

JANUARY 12, 2015