

979

COBU MAP 979

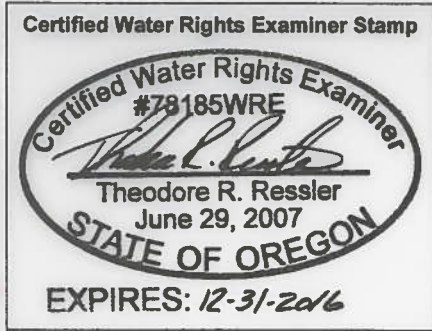

RECEIVED BY OWRD  
 FEB 1-6 2016  
 SALEM, OR

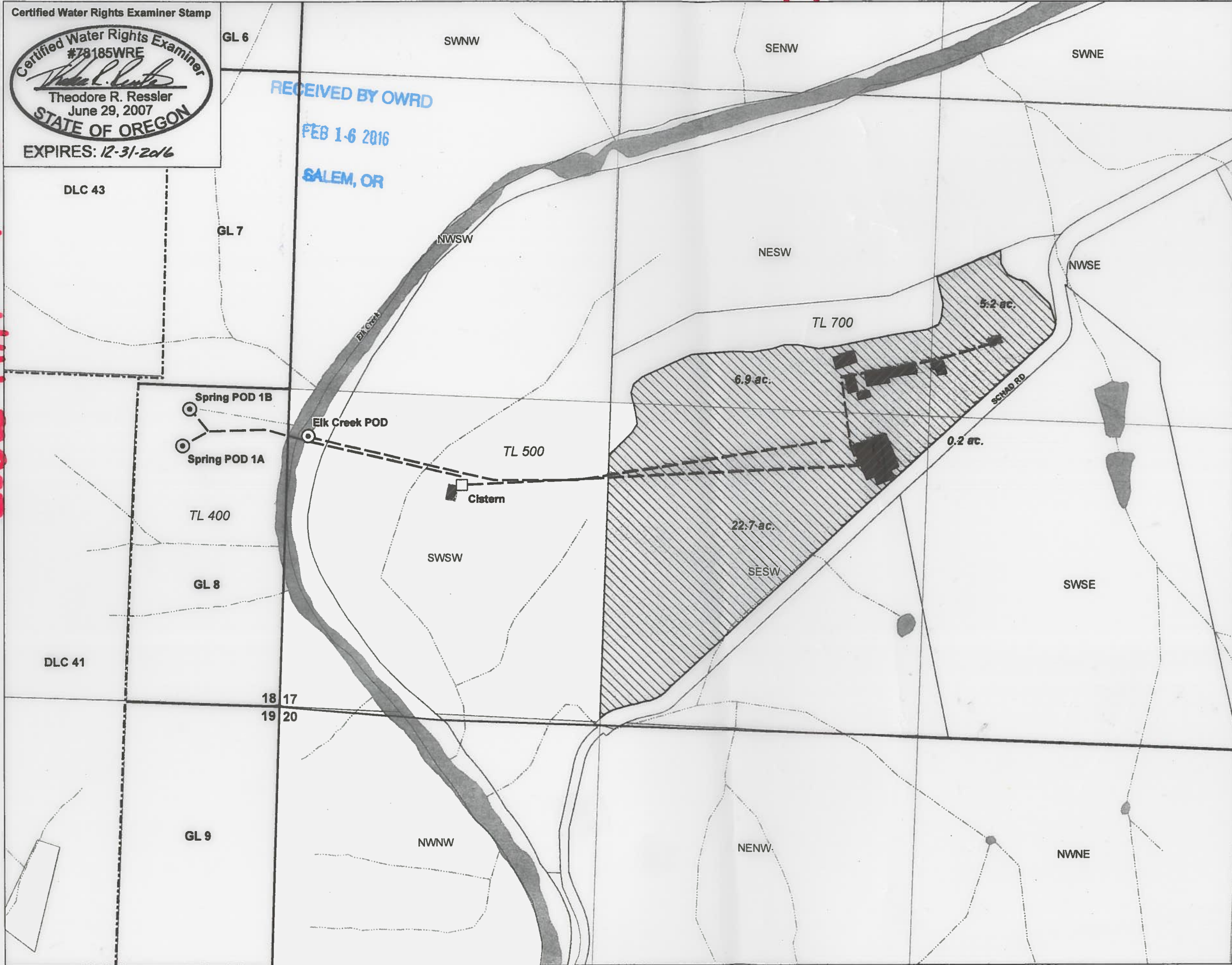

**Claim of Beneficial Use**  
 Permit S-44863 (Application S-59559)  
 Water Right in the Name of  
 Elk Creek Farms, LLC  
 Douglas County  
 Township 22 South, Range 7 West (W.M.)

- LEGEND**
- ⊙ Point of Diversion (POD)
  - Cistern
  - - Mainline
  - Place of Use (POU)**
  - ▨ Creek Source, 35 ac.
  - Spring Source
  - All Other Features**
  - ⊕ Tax Lot
  - ⊞ Donation Land Claim (DLC)
  - ⊞ Government Lot (GL)
  - ☁ Waterbody
  - ~ Watercourse

**POD LOCATION DESCRIPTIONS**

**Spring POD 1A**  
 Located 1,085 feet North and 435 feet West from the SE corner of Section 18, Township 22 South, Range 7 West (W.M.)

**Spring POD 1B**  
 Located 1,220 feet North and 410 feet West from the SE corner of Section 18, Township 22 South, Range 7 West (W.M.)

**Elk Creek POD**  
 Located 1,120 feet North and 85 feet East from the SW corner of Section 17, Township 22 South, Range 7 West (W.M.)

**DISCLAIMER**  
 This map was prepared for the purpose of identifying the location of a water right only and it is not intended to provide legal dimensions or location of property ownership lines.

N

0 200 400 600  
 1 inch = 400 feet

**MAP NOTES:**  
 Date: January 6, 2018  
 Data Sources: Douglas Co, BLM, USGS

**GSI**  
 Water Solutions, Inc.