

FINAL PROOF SURVEY MAP

IN THE NAME OF RUSSELL S. AND PATTI R. FRASER

APPLICATION R-71841
S-71842

PERMIT R-12100
52997

SECTIONS 12 & 13, TOWNSHIP 30 SOUTH, RANGE 15 WEST, W.M.

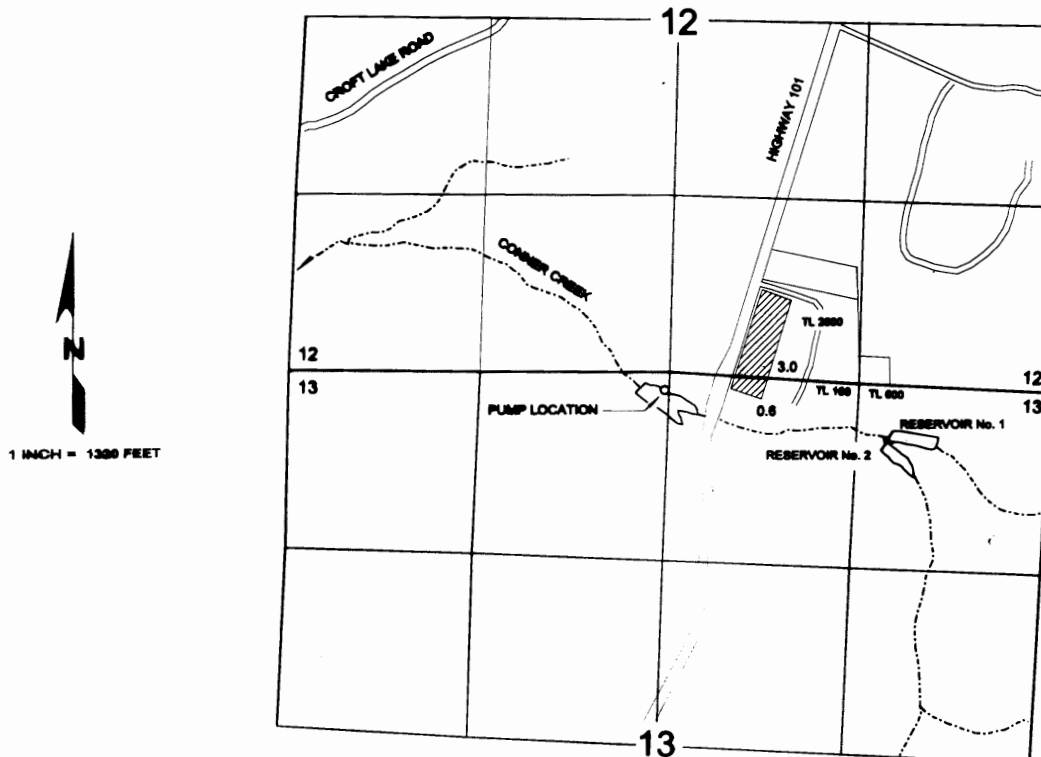

THE POINTS OF DIVERSION ARE LOCATED AS FOLLOWS:

RESERVOIR No. 1: 440 FEET SOUTH AND 1510 FEET EAST; BEING WITHIN THE NE $\frac{1}{4}$ NE $\frac{1}{4}$;
RESERVOIR No. 2: 510 FEET SOUTH AND 1470 FEET EAST; BEING WITHIN THE NE $\frac{1}{4}$ NE $\frac{1}{4}$; AND
PUMP LOCATION: 130 FEET SOUTH AND 40 FEET WEST; BEING WITHIN THE NE $\frac{1}{4}$ NW $\frac{1}{4}$; ALL
FROM THE NORTH QUARTER CORNER OF SECTION 13 AND WITHIN SECTION 13, TOWNSHIP 30 SOUTH,
RANGE 15 WEST, W.M.; COOS COUNTY.



THE PURPOSE OF THIS MAP IS TO IDENTIFY THE LOCATION OF THE WATER RIGHT.
IT IS NOT INTENDED TO PROVIDE INFORMATION RELATIVE TO THE LOCATION OF
PROPERTY OWNERSHIP BOUNDARY LINES.