

**Claim of Beneficial Use**

**Place of Use Map**

Permit S-42117 (Application S-55338)

City of Cottage Grove

RECEIVED BY OWRD

SEP 01 2015

SALEM, OR

**Legend**

- Point of Diversion (POD)
- Place of Use (POU)
- Water Service Area
- Tax Lots
- Waterbodies
- Watercourses
- Major Roads

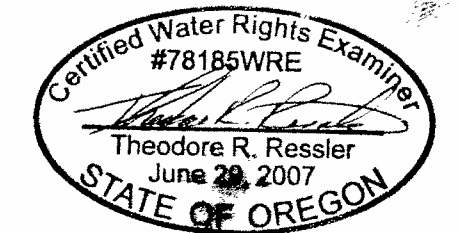

EXPIRES: 12-31-2016

**DISCLAIMER:**

This map was prepared for the purpose of identifying the location of a water right only and it is not intended to provide legal dimensions or location of property ownership lines.

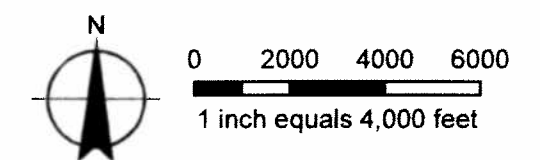

**MAP NOTES:**

Projection: Oregon State Plane South Zone  
 Datum: North American Datum of 1983  
 Date: July 30, 2015  
 Data Sources: LCOG, OWRD, ESRI, Oregon Geospatial Data Clearinghouse



SEP 01 2015

SALEM, OR

**Claim of Beneficial Use  
Point of Diversion Map  
Permit S-42117 (Application S-55338)  
Township 20 South, Range 3 West (W.M.)**

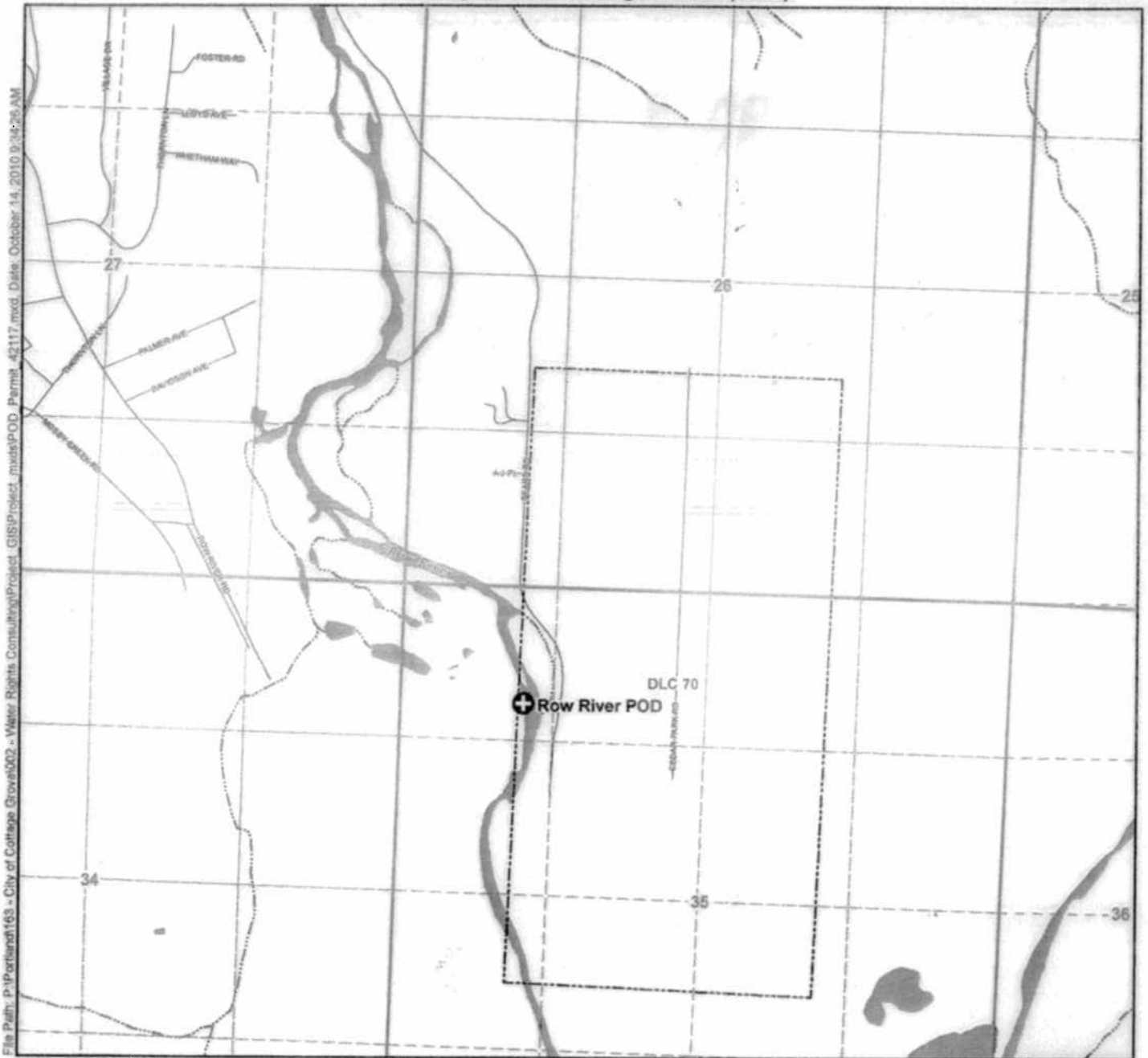

**Legend**

- Point of Diversion (POD)
- Streets
- Waterbodies
- Watercourses

**POD Legal Descriptions**

Row River POD  
Located 1000 feet South and 1050 feet  
East from the NW corner of Section 35,  
Township 20 South, Range 3 West (W.M.)



EXPIRES: 12-31-2016

**Map Information**

Projection: Oregon State Plane South Zone  
Datum: North American Datum of 1983  
Date: October 14, 2010  
Prepared By: GSI Water Solutions, Inc.

**Data Sources**

OWRD, LCOG, Oregon Geospatial Data Clearinghouse

**Disclaimer**

This map was prepared for the purpose of identifying the location of a water right only and it is not intended to provide legal dimensions or location of property ownership lines.



**Scale**

0 330 660 1320

1 inch equals 1,320 feet

