

PREPARED BY:

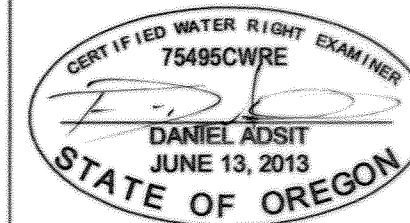

RECEIVED
JUN 28 2016
OWRD

DATE SIGNED:

PREPARED FOR:

OREGON WATER
RESOURCES
DEPARTMENT

REVISIONS			
NO.	DESCRIPTION	DATE	BY

PROJECT NO:	15078-6
HORIZ DATUM:	NTS
VERT DATUM:	NA
HORIZ SCALE:	1"=2000'
VERT SCALE:	AS SHOWN
DESIGN:	FDA
DRAWN:	FDA
CHECKED:	KKA

APPROVED:

SHEET TITLE

Molalla City Limits

1 of 1

P:\0118 Project\15078 Molalla Engineering Services\15078-A Water Rights Review\The CAD\Drawings\Water Right\15078-A Water Rights Review\15078-A Water Rights Review.dwg 01/13/2016 4:23:58 PM

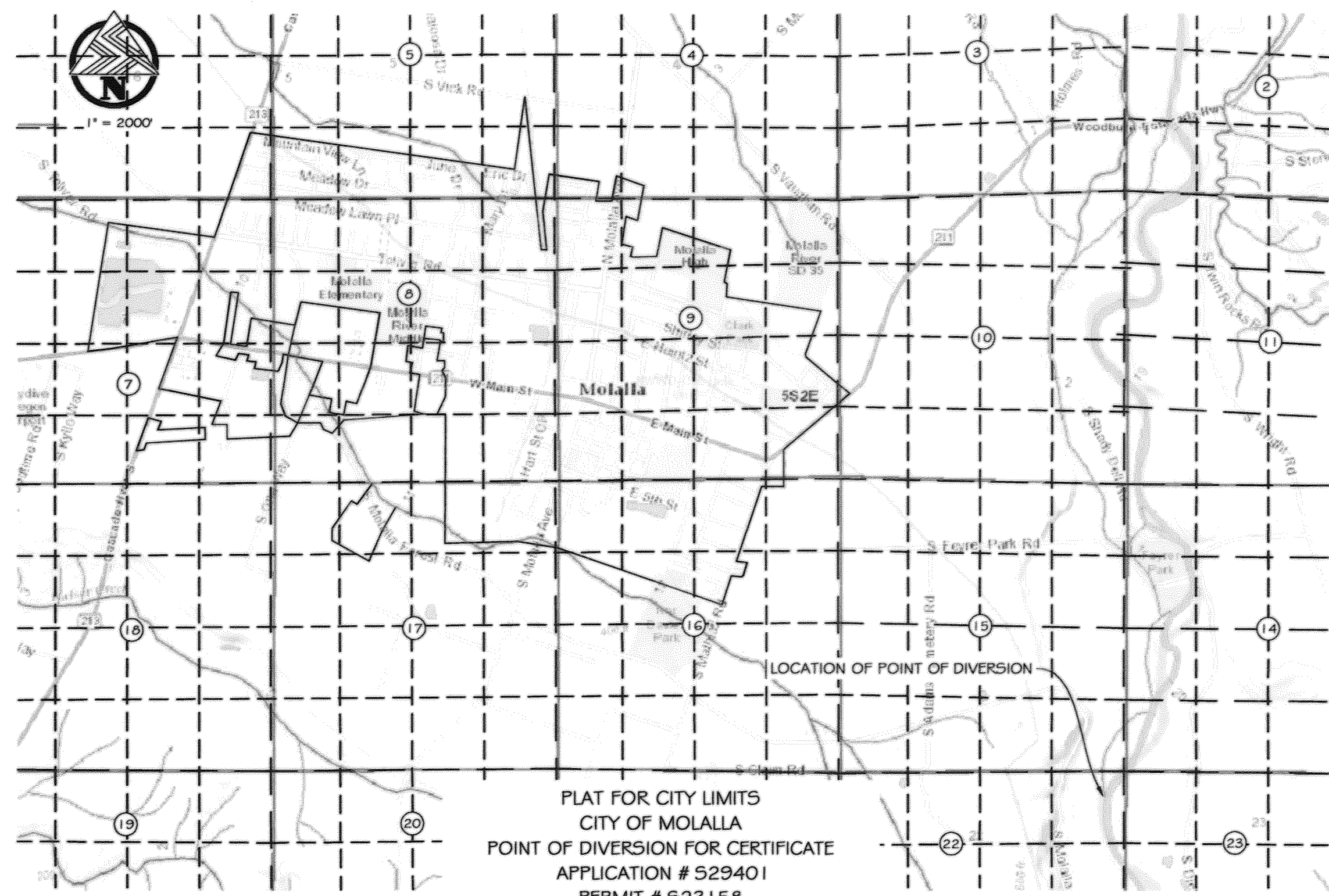

PLAT FOR CITY LIMITS
CITY OF MOLALLA
POINT OF DIVERSION FOR CERTIFICATE
APPLICATION # 529401
PERMIT # 523158

T.5S., R.2E, W.M.
SECTION 15 & 22
POINT OF DIVERSION FOR CERTIFICATE
APPLICATION # S29401
PERMIT # S23158

IN THE NAME OF
CITY OF MOLALLA,
OREGON
MARCH 2, 2016

RECEIVED

MAR 7 2016

WATER RESOURCES DEPT
SALEM, OREGON

PLOT DATE/TIME: 3/2/2016 - 7:37am

P:\2015 Projects\15078 Molalla Engineering Services\15078-6 Water Rights Review\The CAD\Survey\Water Rights Application Sketch.dwg

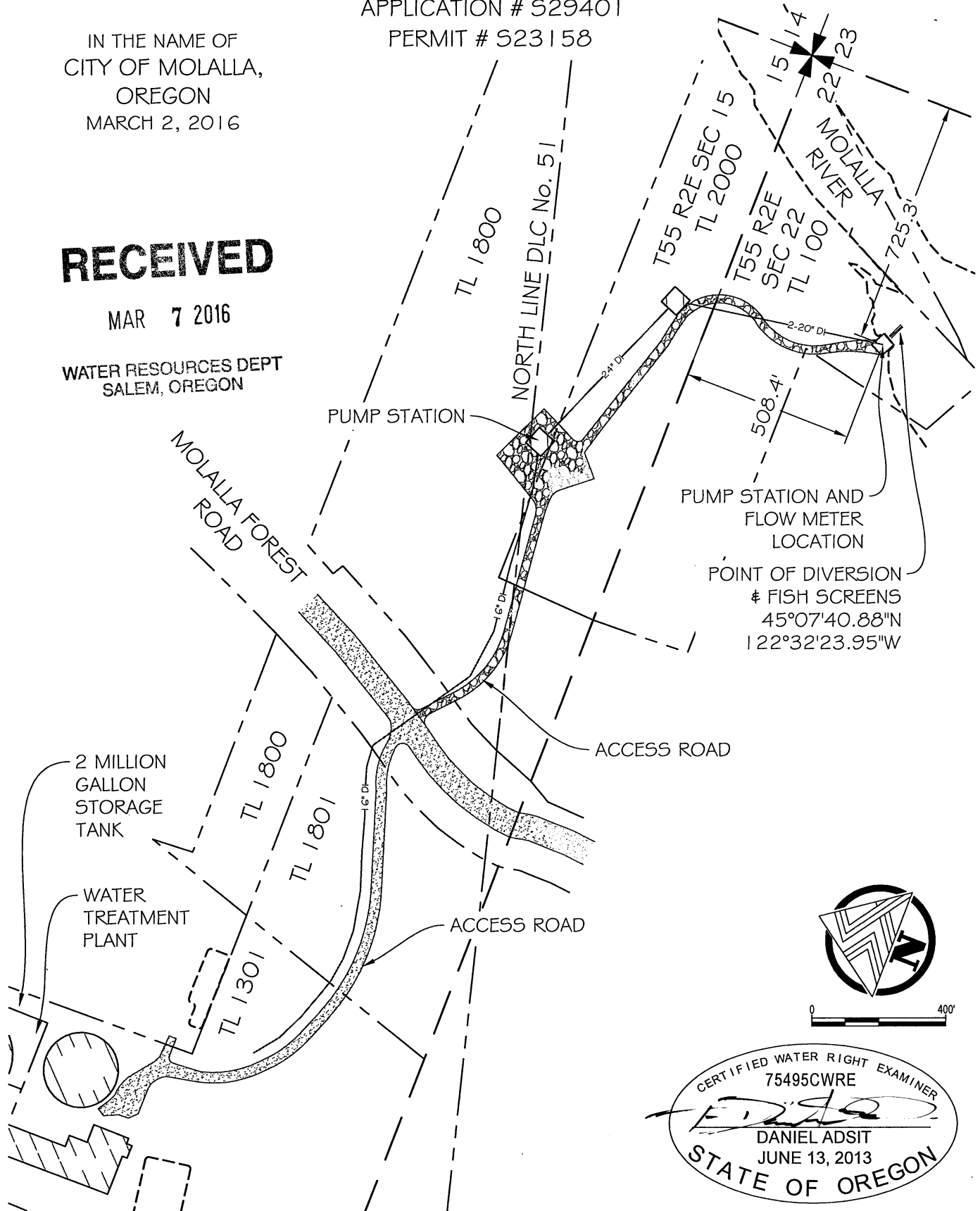

CERTIFIED WATER RIGHT EXAMINER
75495CWRE
Daniel Adsit
DANIEL ADSIT
JUNE 13, 2013
STATE OF OREGON



NOTE: THIS MAP IS FOR THE PURPOSE OF IDENTIFYING THE LOCATION OF THE WATER RIGHT ONLY AND IS NOT INTENDED TO PROVIDE LEGAL DIMENSIONS OR LOCATIONS OF PROPERTY LINES.