

T. 5 S. R. 1 E. W. M.

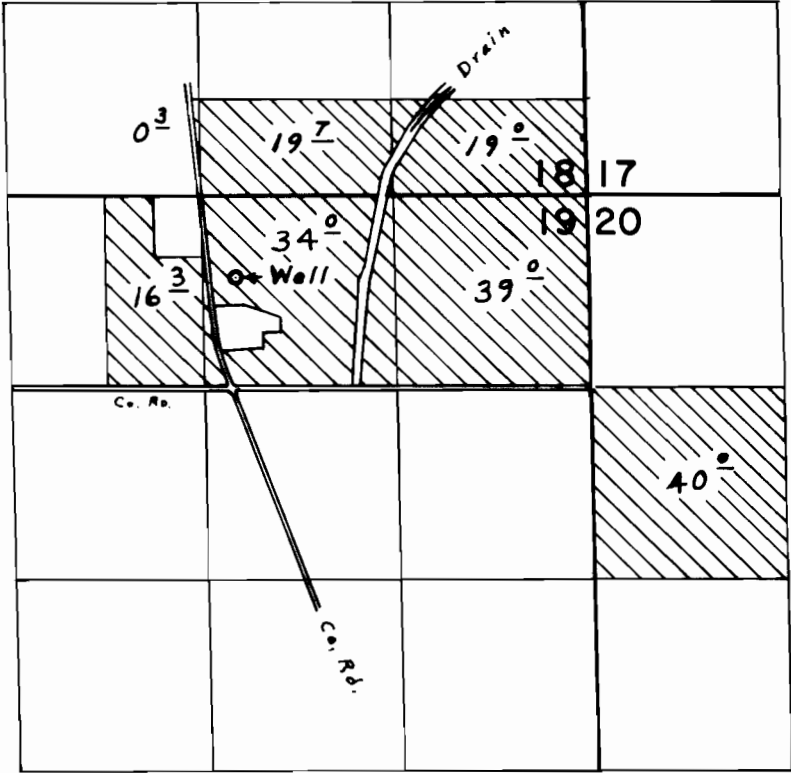

Well located 570' S. & 2420' W. from N.E. Cor. Sec. 19

FINAL PROOF SURVEY UNDER

Application No. G-6144 Permit No. G-5164
IN NAME OF

HESSEL BIERMA

Surveyed May 9, 1975, by L. E. Gould