

# T. 5 S., R. 5 W., W.M.

Location: THE NE 1/4 & NW 1/4 OF THE SE 1/4 WITHIN SECTION 32, T. 5 S., R. 5 W., W.M., ALL WITHIN THE JAMES TONEY DLC NO. 56, YAMHILL COUNTY, OREGON.

Tax Lot: 5532-1100

Date: 12 JUNE 2012

Scale: 1"=400'

This map is to be used for the purpose of identifying the location of water right only and is not intended to provide legal dimensions or locations of property ownership lines.

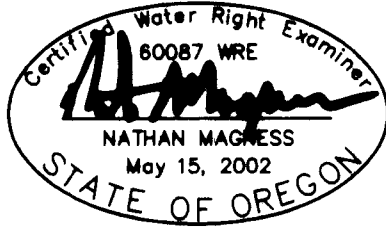

By : MAGNESS LAND SURVEYING  
 PO BOX 1239  
 WILLAMINA, OREGON, 97396  
 Cell : 971-237-3413  
 E-Mail: MAGNESS@OWBCABLE.NET

SW 1/4 OF  
 THE NE 1/4

SPIKE SET IN IRON PIPE IN MONUMENT CASE. ON RECORD AS BEING N00°08'00"W 2391.84 FEET NORTH OF THE SE CORNER OF THE TONEY DLC NO. 56.

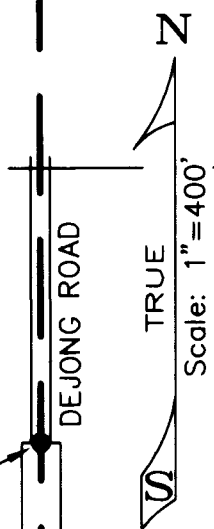

**RECEIVED**

JUN 28 2013

WATER RESOURCES DEPT  
 SALEM, OREGON

NW 1/4 OF  
 THE SE 1/4

RISER  
 (TYPICAL)

HANDLINE

NE 1/4 OF  
 THE SE 1/4

MAINLINE

NE 1/4 OF  
 THE SW 1/4

LEGEND:

- = Property line
- = D.L.C. line
- = Section line
- = "40" line
- = Place of Use
- = Riser

FISH SCREEN - BEARS  
 N31°19'18"W 63.81' FROM  
 THE POD.

POINT OF DIVERSION NO. 1: 610  
 FEET NORTH OF THE SE CORNER  
 OF THE JAMES TONEY DLC NO. 56.

SE CORNER OF THE JAMES TONEY  
 DLC NO. 56. NO MONUMENT.  
 CALCULATED THRU SURVEY  
 CS-2670.

N89°35'55"W 5314.60'

3" BRASS CAP,  
 FLUSH, SW  
 CORNER TONEY  
 DLC NO. 56

## FINAL PROOF SURVEY

UNDER

Transfer No. T-11472

IN NAME OF

**DENNIS G. GRAUER & AVA JAN GRAUER**  
**TRAVIS A. GRAUER & LAYCEE GRAUER**

Surveyed June 12, 2013

\* map revised by WRD To correctly reflect Dec 56 GIS/WRD 6-27-16

#348