

5001

COBL MAP 1005

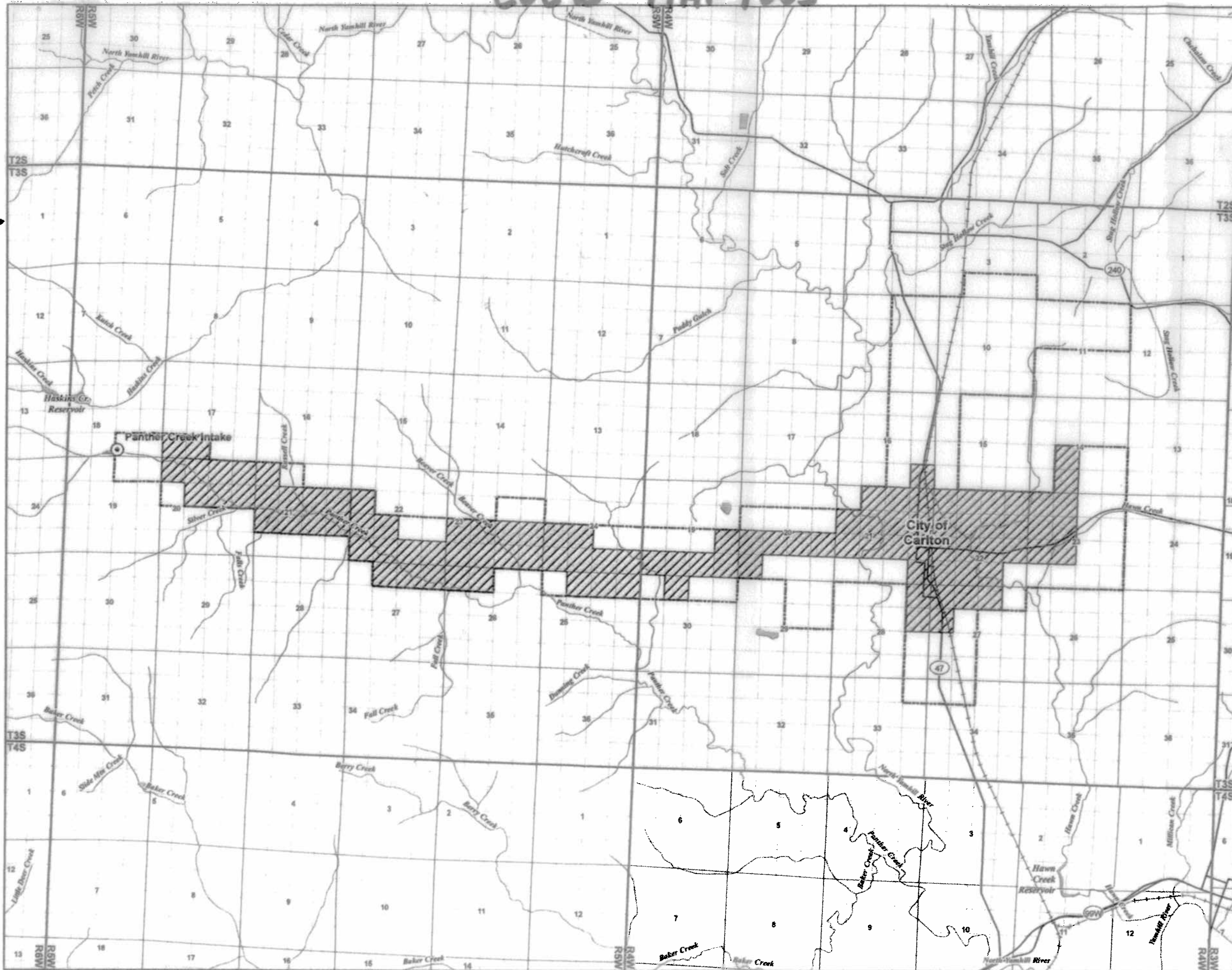

**Claim of Beneficial Use
Place of Use Map
Partial Perfection of
Permit S-32489
(Application S-44208)**

**A Water Right in the Name of
City of Carlton
Yamhill County**

**Township 3 South,
Ranges 4 & 5 West (W.M.)**

LEGEND

- ⊙ Point of Diversion (POD)
- ▨ Place of Use (POU)
- Service Area
- ☁ Waterbodies
- ~ Watercourses
- ⌒ Detailed Streets
- Railroads

SALEM, OR

MAY 11 2016

PREPARED BY OWRD

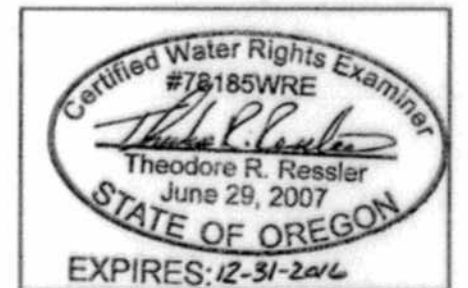

CWRE Stamp and Signature

DISCLAIMERS:

1. This map was prepared for the purpose of identifying the location of a water right only and it is not intended to provide legal dimensions or location of property ownership lines.
2. Under the provisions of ORS 540.510(3) the City of Carlton may lawfully provide and use water in locations other than those described.

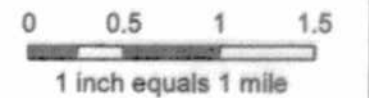

MAP NOTES:

Date: April 25, 2016
Data Sources: OWRD, ESRI, Oregon Geospatial Data Clearinghouse, City of Carlton





**Planners
Engineers
Surveyors**

3300 NW 211th TERRACE
HILLSBORO, OREGON 97124
PHONE: (503) 858-4242
FAX: (503) 645-5500
EMAIL: ldch@ldcdesign.com

FINAL PROOF SURVEY

Scale: 1" = 1320'

PREPARED FOR: CITY OF CARLTON
191 EAST MAIN STREET
P.O. BOX 458
CARLTON, OREGON 97111
(503) 852-7575

DATE: 05-14-01

SITE LOCATION:

IN THE SOUTHEAST 1/4 OF SECTION 18, TOWNSHIP 3 SOUTH, RANGE 5 WEST,
WILLAMETTE MERIDIAN, YAMHILL COUNTY, STATE OF OREGON.

THIS IS NOT A BOUNDARY SURVEY - FOR WATER RIGHT PURPOSES ONLY

I certify that the information I have provided in this application is an accurate representation of the proposed water use and is true and correct to the best of my knowledge. It is to be used for the purpose of identifying the location of water right only and is not intended to provide legal dimensions or locations of the property ownership lines.

APPLICATION NUMBER: S-44208
PERMIT NUMBER: 32489

SOURCE: PANTHER CREEK
TRIBUTARY TO: NORTH YAMHILL RIVER

MAP NOTE:

MAP DRAWN USING DIMENSIONS AND PROJECTIONS FROM CS-11170, A RECORDED SURVEY IN YAMHILL COUNTY. CONVEYANCE AND DIVERSION POINT COLLECTED USING A HANDHELD GPS UNIT.

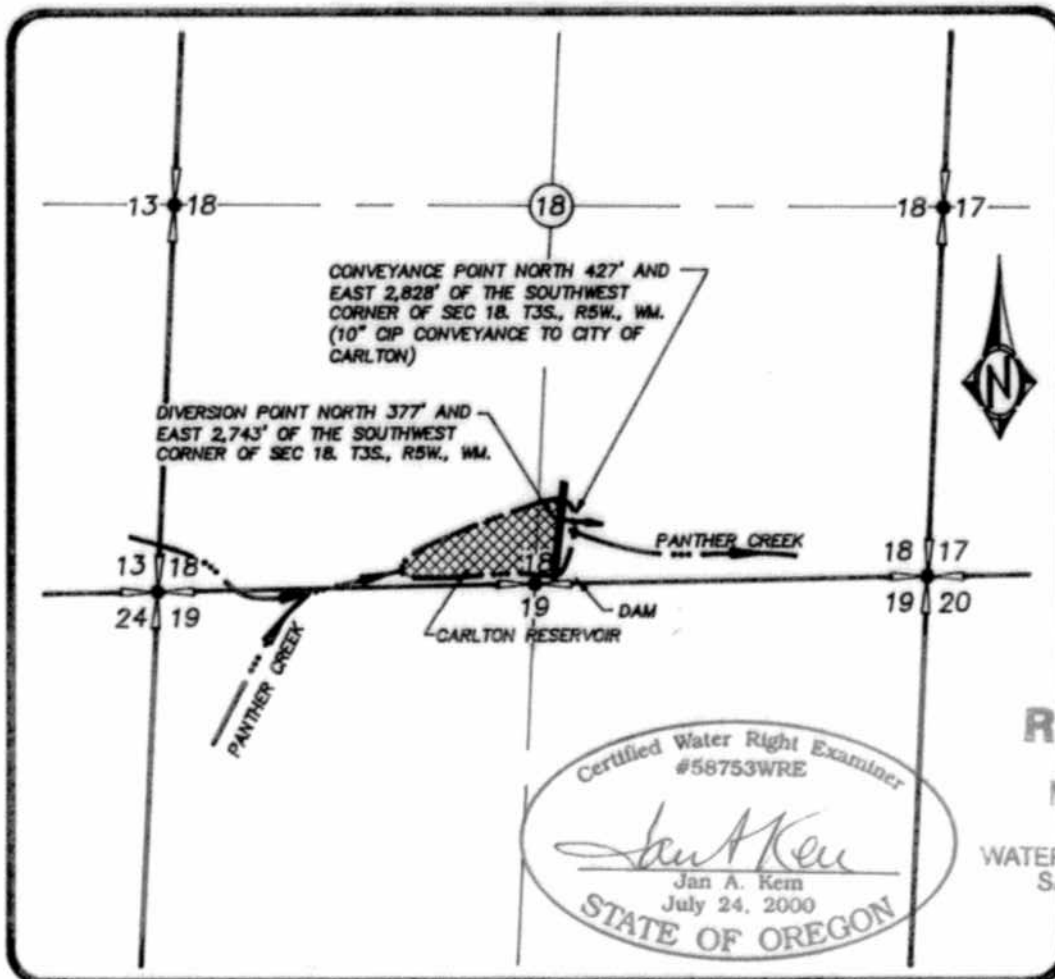

Certified Water Right Examiner
#58753WRE
Jan A. Kern
Jan A. Kern
July 24, 2000
STATE OF OREGON

RECEIVED
MAY 30 2001
WATER RESOURCES DEPT
SALEM, OREGON