

Section 18 Section 17
Section 19 Section 20

Approximate Location
of Section Divider

RECEIVED

MAR 15 2002

WATER RESOURCES DEPT.
SALEM, OREGON

PROJECT SITE
(TAX LOT #401)

T28S, R6W
NW ¼, NW ¼ SEC. 20

Proposed Mitigation Depression #1
Requiring Water Right
Approx 620 feet south and 900 feet east from
northwest corner of Section 20, T28S, R6W
(Water source: unnamed intermittent drainage
and upgradient runoff)

Unnamed Intermittent Drainage
(Tributary to Lookingglass Creek)

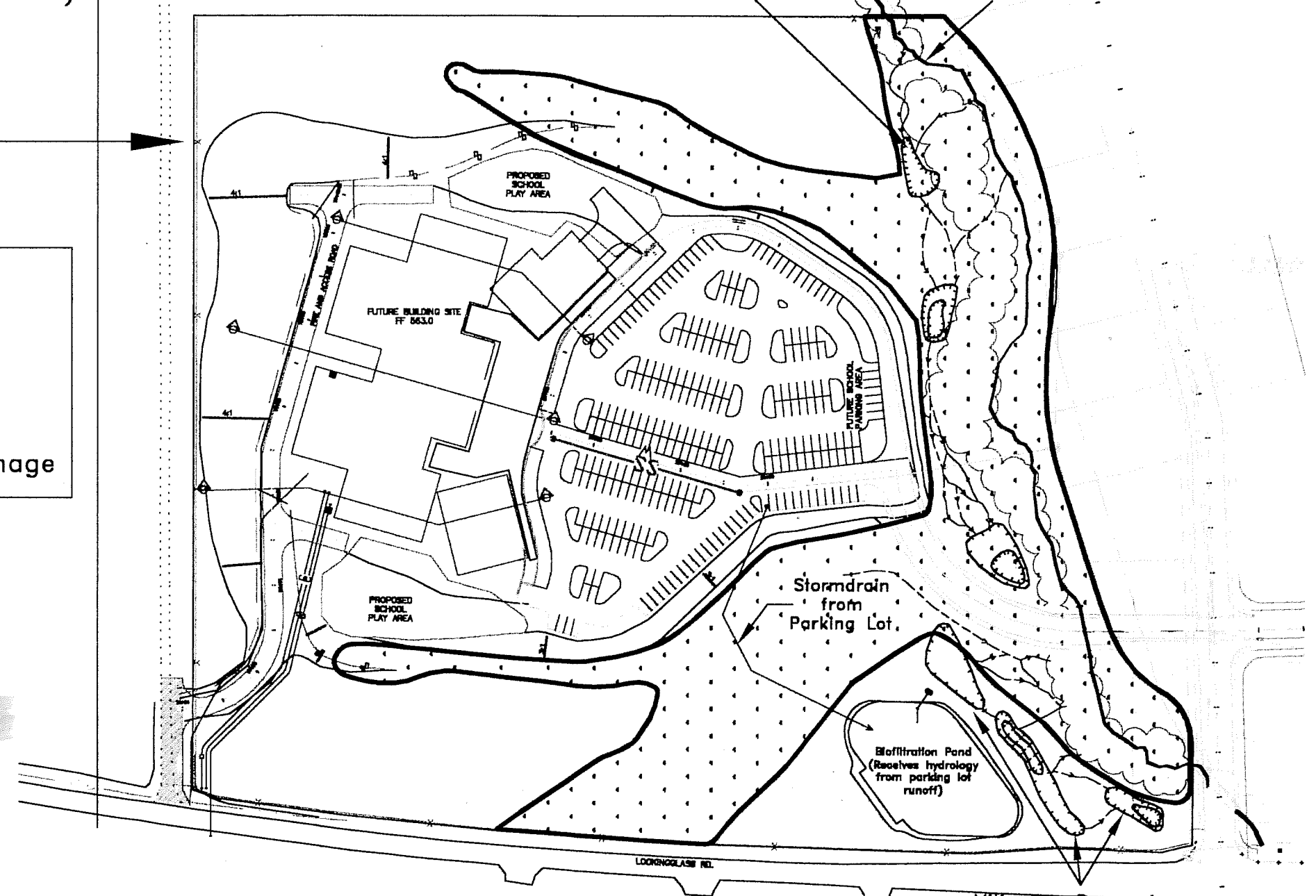
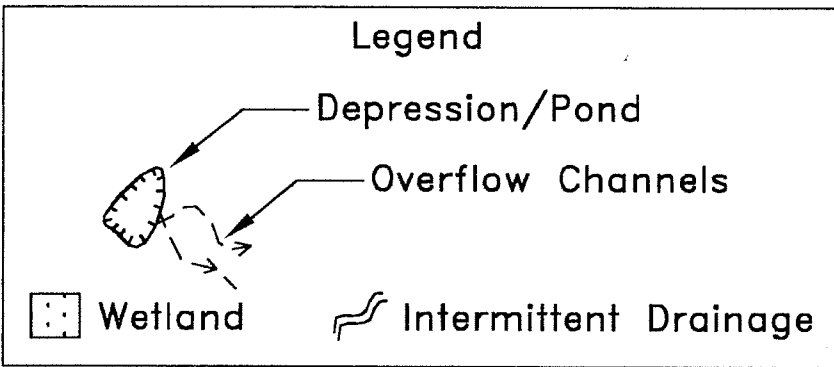

Mitigation Depressions
(Receives hydrology from parking lot via biofiltration pond)



Application No. R-85077
Permit No.
RECEIVED BY OWRD

SEP 08 2015
SALEM, OR

SOURCE: Adapted from Ie Engineering, Inc., Roseburg, Oregon, 2001.

PROPOSED MITIGATION DEPRESSION #1

WATER RIGHT APPLICATION FOR
THE WINSTON-DILLARD ELEMENTARY
SCHOOL SITE (TAX LOT 401)
Winston, Douglas County, Oregon

Terra Science, Inc.
Soil, Water & Wetland Consultants

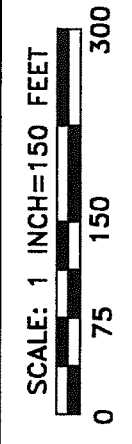

March 2002