

Section 18 Section 17  
Section 19 Section 20

Approximate Location  
of Section Divider

T28S, R6W  
NW 1/4, NW 1/4 SEC. 20



RECEIVED

MAR 15 2002

WATER RESOURCES DEPT.  
SALEM, OREGON

PROJECT SITE  
(TAX LOT #401)

Proposed Mitigation Depression #2  
Requiring Water Right  
Approx. 780 feet south and 930 feet east from  
northwest corner of Section 20, T28S, R6W  
(Water source: unnamed intermittent drainage and  
upgradient runoff)

Unnamed Intermittent Drainage  
(Tributary to Lookingglass Creek)

Legend

- Depression/Pond
- Overflow Channels
- Wetland
- Intermittent Drainage

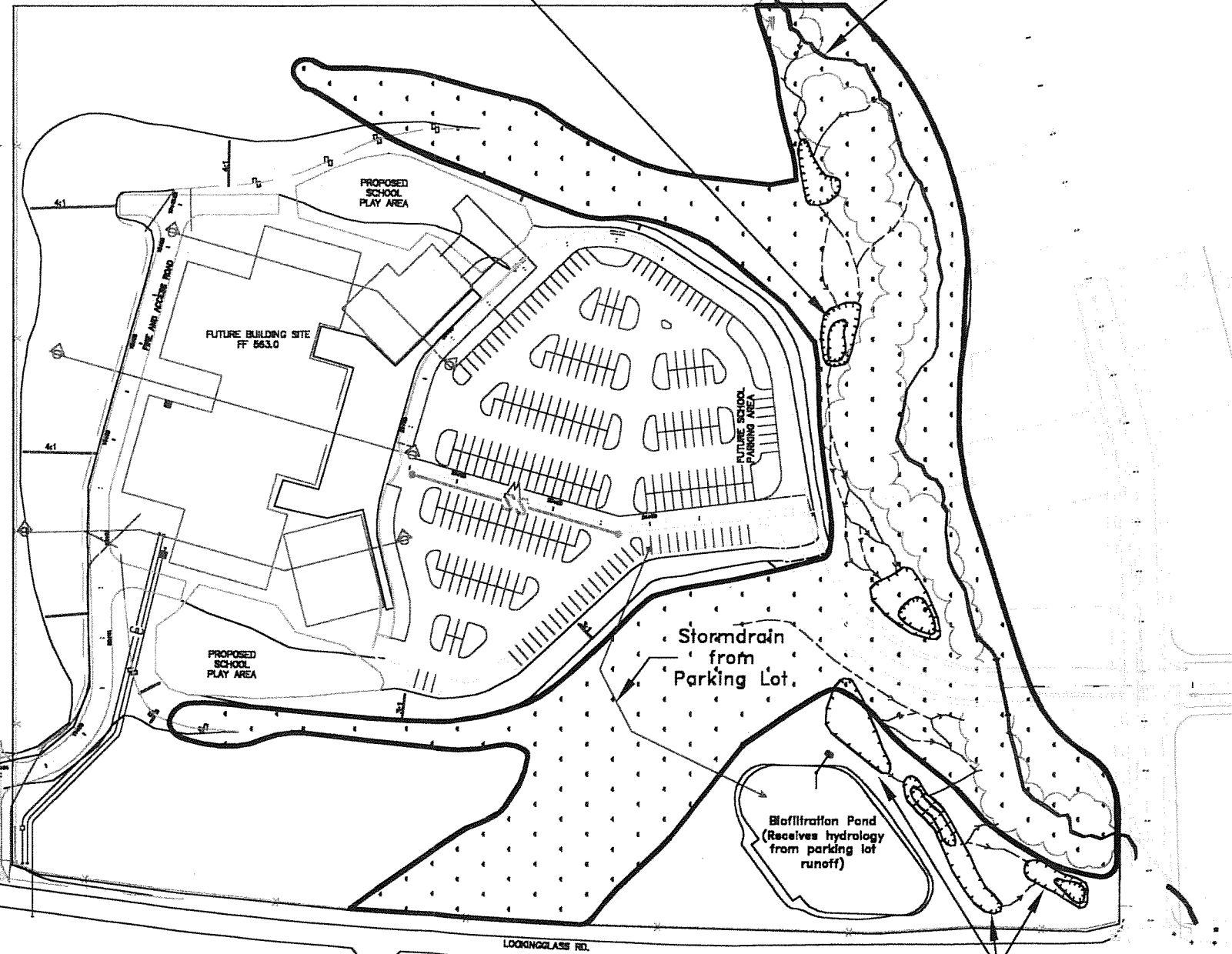

Mitigation Depressions  
(Receives hydrology from parking lot via biofiltration pond)

Application No. P-85078  
Permit No.

RECEIVED BY OWRD

SEP 08 2015

SALEM, OR

SOURCE: Adapted from ie Engineering, Inc., Roseburg, Oregon, 2001.

WATER RIGHT APPLICATION FOR  
THE WINSTON-DILLARD ELEMENTARY  
SCHOOL SITE (TAX LOT 401)  
Winston, Douglas County, Oregon

PROPOSED MITIGATION DEPRESSION #2

Terra Science, Inc.  
Soil, Water & Wetland Consultants

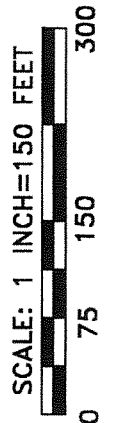

March 2002