

TOWNSHIP 9 SOUTH, RANGE 40 EAST, W.M.
SECTION 10, NW 1/4
BAKER COUNTY
PERMIT G-13611, APPLICATION G-14794

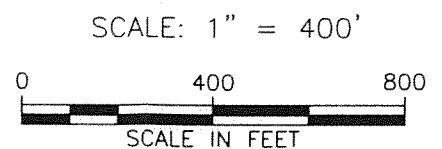

EXPLANATION:

- POINT OF APPROPRIATION (WELL)
- POINT OF APPROPRIATION (SUMP)
- PLACE OF USE

NOTES:

1. Point of appropriation (Well) located 1,190 feet south and 1,070 feet west of N 1/4 corner of Section 10.
2. Point of appropriation (Sump) located 1,650 feet south and 830 feet west of N 1/4 corner of Section 10.
3. Weir located 1,110 feet south and 1,060' feet west of N 1/4 corner of Section 10. Weir allows dewatering rate measurement.
4. Booster pump located 1,450 feet south and 1,150' feet west of N 1/4 corner of Section 10. Booster pump services gravel washing.

Site inspection completed on 8/26/04.

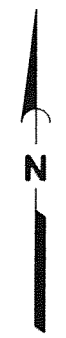
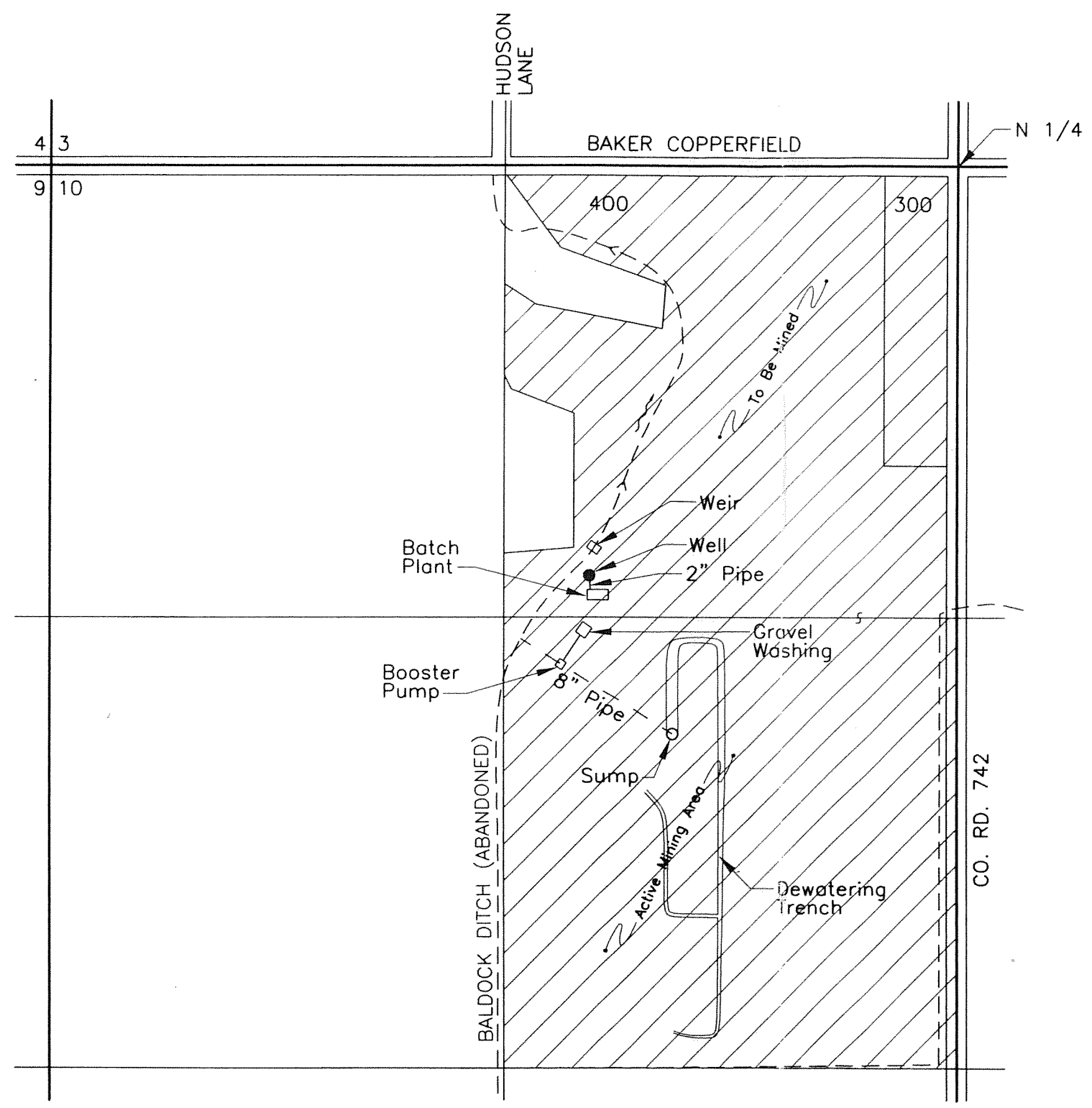

COBU MAP # 0144
 SRB:MMW 09/03/04
 Portland\p:\11\11611001\00\Cad\Figure1.dwg

RECEIVED

SEP 28 2004

WATER RESOURCES DEPT
SALEM, OREGON

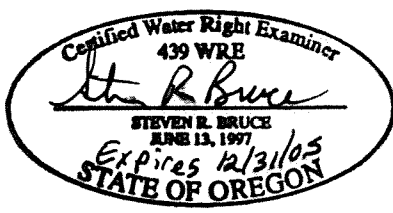

THIS MAP IS NOT INTENDED TO PROVIDE LEGAL DIMENSIONS OR LOCATIONS OF PROPERTY OWNERSHIP LINES.



CLAIM OF BENEFICIAL USE
TRIPLE C REDI-MIX, INC.

FIGURE 1