

FINAL PROOF SURVEY
 AND
 CLAIM OF BENEFICIAL USE
 SHOWING
 ADDITIONAL POINT OF APPROPRIATION
 E 1/2 SW 1/4 SECTION 35, T6N, R34E, WM
 IN NAME OF ADOLF C. KLEIN

TRANSFER 6241
 UNDER
 PERMITS 42205 & 46984
 (SEE SPECIAL ORDER RECORDS AT
 VOLUME 44, PAGES 118 & 119)

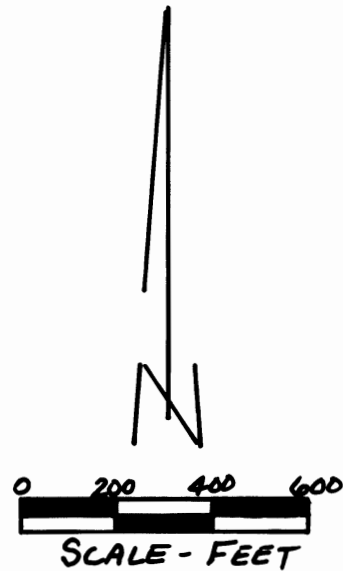
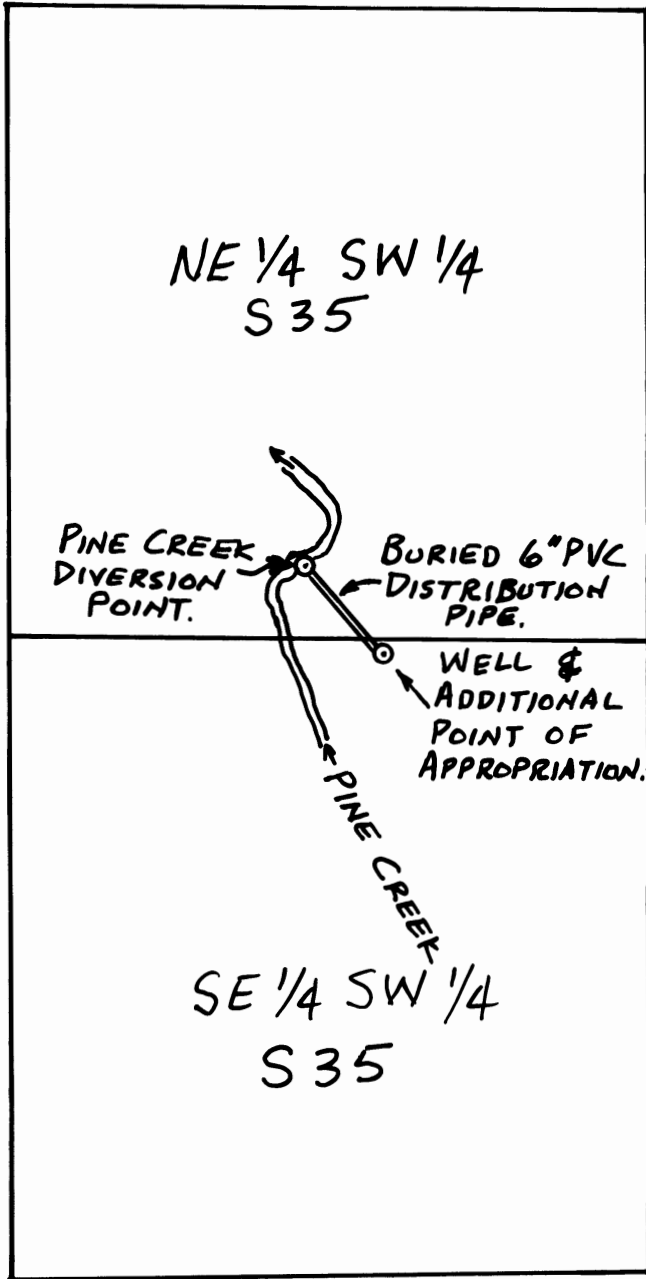

WELL IS 1,281 FEET NORTH AND
 551 FEET WEST FROM THE S 1/4
 CORNER OF SECTION 35.

SOUTH 1/4
 CORNER
 S 35

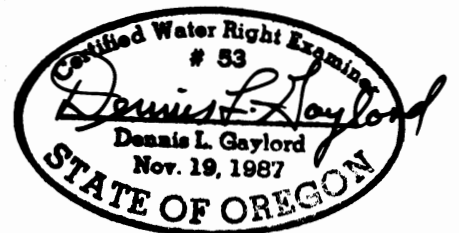

THIS MAP IS PREPARED FOR THE EXPRESS
 PURPOSE TO SHOW WATER APPROPRIATION.
 IT IS NOT INTENDED TO SHOW OR
 LOCATE PROPERTY OWNERSHIP LINES.

DENNIS L. GAYLORD, CWRE
 4107 S. W. LAKE DRIVE
 PENDLETON, OR 97801
 503-276-6260

U-711
3093

T.58&6N.R.34E.W.M.

CANCELLED
K49 P118

T-6291

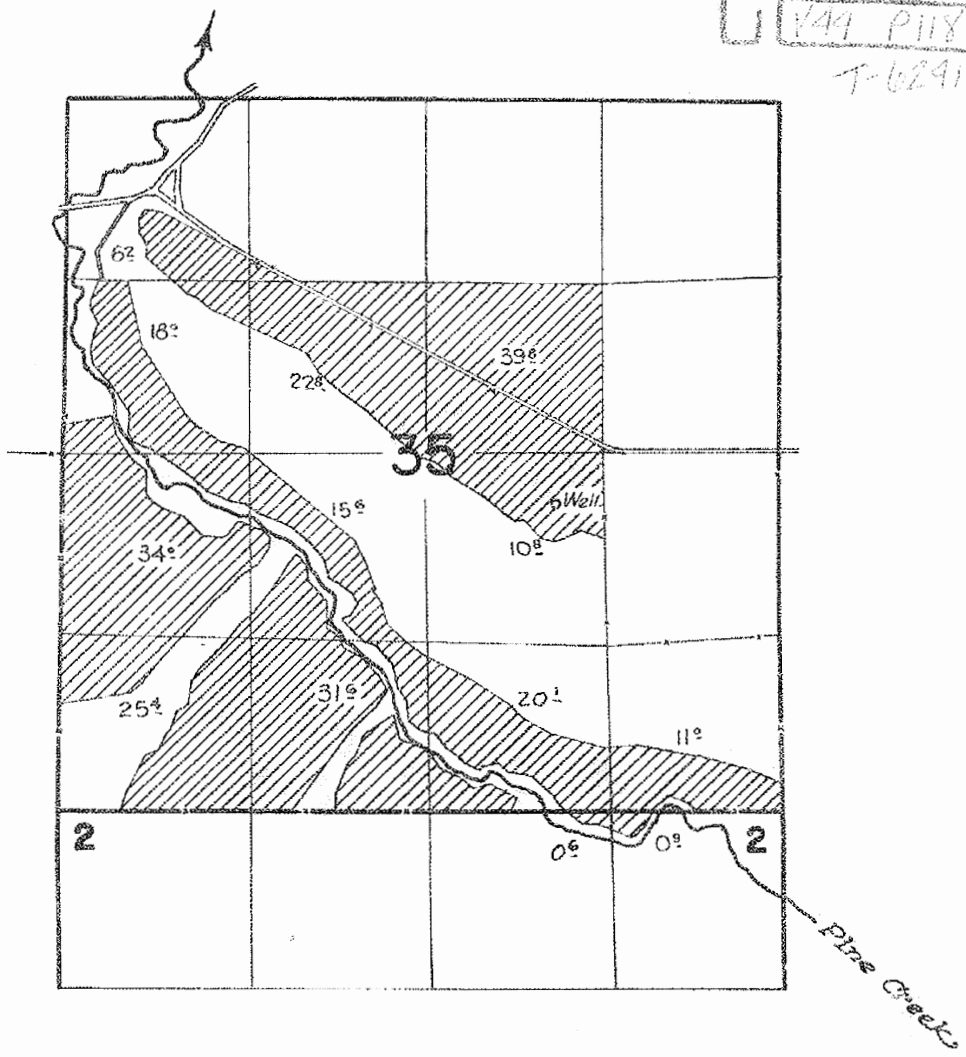

FINAL PROOF SURVEY
UNDER

Application No. U-793... Permit No. U-711.....
IN NAME OF

E. F. ARNOLD

Surveyed Sept. 15 1961., by C.O. Barleta.

G 9865
61092

CANCELLED
199 P18

T-641

T. 6N., R. 34E., W. M.

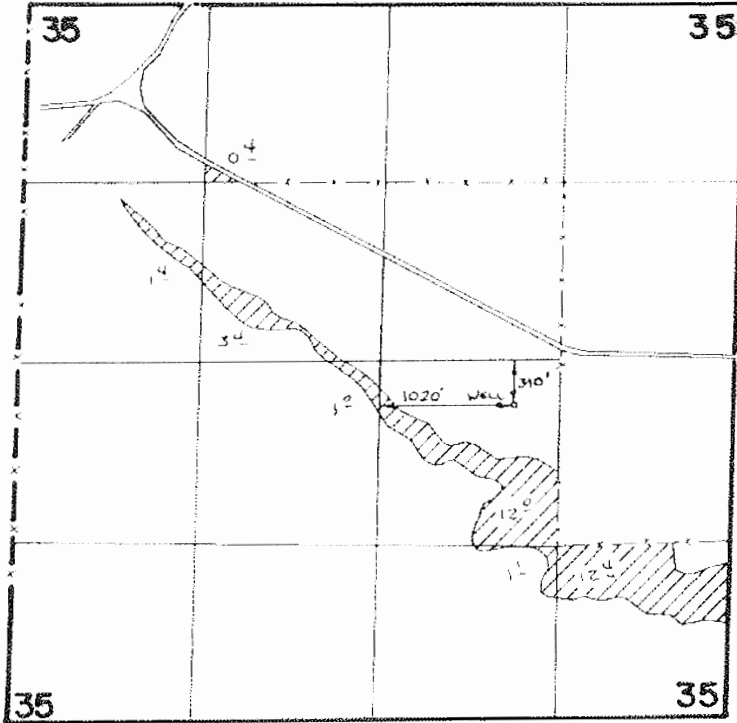

SCALE 1" = 1320'

FINAL PROOF SURVEY
UNDER

Application No. **G:9496** Permit No. **G:9865**
IN NAME OF

ADOLF C. KLEIN

Surveyed **3.2.2.** 19**87.**, by **V. b. Church**