

T.13S., R.32E.

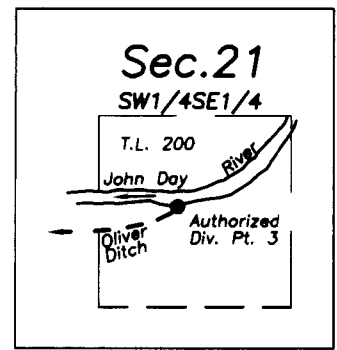

Authorized Div. Pt. 1 is 230' N. and 10' E. of the S1/4 Cor. Sec. 20 - T-6167
 Authorized Div. Pt. 2 (Oliver Ditch N. side) is 950' N. and 500' E. of the SW Cor. Sec. 21 - T-6710
 Authorized Div. Pt. 3 (Oliver Ditch S. side) is 900' N. and 1950' W of the SE Cor. Sec. 21 - S.O., V.13, P.95
 Authorized Div. Pt. 4 is in the NE1/4NE1/4 Sec. 30 - Per Adjudication Map - C-64330
 Additional Div. Pt. is 330' N. and 25' W. of the S1/4 Cor. Sec. 20

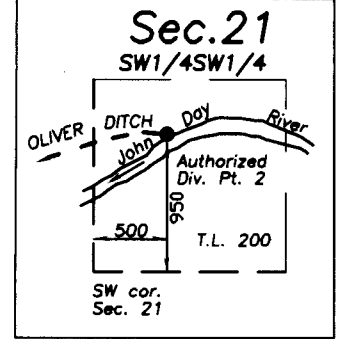
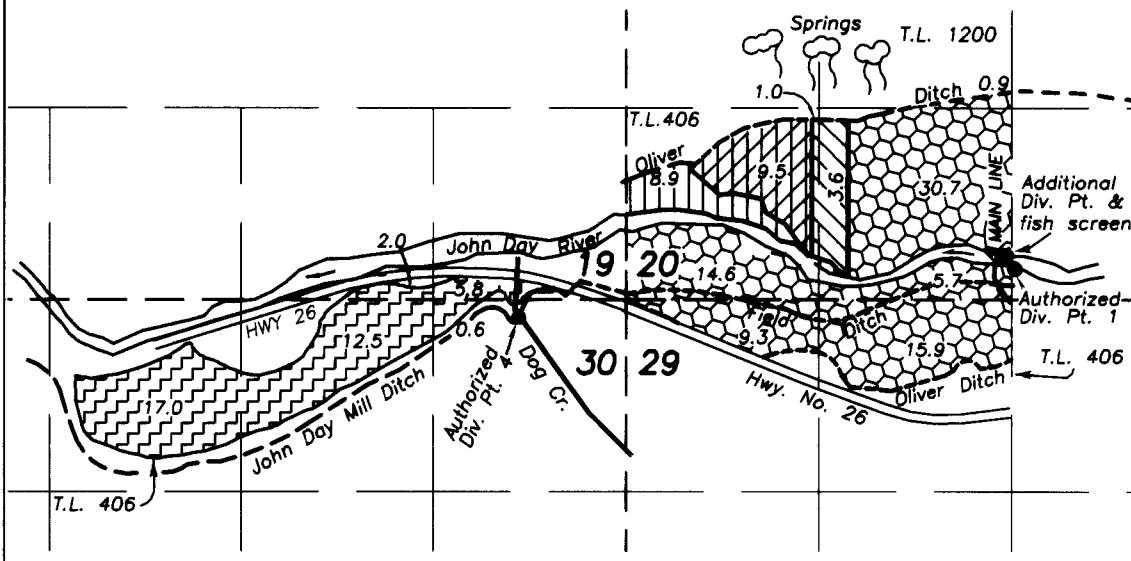
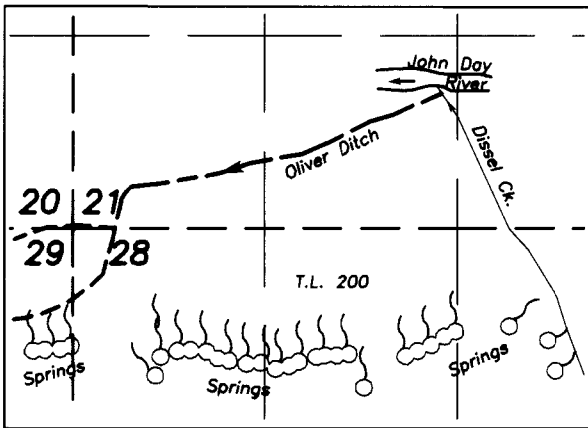

FINAL PROOF SURVEY
UNDER TRANSFER NO. T-9564
 FOR ADDITIONAL POINT OF DIVERSION
 IN NAME OF
BILL AND JEAN McNEIL
 BY

ROBERT D. BAGETT
 BAGETT-GRIFFITH & BLACKMAN
 P.O. BOX 476
 JOHN DAY, OR. 97845
 (541) 575-1251





RECEIVED

MAR 21 2008

SEPTEMBER 28, 2007

CURRENT PLACE OF USE
& ADDITIONAL P.O.D. - ALL LANDS

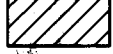
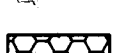
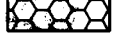
WATER RESOURCES DEPT
 SALEM, OREGON

-  C-67940 Primary Dissel Cr. & Springs 1868
-  C-80048 Primary John Day Riv. 1880
-  C-67940 Primary Dissel Cr. & Springs 1868
-  C-67940 Primary Dissel Cr. & Springs 1868
-  C-80047 Supplemental John Day Riv. 1983
-  C-67940 Primary John Day Riv., Dissel Cr. and Springs 1868
-  C-64330 John Day Riv. & Dog Cr. 1870

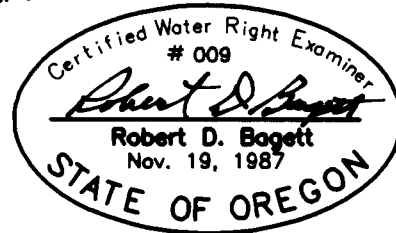

NOTE: THE PREPARATION OF THIS MAP WAS FOR THE PURPOSE OF IDENTIFYING THE LOCATION OF THE PROPOSED WATER RIGHT AND HAS NO INTENT TO PROVIDE DIMENSIONS OR LOCATION OF PROPERTY OWNERSHIP LINES.