

T. 26S., R. 33E., W.M.

FINAL PROOF SURVEY UNDER

APPL. G-10258

PER. G-9324

RECEIVED

AUG 25 2008

WATER RESOURCES DEPT
SALEM, OREGON



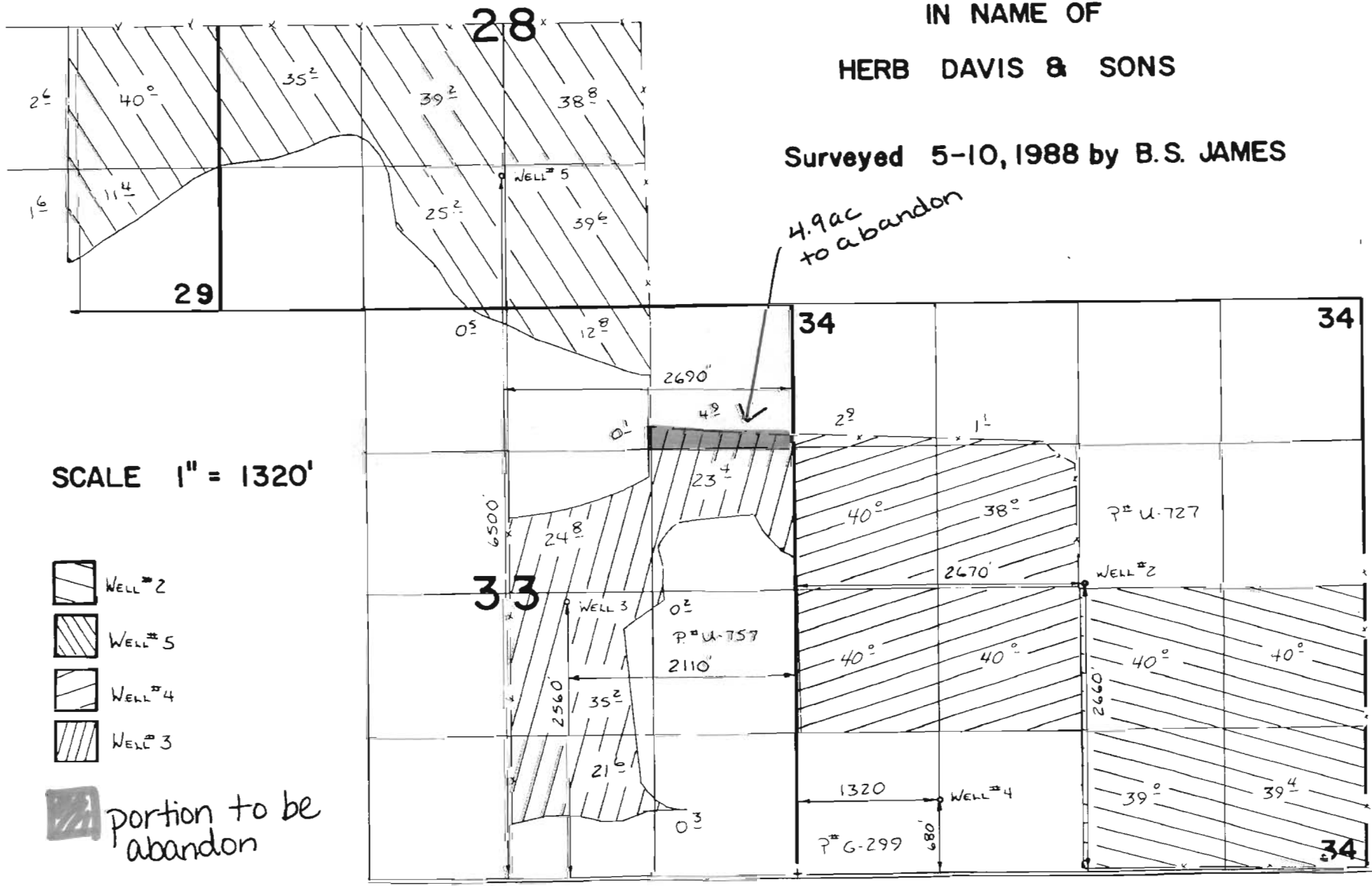

IN NAME OF

HERB DAVIS & SONS

Surveyed 5-10, 1988 by B.S. JAMES



SCALE 1" = 1320'

-  WELL #2
-  WELL #5
-  WELL #4
-  WELL #3
-  portion to be abandon

**T26S, R33E,
SECTION 27 & 34, WM
HARNEY COUNTY, OREGON**

PAGE 1 OF 4











0 1,320
Feet
1" = 1,320'

RECEIVED BY OWRD

AUG 06 2015

SALEM, OR

-  Certificate 28839, to be transferred
-  Certificate 28839, to remain
-  Proposed place of use
-  Township
-  Section
-  Quarter Quarter
-  Taxlot
-  Well

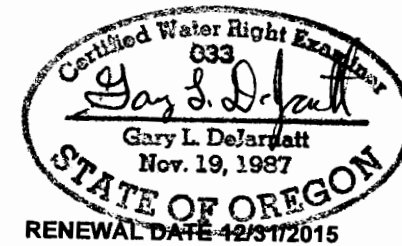

WELL 4:
440' N, 50' W OF
S 1/4 CORNER SEC 27

WELL 3:
40' N, 1,685' W OF
SE CORNER SEC 27

Well 2:
70' N, 90' E OF
C 1/4 COR SEC 34

WELL 1:
325' S, 690' E OF
NW COR SEC 2

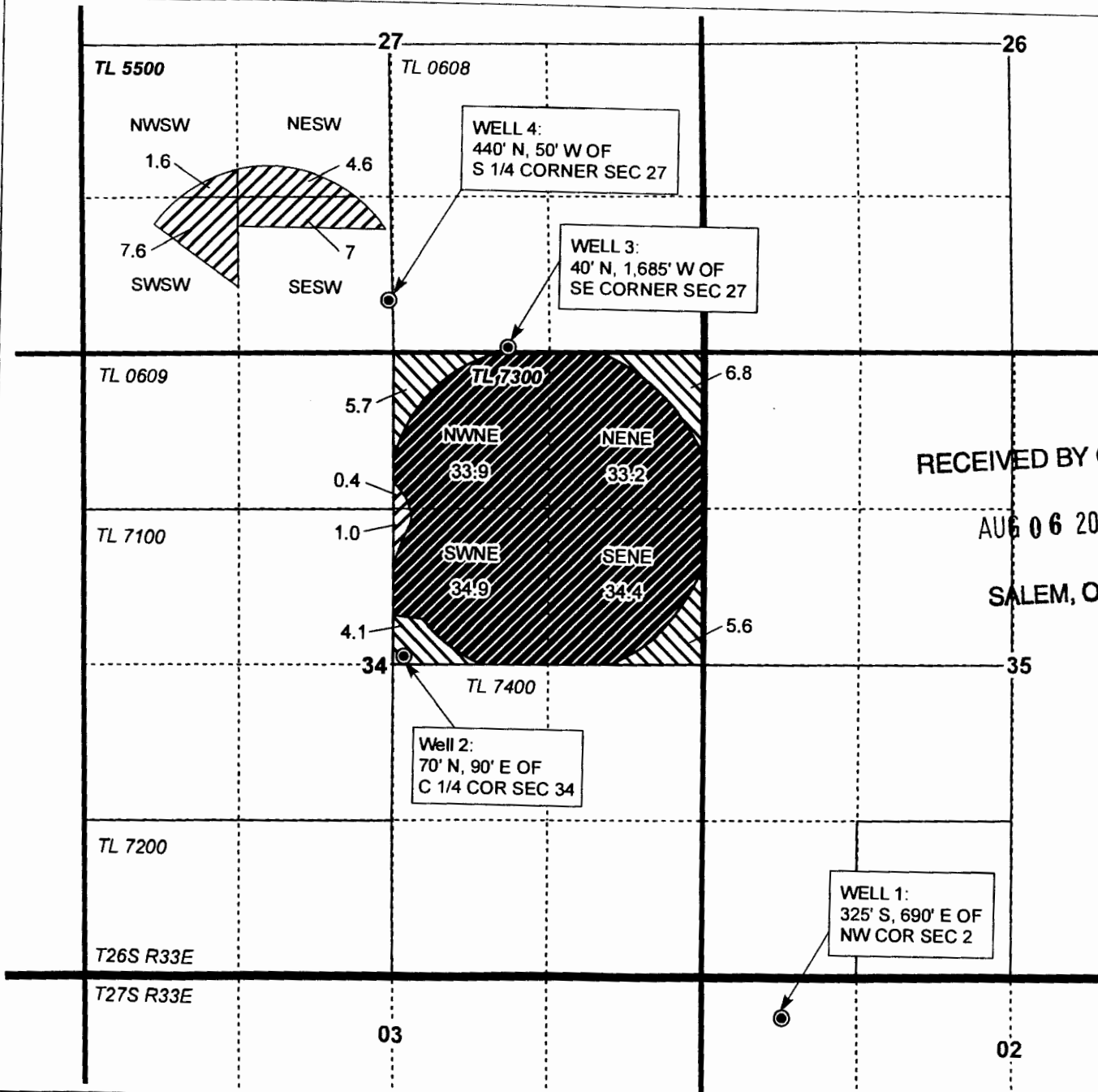

TRANSFER MAP
Phase 3 Farms, Inc

T 12130

NOTE: THIS MAP IS NOT INTENDED TO
PROVIDE LEGAL DIMENSIONS OR LOCATIONS
OF PROPERTY OWNERSHIP LINES.

PROJECT #15036

MAY 7, 2015

WATER RIGHT SERVICES, LLC

PO BOX 1830, BEND, OR 97709

CCB# 197121 www.oregonwater.us

541-389-2837 JOHNSHORT@USA.COM

**T26S, R33E,
SECTION 27 & 34, WM**

HARNEY COUNTY, OREGON

PAGE 2 OF 4

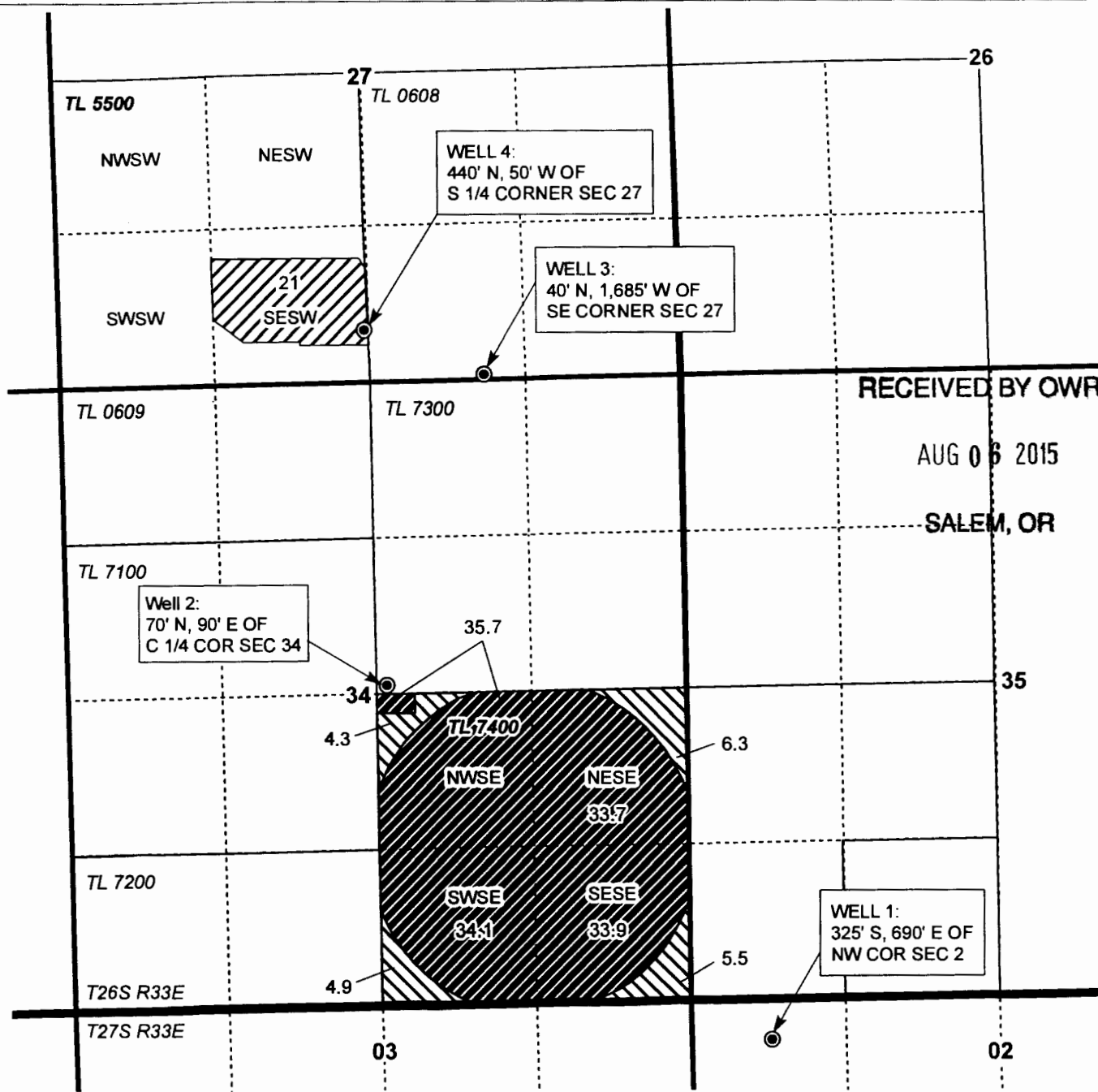

RECEIVED BY OWRD

AUG 06 2015

SALEM, OR



0 1,320 Feet
1" = 1,320'

- Certificate 84831, to be transferred
- Certificate 84831, to remain
- Proposed place of use
- Township
- Section
- Quarter Quarter
- Taxlot

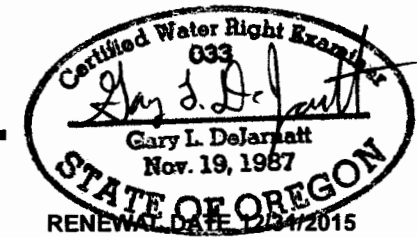

**TRANSFER MAP
Phase 3 Farms, Inc**

1 12130

NOTE: THIS MAP IS NOT INTENDED TO
PROVIDE LEGAL DIMENSIONS OR LOCATIONS
OF PROPERTY OWNERSHIP LINES.

PROJECT #15036

MAY 7, 2015

WATER RIGHT SERVICES, LLC

PO BOX 1830, BEND, OR 97709

CCB# 197121 www.oregonwater.us

541-389-2837 JOHNSHORT@USA.COM

T26S, R33E,
SECTION 27, 34 & 35, WM

RECEIVED BY OWRD

HARNEY COUNTY, OREGON

AUG 06 2015









PAGE 3 OF 4

SALEM, OR



0 1,320 Feet

1" = 1,320'

-  Certificate 27019, to be transferred
-  Certificate 27019, to remain
-  Proposed place of use
-  Water rights removed in pending transfer
-  Township
-  Section
-  Quarter Quarter
-  Taxlot
-  Well

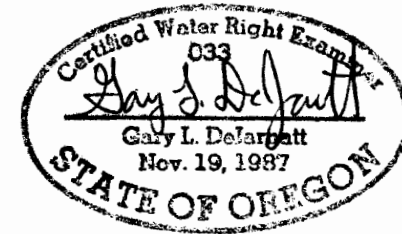

RENEWAL DATE 12/31/2015

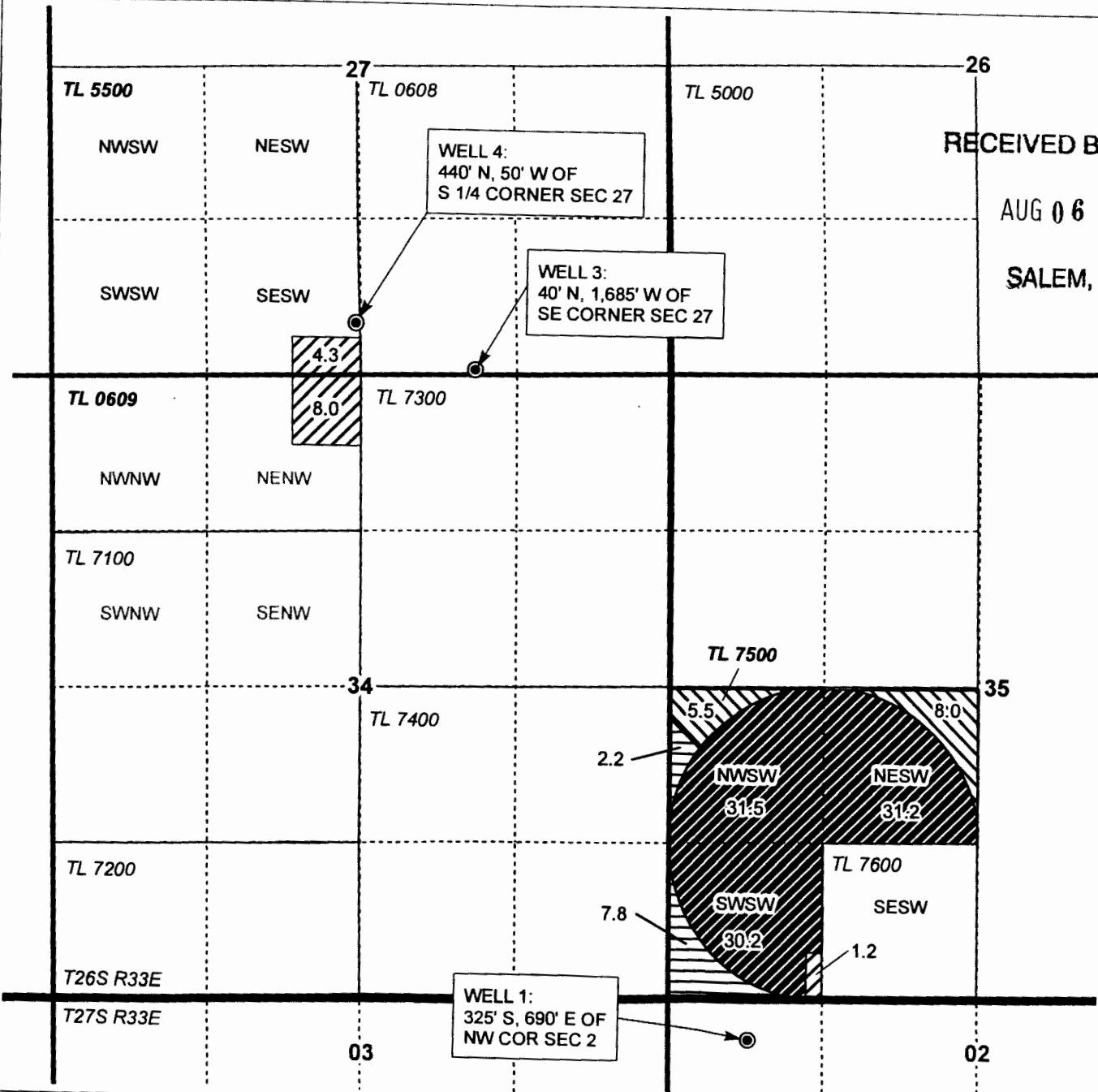

TRANSFER MAP
Phase 3 Farms, Inc

T 12138

NOTE: THIS MAP IS NOT INTENDED TO
PROVIDE LEGAL DIMENSIONS OR LOCATIONS
OF PROPERTY OWNERSHIP LINES.

PROJECT #15036

MAY 7, 2015

WATER RIGHT SERVICES, LLC

PO BOX 1830, BEND, OR 97709

CCB# 197121 www.oregonwater.us

541-389-2837 JOHNSHORT@USA.COM

**T26S, R33E,
SECTION 34 & 35, WM**

RECEIVED BY OWRD HARNEY COUNTY, OREGON

AUG 06 2015 PAGE 4 OF 4

SALEM, OR

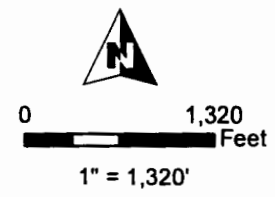

- Certificate 46391, to be transferred
- Certificate 46391, to remain
- Proposed place of use
- Township
- Section
- Quarter Quarter
- Taxlot
- Well

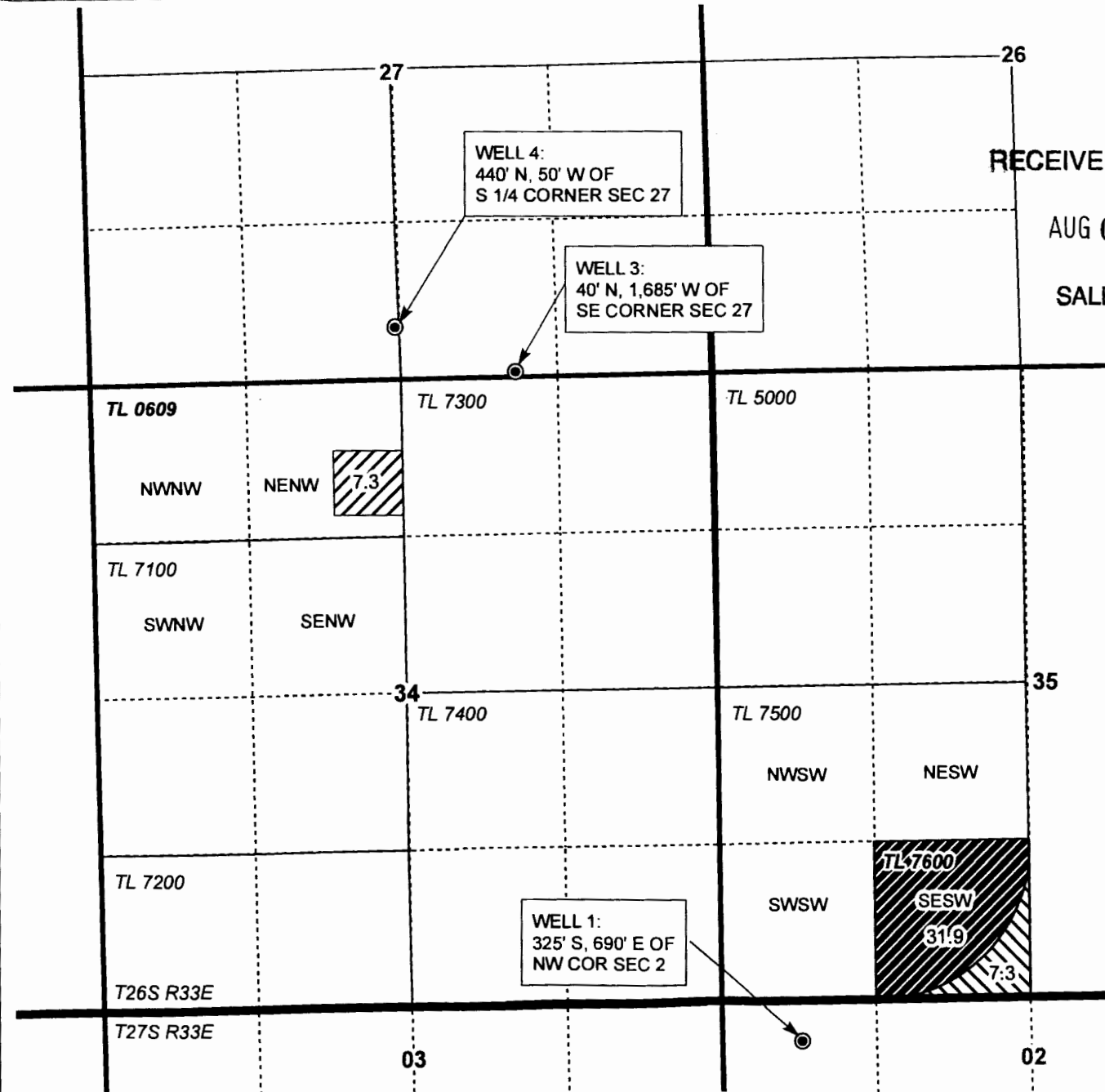
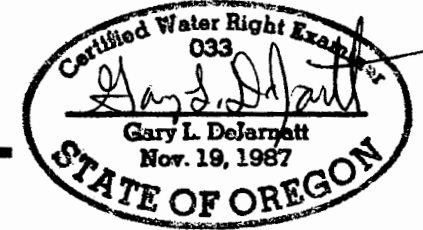

TRANSFER MAP
Phase 3 Farms, Inc

1 12130

NOTE: THIS MAP IS NOT INTENDED TO PROVIDE LEGAL DIMENSIONS OR LOCATIONS OF PROPERTY OWNERSHIP LINES.

PROJECT #15036

MAY 7, 2015

WATER RIGHT SERVICES, LLC
PO BOX 1830, BEND, OR 97709
CCB# 197121 www.oregonwater.us
541-389-2837 JOHNSHORT@USA.COM