

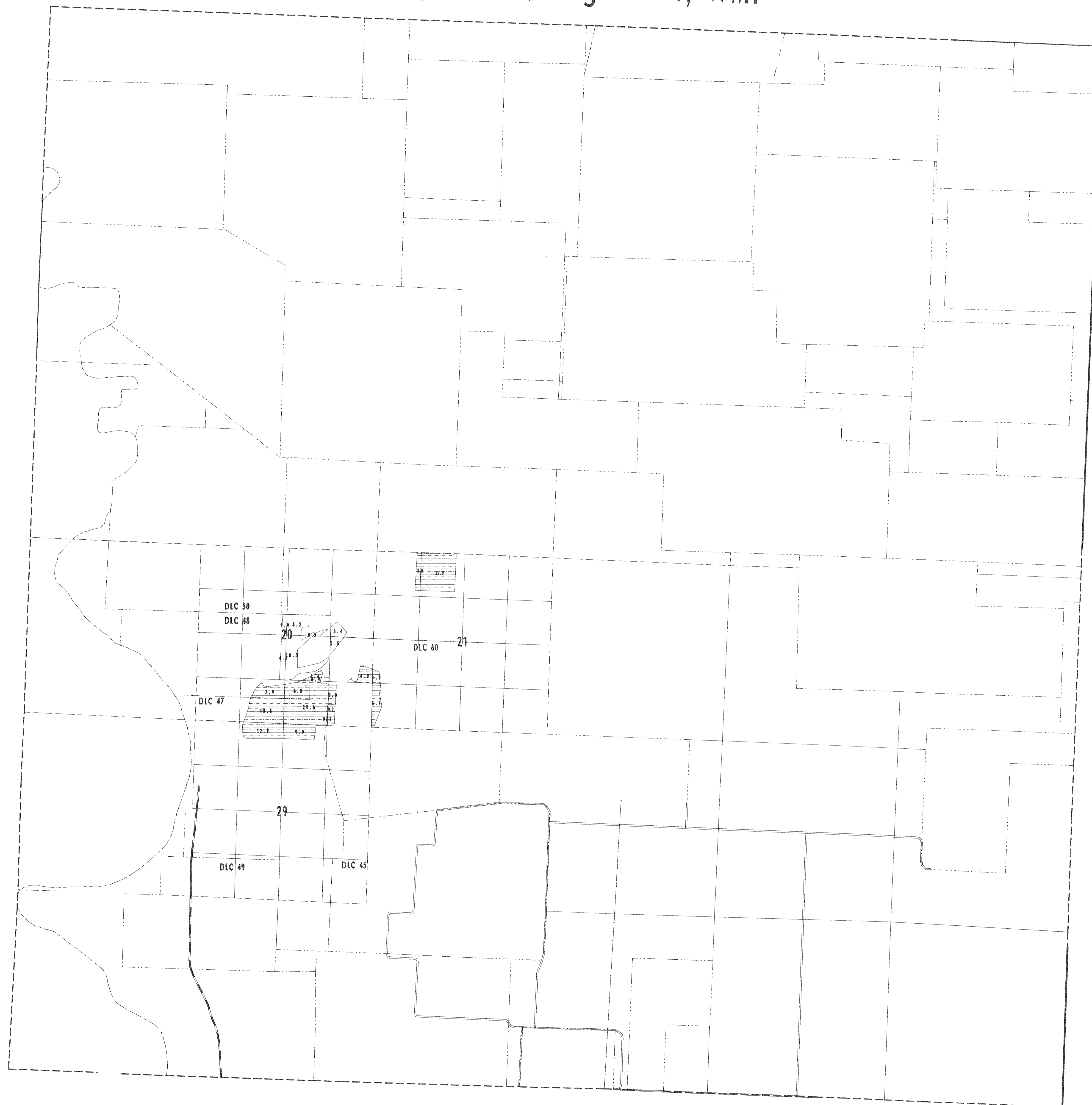







Twp. 12 S., Rng. 4 W., WM.



- LEGEND
-  Permit 50921
  -  Permit 37877
  -  Permit 42759
  -  Permit 43710
  -  Permit 45980
  -  Certificate 51599
  -  Certificate 62148
  -  Certificate 02281



SCALE 1" = 1320'

**FINAL PROOF SURVEY**

UNDER

Application 49527	Permit 37877
55400	42759
57947	43710
58932	45980
68824	50921

IN NAME OF  
**MUDDY CREEKS IRRIGATION PROJECT**



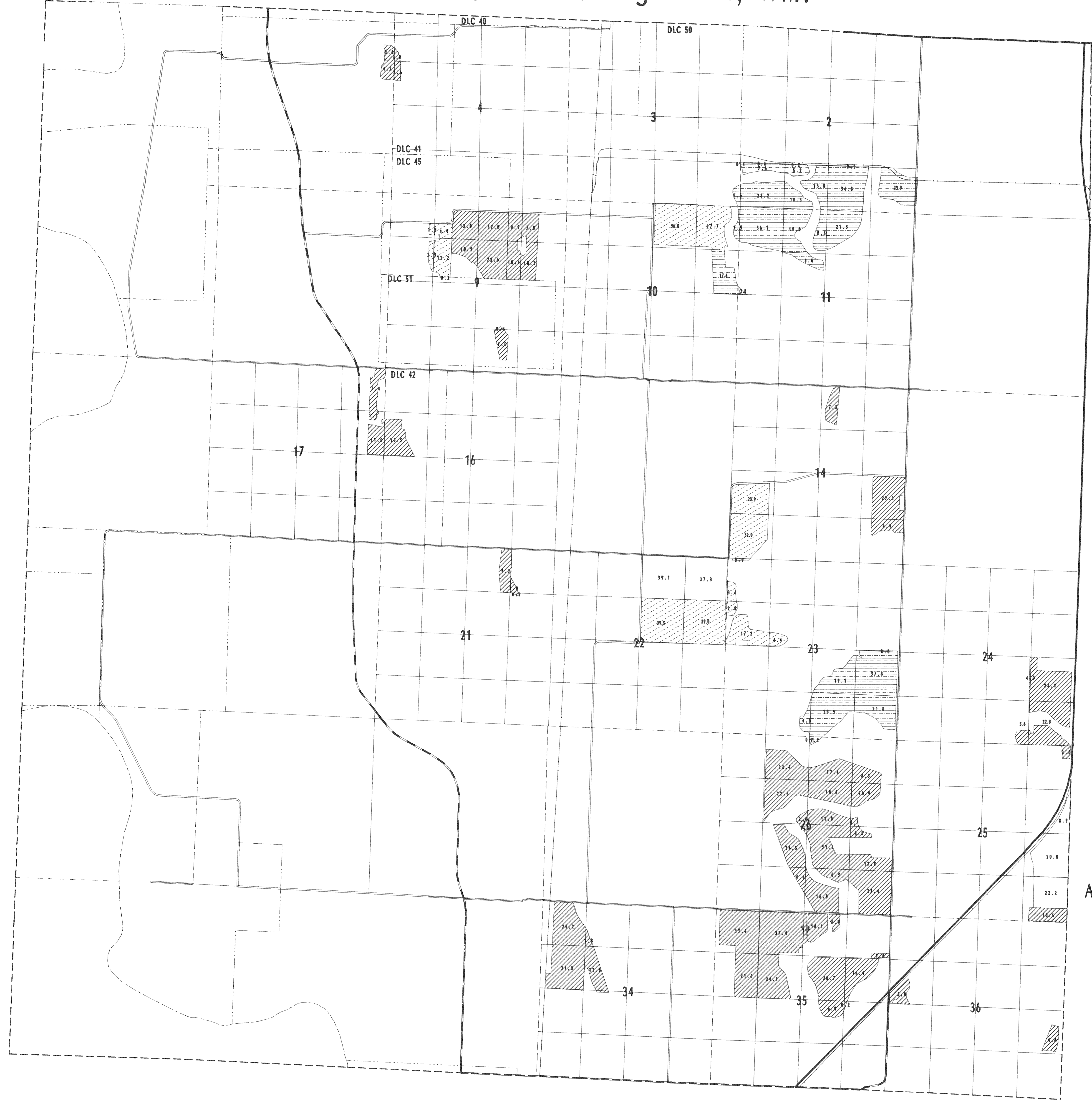

Surveyed 1993 By R.W.Klassen

User: rpk  
 Date/Time: 4/11/1994 2:47 PM  
 Plot: /arcdata/isor2/ar/lans/m124k-1p

# Twp. 14 S., Rng. 4 W., WM.

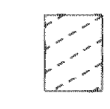

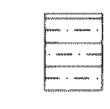
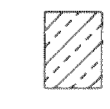
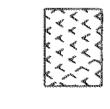
**LEGEND**

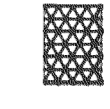
-  Permit 55921
-  Permit 37877
-  Permit 42759
-  Permit 43710
-  Permit 45980
-  Certificate 51589
-  Certificate 62148
-  Certificate 62281

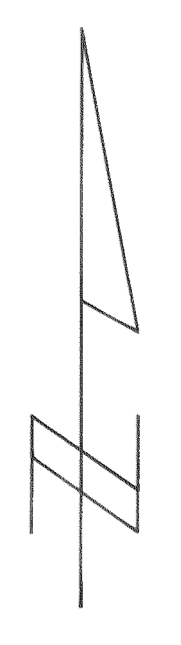

SCALE 1" = 1320'

## FINAL PROOF SURVEY UNDER

Application 49527	Permit 37877
55400	42759
57947	43710
58932	45980
68824	50921

IN NAME OF  
**MUDDY CREEKS IRRIGATION PROJECT**







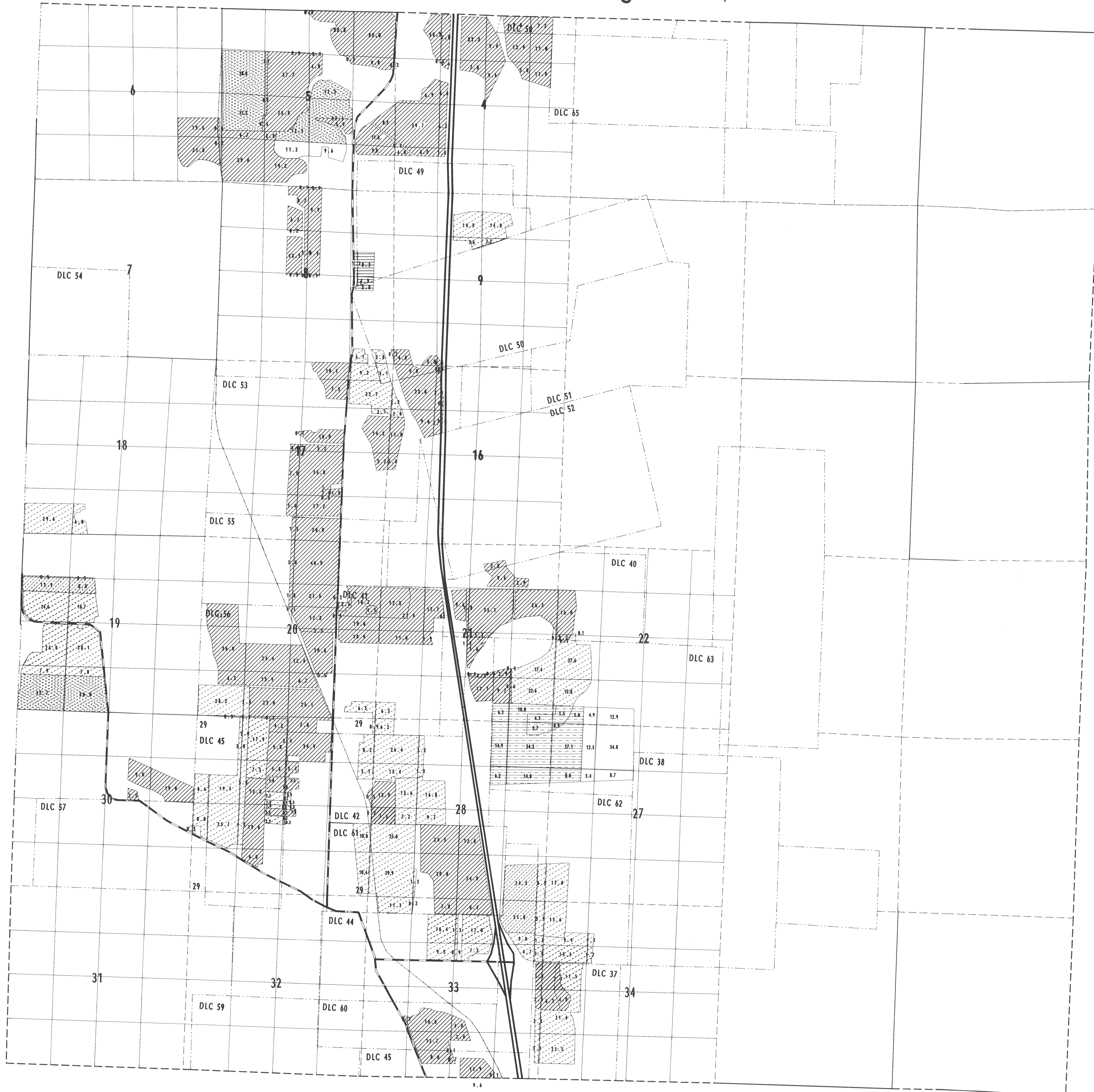

Surveyed 1993 By R.W.Klassen

Usernames: rquincy\log\_11\05 WM  
 Profiles: /prodstate/arcuser/llans/m14s4w-fp

# Twp. 16 S., Rng. 3 W., WM.



LEGEND

-  Permit 50921
-  Permit 37877
-  Permit 42759
-  Permit 43710
-  Permit 45980
-  Certificate 51599
-  Certificate 62148
-  Certificate 62281



SCALE 1" = 1320'

## FINAL PROOF SURVEY

UNDER

Application 49527	Permit 37877
55400	42759
57947	43710
58932	45980
68824	50921

IN NAME OF  
**MUDDY CREEKS IRRIGATION PROJECT**

Surveyed 1993 By R.W.Klassen

This map is not intended to provide legal dimensions or locations of property ownership lines.



T14S R4W, W.M.

RECEIVED BY OWRD

OCT 26 2015

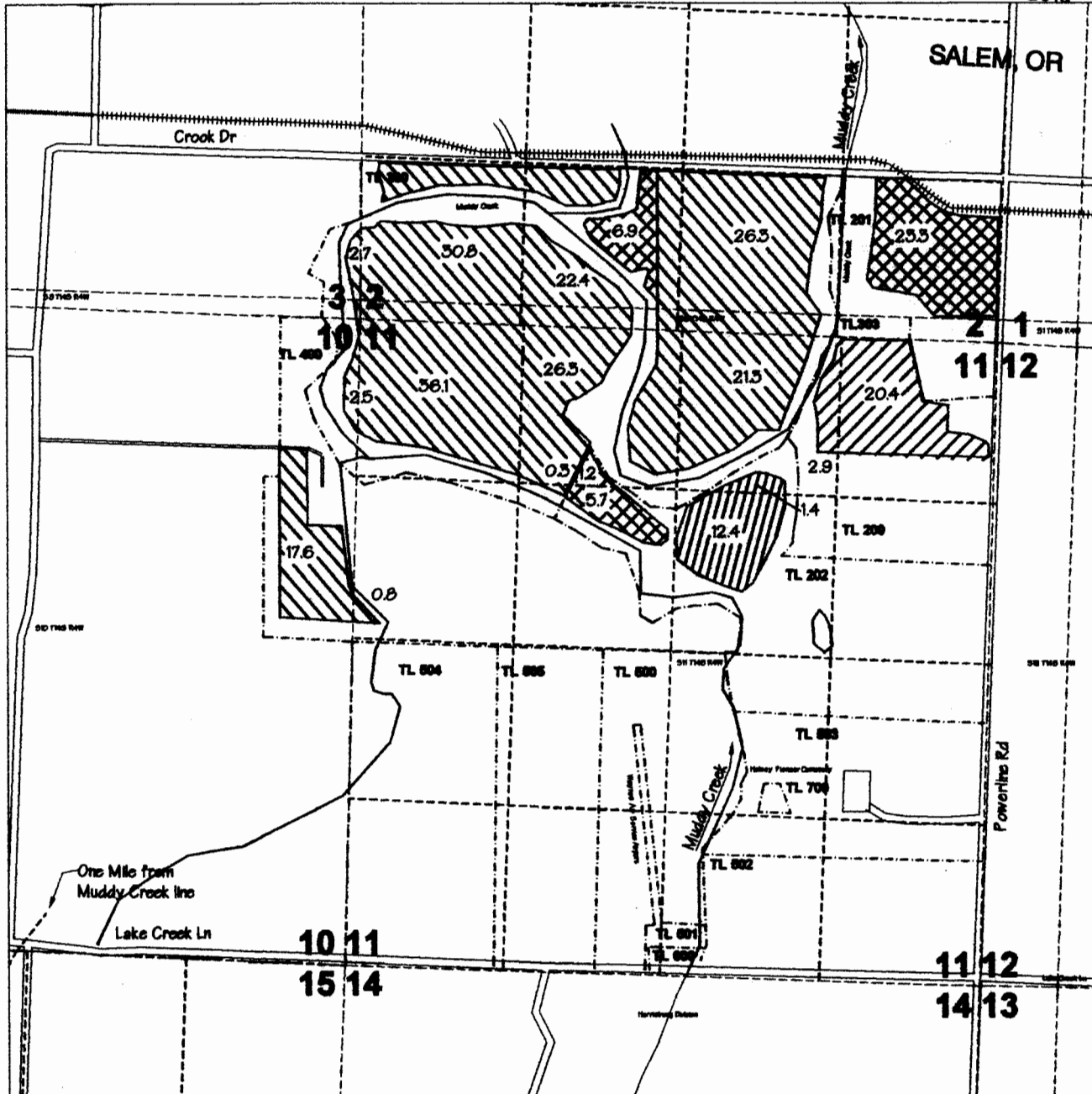
**Transfer T-**  
 In the name of  
**Muddy Creeks**  
**Irrigation District**  
 Certificate # 75255



From:   
 To:   
 Remaining: 

Prepared by  
 Walter L. Trimmer  
 CWRE #332  
 Trimmer Engineering Inc.  
 3924 NW Walnut Place  
 Corvallis, OR 97330  
 541-754-2819

Scale 1" = 1320'  
 September 28, 2015  
 Layout: Zehr  
 File: Muddy\_Crks.dwg  
 Based on USGS Halsey Quad  
**DWG 1 of 1**



Expires 6/30/2016

T 12194