

FINAL PROOF SURVEY
UNDER
APPLICATION T-6863
PERMIT SPECIAL ORDER VOL 67, PG 449

IN NAME OF
LUCE-LONG DITCH COMPANY

BY
ROBERT D. BAGETT
217 N. CANYON BLVD.
JOHN DAY, OR. 97846

DATE SURVEYED
MAY 30, 2012
MAP REVISED
DECEMBER 4, 2013



Scale 1"=400'
SHEET 2 OF 2

T13S

R30E
R31E

25

30

29

20

AREA OF NON USE
C27922 - 1.9 AC.

AREA OF NON USE
C27922 - 6.1 AC.

AREA OF NON USE
C24879 - 1.0 AC.

POU Transfer:
0.4 AC. C-50137 from
SE1/4SE1/4 Sec. 21.

AREA OF NON USE
C35330 - 4.0 AC.

AREA OF NON USE
C25927 - 5.2 AC.

AREA OF NON USE
C25927 - 17.6 AC.

AREA OF NON USE
C25927 - 8.1 AC.

NOTE:
IT IS RECOMMENDED THAT THE 2.6 AC. THAT IS
BRACKETED FROM LUCE LONG DITCH UNDERGO
TRANSFER IN P.O.D. FROM ENTERPRISE DITCH
TO LUCE LONG DITCH.

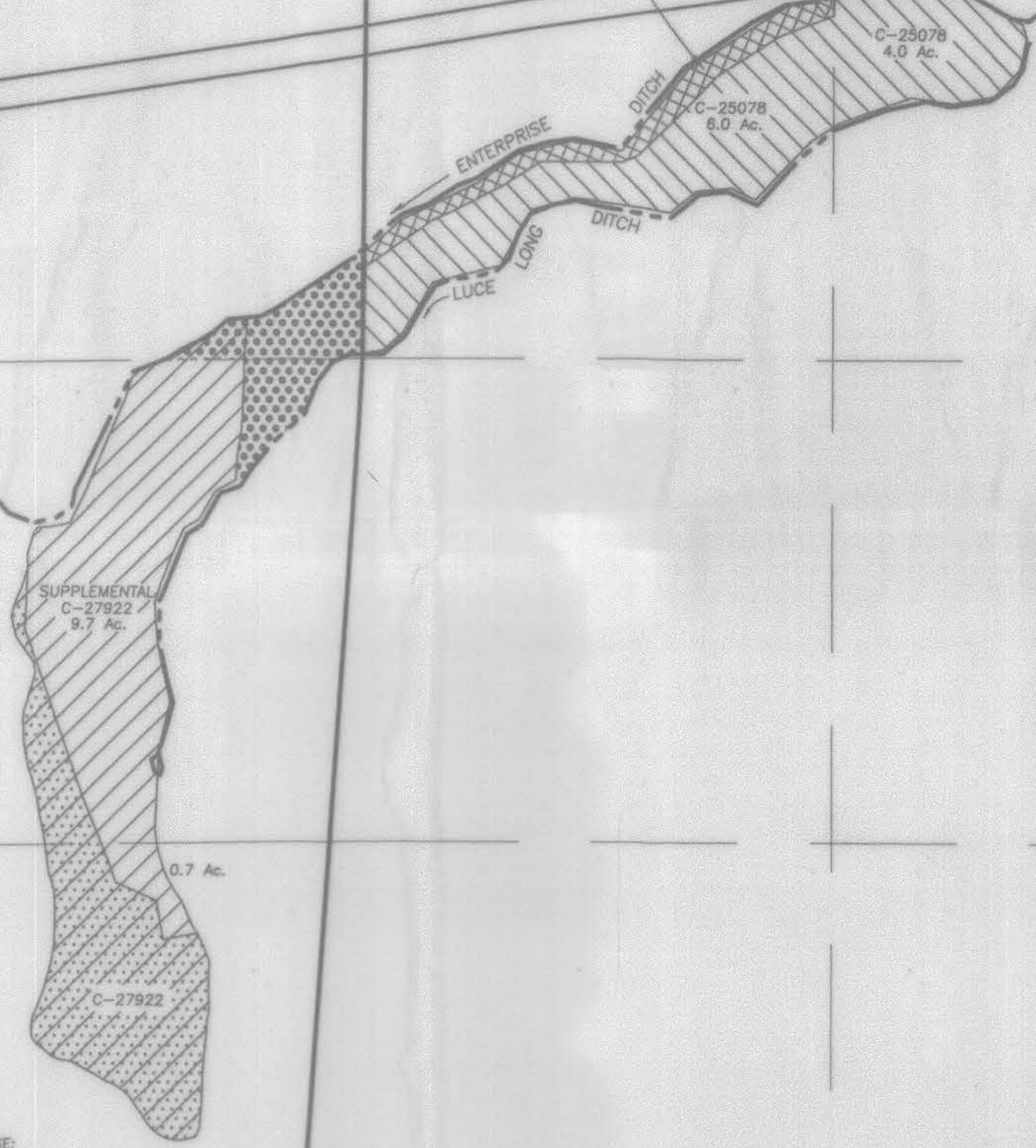

COBU MAP # 694

RECEIVED BY OWRD
DEC 23 2013
SALEM, OR