

CLAIM OF BENEFICIAL USE MAP

FOR: MARK & KELLY BENNETT
 BY: NATHAN R. REED, CWRE
 T28S, R7W, W.M. SECTION 1 DLC 41
 APPLICATION NO. S-88000
 PERMIT NO. S-54893

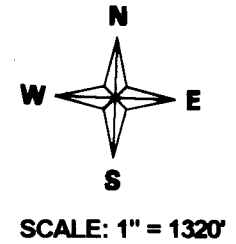

DATE SURVEYED: AUGUST 15, 2015

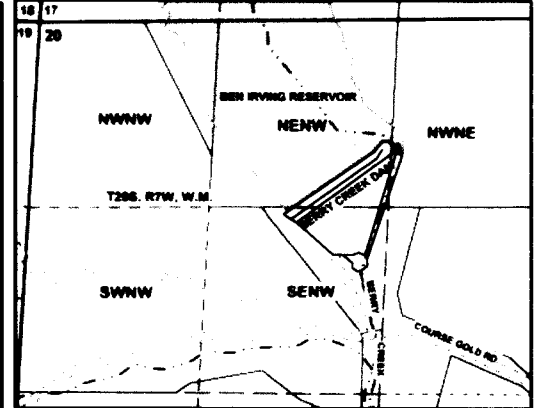
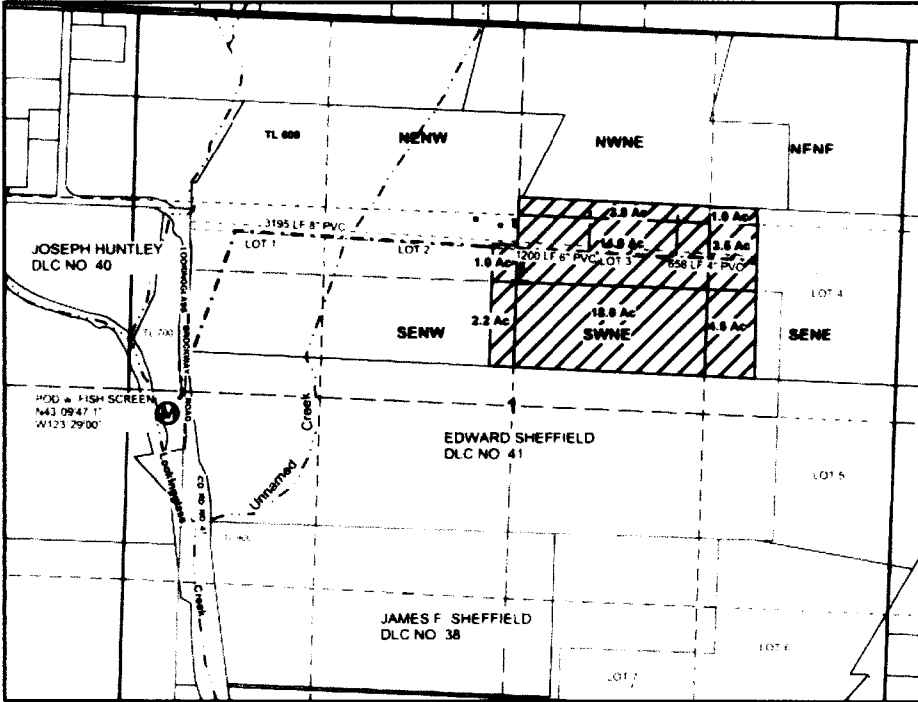

POD IS LOCATED 944 FEET NORTH AND 266 FEET WEST FROM THE C1/4 CORNER, SECTION 20.

POD IS LOCATED 2720 FEET SOUTH AND 180 FEET EAST FROM NW CORNER, SECTION 1.

Legend

○	POD	-----	Stream	□	Township
▼	Pump	■	Structures	□	DLC
⊙	Meter	—+—	Drive/Road	□	Section
-----	Main Line	→	Flow Arrow	-----	Quarter
- - - - -	Lateral Line	-----	Reservoir	-----	Sixteenth
-----		□	Gov Lot	□	Parcels

RECEIVED BY OWRD

FEB 22 2016

SALEM, OR

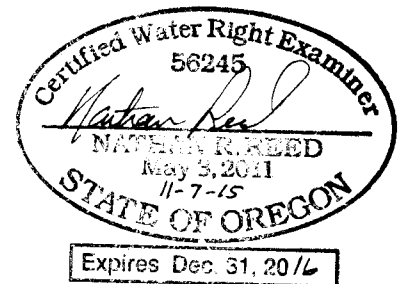

MAP PREPARED FOR:
 MARK & KELLY BENNETT
 8382 LOOKINGGLASS ROAD
 ROSEBURG, OR 97471

MAP PREPARED BY:
 NATHAN R. REED, P.E., CWRE
 1113 SE CASS AV
 ROSEBURG, OR 97470

THE PURPOSE OF THIS MAP IS TO IDENTIFY THE LOCATION OF THE WATER RIGHT. IT IS NOT INTENDED TO PROVIDE INFORMATION RELATIVE TO THE LOCATION OF PROPERTY OWNERSHIP BOUNDARY LINES.