

work copy

RECEIVED BY OWRO

Claim of Beneficial Use

Permit G-16619, Application G-16865

MAR 04 2016

Water Right in the Name of City of Walla Walla
Umatilla County
Township 6 North, Range 38 East (W.M.)

SALEM, OR

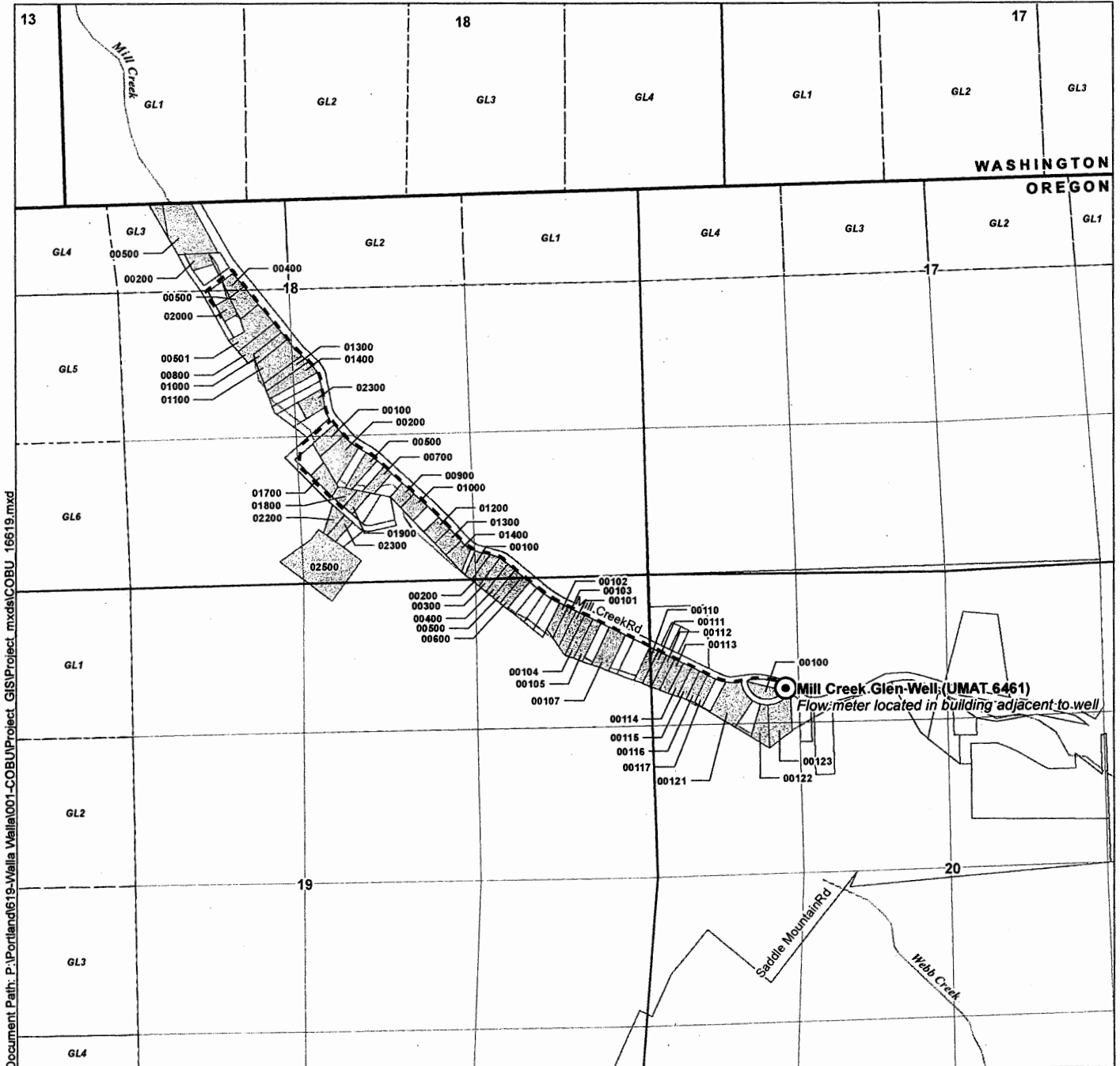

Document Path: P:\Portland\619-Walla Walla\001-COBUN\project_GIS\Project.mxd\COBU_16619.mxd

LEGEND

- Point of Appropriation (POA)
- Mainline
- Place of Use (POU)
- Tax Lots
- Government Lot (GL)
- Watercourse
- Waterbody

POA Location Description

Mill Creek Glen Well
Located 975 feet South and 1,165 feet East from the NW corner of Section 20, Township 6 North, Range 38 East (W.M.)

Certified Water Rights Examiner Stamp

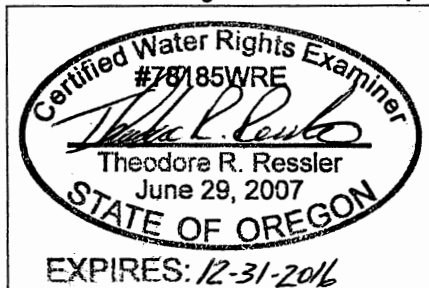

Disclaimer

This map was prepared for the purpose of identifying the location of a water right only and it is not intended to provide legal dimensions or location of property ownership lines.

Map Notes

Date: December 8, 2015
Data Sources: BLM, Umatilla Co., Walla Walla Co., USGS
Prepared By: GSI Water Solutions, Inc.

