

FINAL PROOF MAP

FOR



T-6589 PERMITS 12000, 12001, 24144, 26136
& 7400

WARREN TAYLOR

T2N, R31E. WM

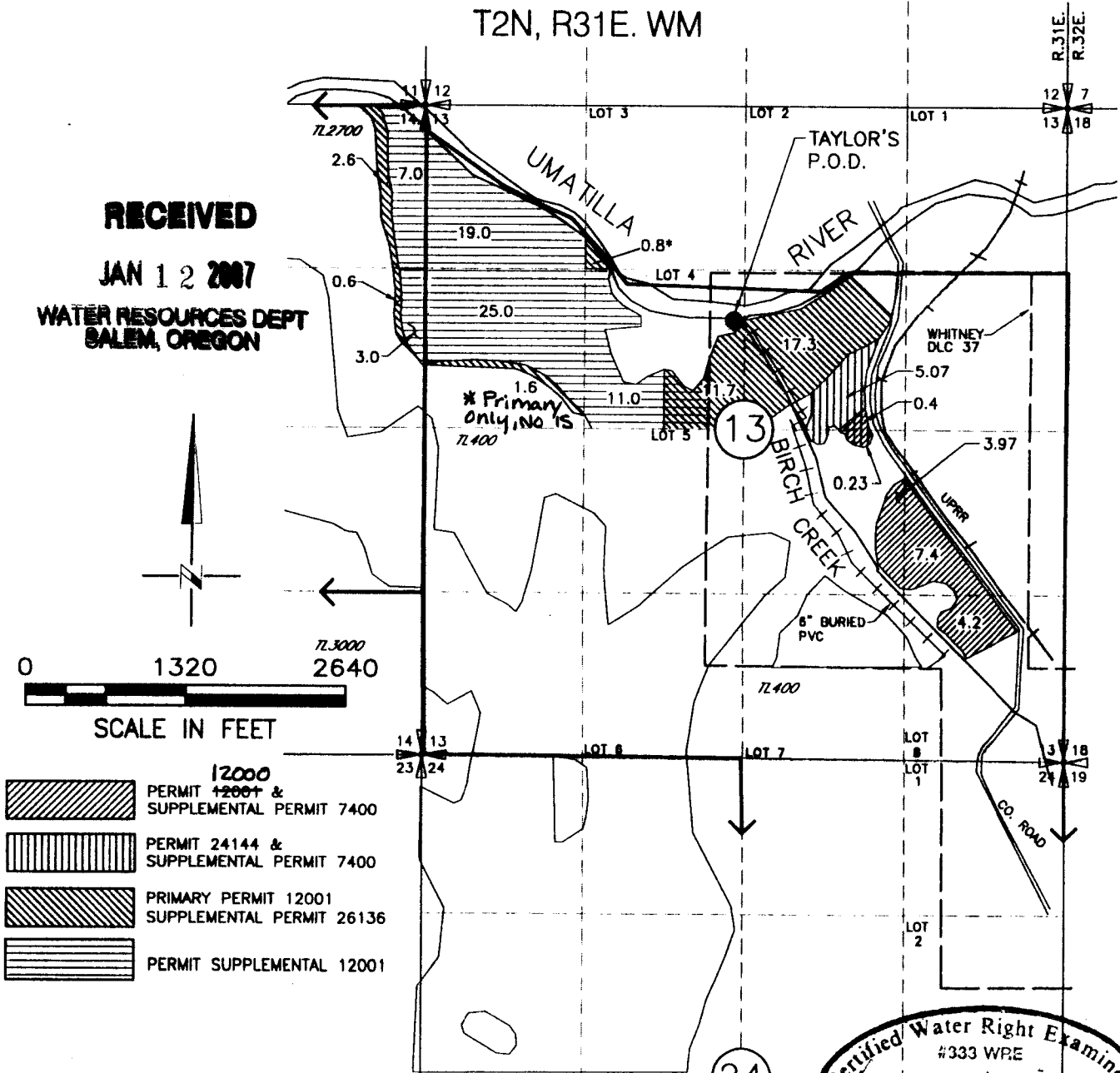
RECEIVED
JAN 12 2007
WATER RESOURCES DEPT
SALEM, OREGON

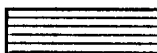

-  PERMIT 12001 & SUPPLEMENTAL PERMIT 7400
-  PERMIT 24144 & SUPPLEMENTAL PERMIT 7400
-  PRIMARY PERMIT 12001 SUPPLEMENTAL PERMIT 26136
-  PERMIT SUPPLEMENTAL 12001

* 0.2 ACRES OF THE 0.8 ACRES IN THE NE 1/4, NW 1/4 SECTION 13 DESCRIBED IN PERMIT 12001 IS DESCRIBED IN SUPPLEMENTAL PERMIT 26136

POINT OF DIVERSION (P.O.D.)
AT THE CONFLUENCE OF THE UMATILLA RIVER AND BIRCH CREEK: 1750' S AND 2730' W FROM N.E. CORNER OF SECTION 13

FISH SCREENS AND FLOW METER ARE LOCATED AT TAYLOR'S P.O.D.

* This map was modified by OWRD - Jgs 6-15-16

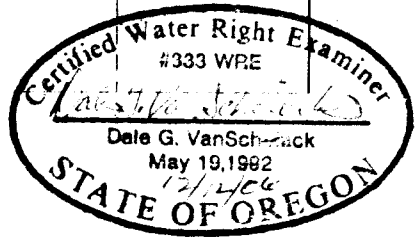

DRAWING: H:\CAD\AG\3522\308\3522308\3522080CFP.dwg
PRINTED BY: Roger Willard on 12/12/06 03:29 PM

NOTE: THE PURPOSE OF THIS MAP IS TO IDENTIFY THE APPROXIMATE LOCATION OF THE WATER RIGHT. IT IS NOT INTENDED TO PROVIDE INFORMATION RELATIVE TO THE LOCATION OF PROPERTY OWNERSHIP BOUNDARY LINES.

