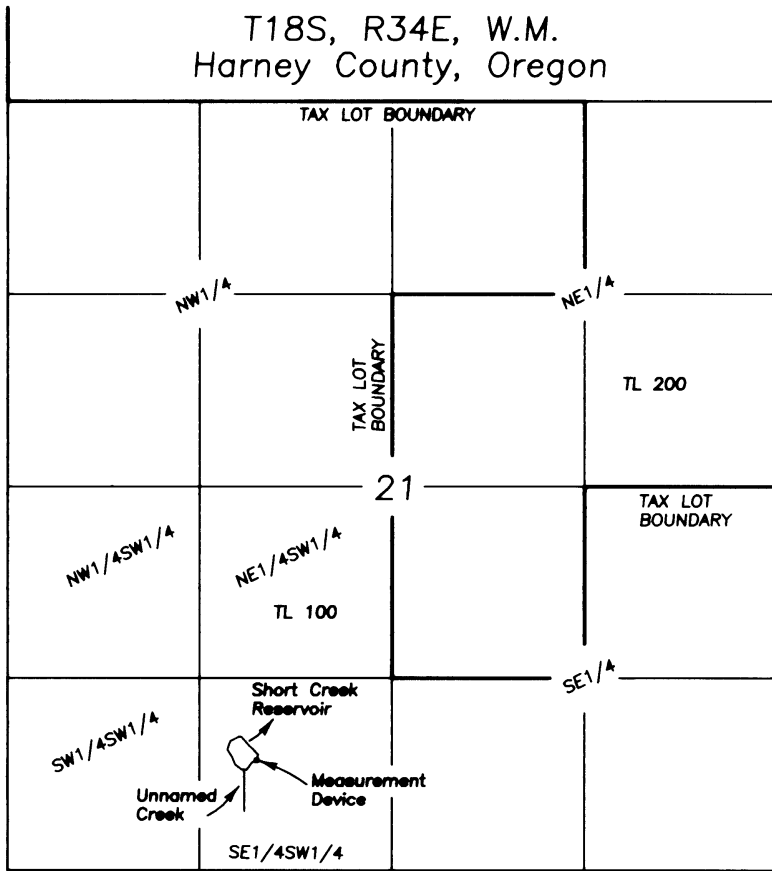

EXHIBIT B



SCALE 1"=1320'

Outlet is located 750' North & 1700' East of the SW corner of Section 21.
 Measuring device is located 12' North of the Outlet

**FINAL PROOF SURVEY
 CLAIM OF BENEFICIAL USE
 SHORT CREEK RESERVOIR**

LEGEND

Application No. R-46193
 Permit No. R-7892
 Priority 7/7/1969

A portion of Tax Lot
 18-34 TL100

NOTE: Tax Lot 100 is owned by the BLM and is more than 17,000 acres. Therefore only a small portion of the tax lot boundary can be shown.

NOTE: The preparation of this map was for the purpose of identifying the location of the proposed water right and has no intent to provide dimensions or location of property ownership lines.

For

Bureau of Land Management

August 4, 2016

Prepared by

Cornerstone Surveying, Inc

P.O. BOX 33
 JOHN DAY, OR. 97845
 (541)575-1813

cornerstonesurvey@centurytel.net

RECEIVED BY OWRD

AUG 29 2016

SALEM, OR

