

**FINAL PROOF SURVEY MAP
IN THE NAME OF WILLIAM J. PULLEN**

SECTIONS 20 & 21, T 28 S, R 14 W, W.M.

APPLICATION R - 69508
APPLICATION 69509
APPLICATION G - 11761

PERMIT R - 11447
PERMIT 51426
PERMIT G - 11447

RECEIVED
SEP 18 1988
WATER RESOURCE BUREAU
SALEM, OREGON

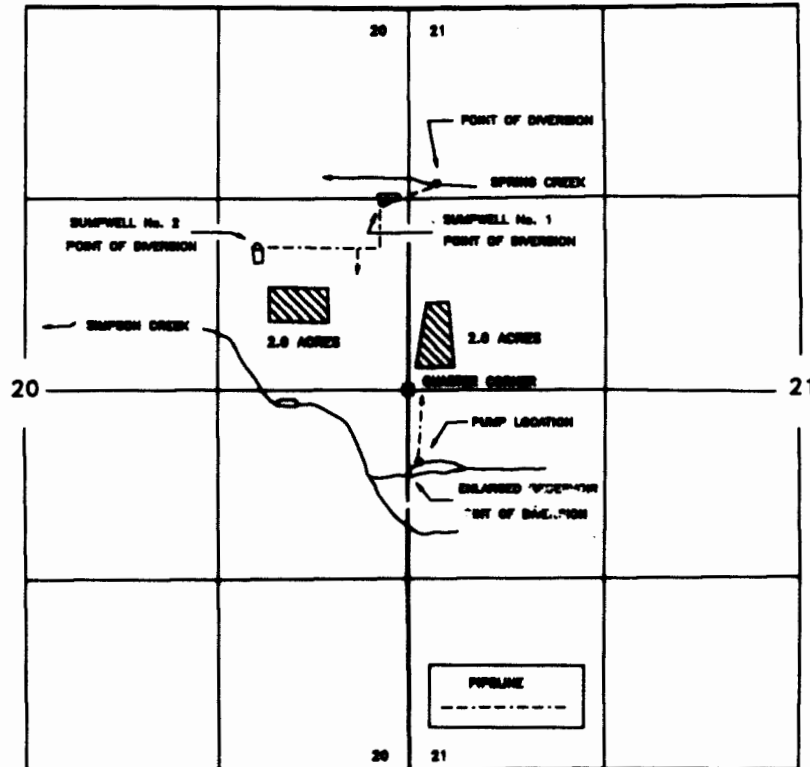

THE POINTS OF DIVERSION ARE LOCATED AS FOLLOWS:

SOURCE	NORTH/SOUTH	EAST/WEST	SECTION	1/4 1/4
SPRING CREEK	1430 FEET NORTH	170 FEET EAST	21	NW1/4 NW1/4
SIMPSON CREEK	580 FEET SOUTH	20 FEET EAST	21	NW1/4 SW1/4
SUMPWELL No. 1	1320 FEET NORTH	150 FEET WEST	20	SE1/4 NE1/4
SUMPWELL No. 2	980 FEET NORTH	1040 FEET WEST	20	SE1/4 NE1/4

ALL FROM THE EAST QUARTER CORNER OF SECTION 20, TOWNSHIP 28 SOUTH, RANGE 14 WEST, W.M.;
AND WITHIN SECTIONS 20 & 21, TOWNSHIP 28 SOUTH, RANGE 14 WEST, W.M., COOS COUNTY.

THE PURPOSE OF THIS MAP IS TO IDENTIFY THE LOCATION OF THE WATER RIGHT.
IT IS NOT INTENDED TO PROVIDE INFORMATION RELATIVE TO THE LOCATION OF
PROPERTY OWNERSHIP BOUNDARY LINES.

FINAL PROOF SURVEY MAP
IN THE NAME OF WILLIAM J. PULLEN

RECEIVED
NATURAL RESOURCES DEPT
EPA
SALAS
MAY 19 1997

SECTIONS 20 & 21, T 28 S, R 14 W, W.M.

APPLICATION R - 69508
APPLICATION 69509
APPLICATION G - 11761

PERMIT R - 11447
PERMIT 51426
PERMIT G - 11447

N
1 INCH = 1320 FEET

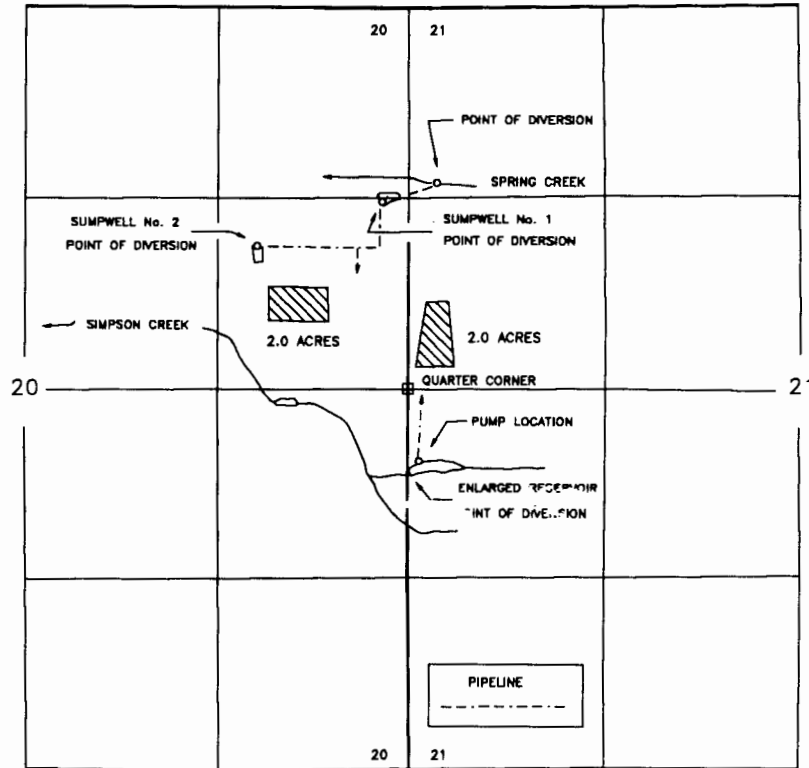

William J. Pullen

THE POINTS OF DIVERSION ARE LOCATED AS FOLLOWS:

SOURCE	NORTH/SOUTH	EAST/WEST	SECTION	¼ ¼
SPRING CREEK	1420 FEET NORTH	170 FEET EAST	21	NW¼ NW¼
SIMPSON CREEK	580 FEET SOUTH	20 FEET EAST	21	NW¼ SW¼
SUMPWELL No. 1	1320 FEET NORTH	150 FEET WEST	20	SE¼ NE¼
SUMPWELL No. 2	980 FEET NORTH	1040 FEET WEST	20	SE¼ NE¼

ALL FROM THE EAST QUARTER CORNER OF SECTION 20, TOWNSHIP 28 SOUTH, RANGE 14 WEST, W.M.;
AND WITHIN SECTIONS 20 & 21, TOWNSHIP 28 SOUTH, RANGE 14 WEST, W.M., COOS COUNTY.

THE PURPOSE OF THIS MAP IS TO IDENTIFY THE LOCATION OF THE WATER RIGHT.
IT IS NOT INTENDED TO PROVIDE INFORMATION RELATIVE TO THE LOCATION OF
PROPERTY OWNERSHIP BOUNDARY LINES.