

FINAL PROOF SURVEY MAP  
 IN THE NAME OF WILLIAM J. PULLEN

SECTIONS 20 & 21, T 28 S, R 14 W, W.M.

APPLICATION R - 69508  
 APPLICATION 69509  
 APPLICATION G - 11761

PERMIT R - 11447  
 PERMIT 51426  
 PERMIT G - 11447

RECEIVED  
 SEP 18 1988  
 WATER RESOURCE DEPT.  
 SALEM, OREGON

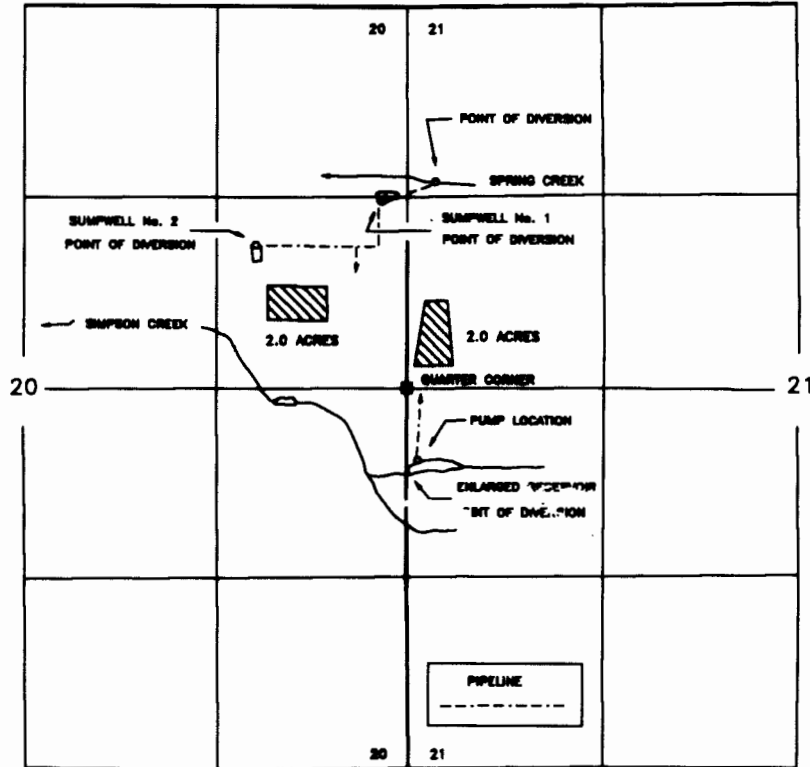

THE POINTS OF DIVERSION ARE LOCATED AS FOLLOWS:

SOURCE	NORTH/SOUTH	EAST/WEST	SECTION	¼ ¼
SPRING CREEK	1420 FEET NORTH	170 FEET EAST	21	NW¼ NW¼
SIMPSON CREEK	580 FEET SOUTH	20 FEET EAST	21	NW¼ SW¼
SUMPWELL No. 1	1320 FEET NORTH	150 FEET WEST	20	SE¼ NE¼
SUMPWELL No. 2	980 FEET NORTH	1040 FEET WEST	20	SE¼ NE¼

ALL FROM THE EAST QUARTER CORNER OF SECTION 20, TOWNSHIP 28 SOUTH, RANGE 14 WEST, W.M.;  
 AND WITHIN SECTIONS 20 & 21, TOWNSHIP 28 SOUTH, RANGE 14 WEST, W.M., COOS COUNTY.

THE PURPOSE OF THIS MAP IS TO IDENTIFY THE LOCATION OF THE WATER RIGHT.  
 IT IS NOT INTENDED TO PROVIDE INFORMATION RELATIVE TO THE LOCATION OF  
 PROPERTY OWNERSHIP BOUNDARY LINES.

FINAL PROOF SURVEY MAP  
 IN THE NAME OF WILLIAM J. PULLEN

RECEIVED  
 SEP 1 1985  
 WATER RESOURCES DEPT  
 SALEM, OREGON

SECTIONS 20 & 21, T 28 S, R 14 W, W.M.

APPLICATION R - 69508  
 APPLICATION 69509  
 APPLICATION G - 11761

PERMIT R - 11447  
 PERMIT 51426  
 PERMIT G - 11447

1 INCH = 1320 FEET

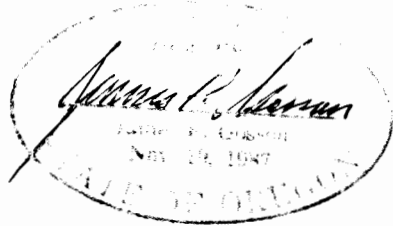
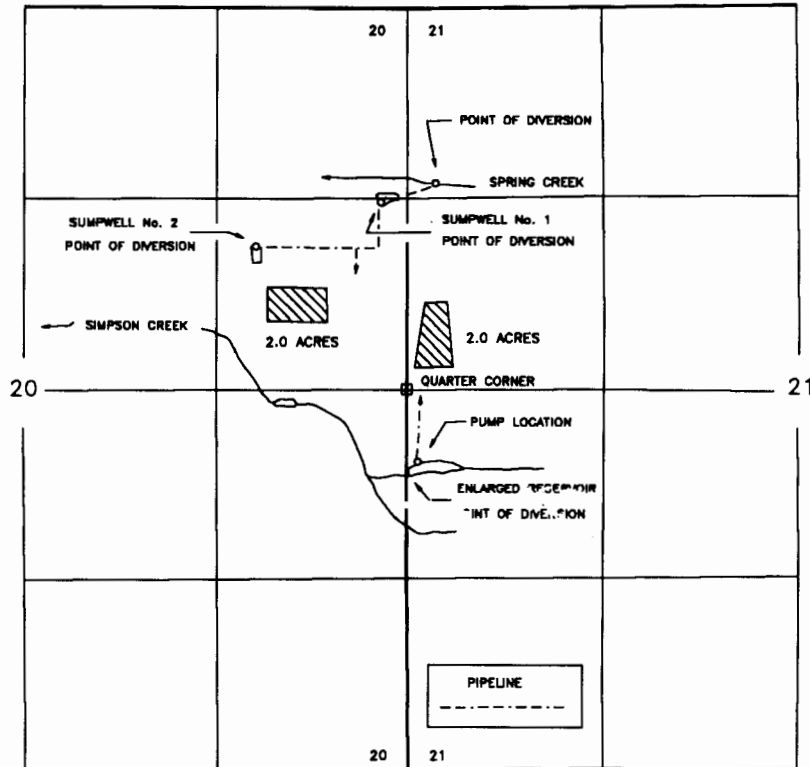

THE POINTS OF DIVERSION ARE LOCATED AS FOLLOWS:

SOURCE	NORTH/SOUTH	EAST/WEST	SECTION	¼ ¼
SPRING CREEK	1420 FEET NORTH	170 FEET EAST	21	NW¼ NW¼
SIMPSON CREEK	580 FEET SOUTH	20 FEET EAST	21	NW¼ SW¼
SUMPWELL No. 1	1320 FEET NORTH	150 FEET WEST	20	SE¼ NE¼
SUMPWELL No. 2	980 FEET NORTH	1040 FEET WEST	20	SE¼ NE¼

ALL FROM THE EAST QUARTER CORNER OF SECTION 20, TOWNSHIP 28 SOUTH, RANGE 14 WEST, W.M.;  
 AND WITHIN SECTIONS 20 & 21, TOWNSHIP 28 SOUTH, RANGE 14 WEST, W.M., COOS COUNTY.

THE PURPOSE OF THIS MAP IS TO IDENTIFY THE LOCATION OF THE WATER RIGHT.  
 IT IS NOT INTENDED TO PROVIDE INFORMATION RELATIVE TO THE LOCATION OF  
 PROPERTY OWNERSHIP BOUNDARY LINES.