

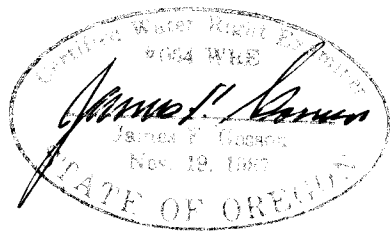
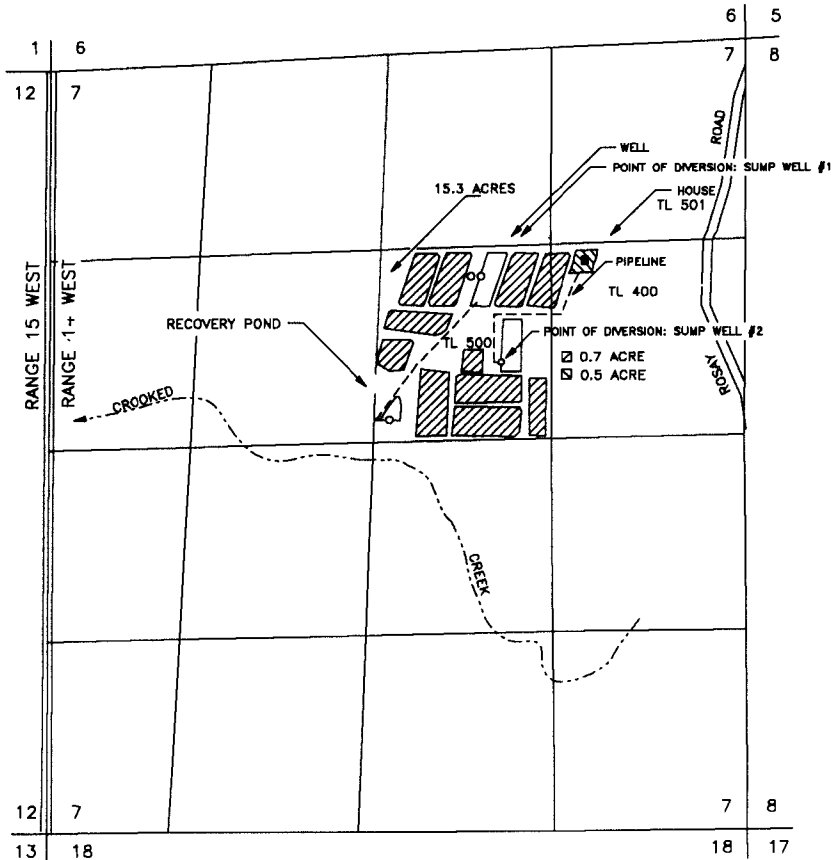

RECEIVED

AUG 7 1997

WATER RESOURCES DEPT.  
SALEM, OREGON

**FINAL PROOF SURVEY MAP**  
**IN THE NAME OF DELMER ROBISON**  
**SECTION 7, TOWNSHIP 29 SOUTH, RANGE 14 WEST, W.M.**  
**APPLICATION G-12101 PERMIT G-11390**



-  CRANBERRY OPERATIONS
-  IRRIGATION

DWG. 97-26

POINT OF DIVERSION FROM SUMP WELL #1 IS LOCATED 1640 FEET SOUTH AND 1800 FEET WEST FROM THE NORTHEAST CORNER OF SECTION 7; POINT OF DIVERSION FROM SUMP WELL #2 IS LOCATED 2210 FEET SOUTH AND 1660 FEET WEST FROM THE NORTHEAST CORNER OF SECTION 7, THE WELL IS LOCATED 1640 FEET SOUTH AND 1860 FEET WEST FROM THE NORTHEAST CORNER OF SECTION 7, ALL BEING WITHIN THE SW1/4 NE1/4 OF SECTION 7, TOWNSHIP 29 SOUTH, RANGE 14 WEST, W.M., COOS COUNTY.

THE PURPOSE OF THIS MAP IS TO IDENTIFY THE LOCATION OF THE WATER RIGHT. IT IS NOT INTENDED TO PROVIDE INFORMATION RELATIVE TO THE LOCATION OF PROPERTY OWNERSHIP BOUNDARY LINES.