

RECEIVED

SEP 10 1992

WATER RESOURCES DEPT.
SALEM, OREGON

T.7S., R.2W., W.M.

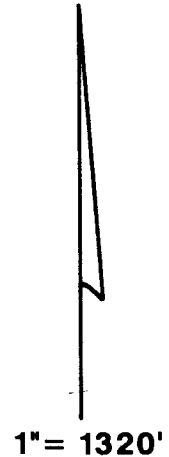
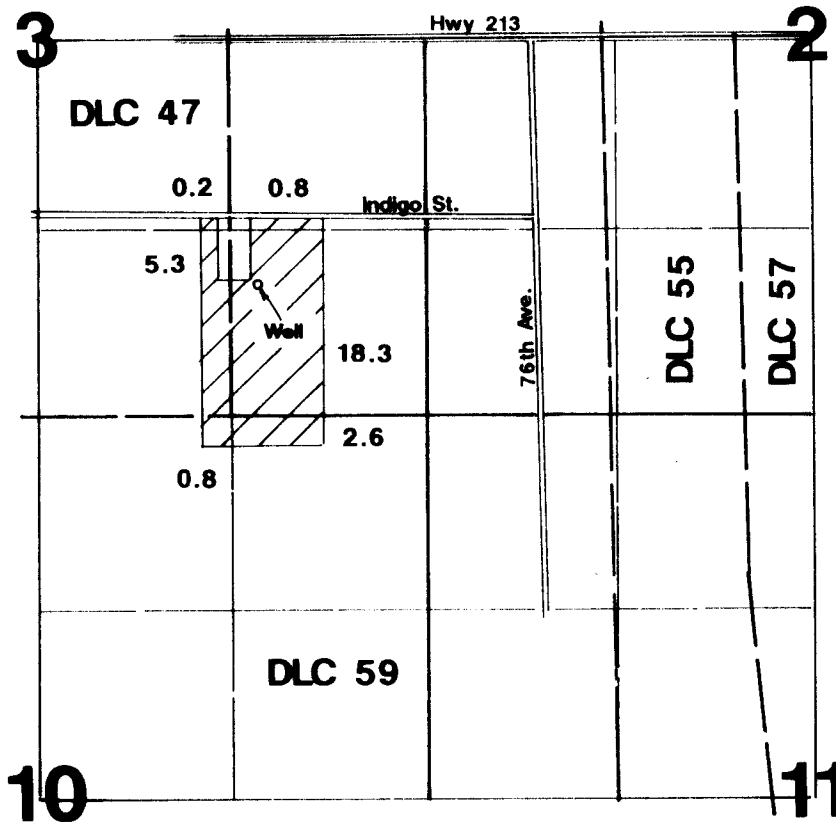

Well located 900'N & 1120'W from SE corner of Section 3.

Final Proof Survey

Application #G-12027

Permit # G-10984

In Name Of

Glen Hansberry

Surveyed on July 1, 1992 by J. Grimm

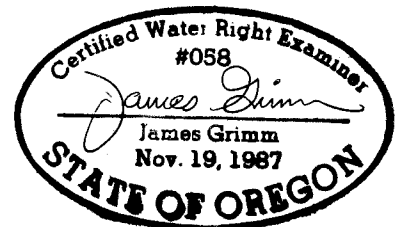

THIS MAP WAS PREPARED FOR THE PURPOSE OF IDENTIFYING THE LOCATION OF A WATER RIGHT ONLY AND IS NOT INTENDED TO PROVIDE LEGAL DIMENSIONS OR LOCATION OF PROPERTY OWNERSHIP LINES.