

CLAIM OF BENEFICIAL USE  
FOR: THOMAS BRUCE STUBBLEFIELD  
AND SUSAN M STUBBLEFIELD  
BY: DUANE W. KIRBY  
T31S, R3W W.M., SEC 32  
TAX LOT 300  
DATE : JUNE 27, 2006  
APPLICATION NO T-9470

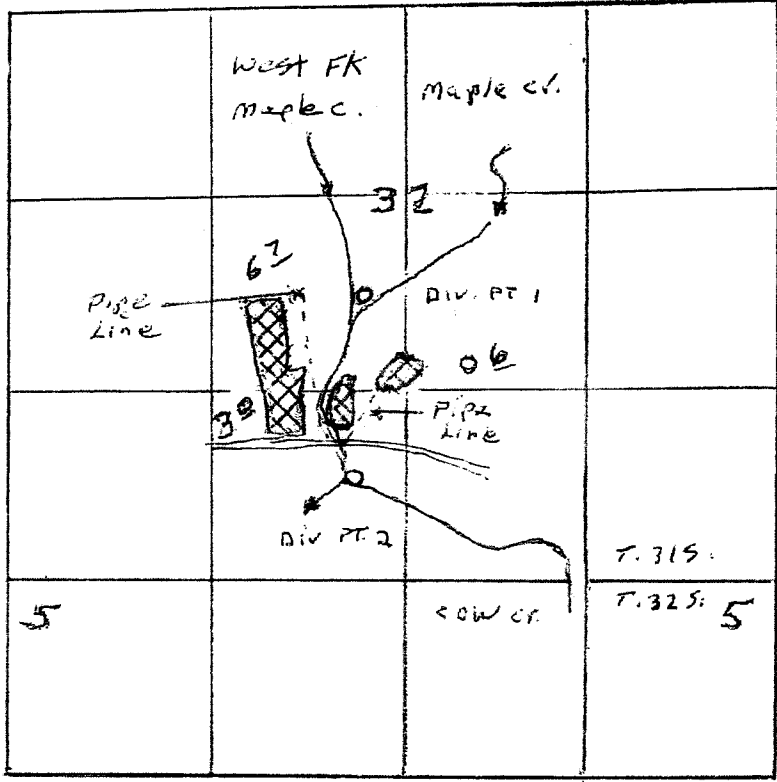

SCALE: 1" = 1320'



DIVERSION POIT NO 1 1540 FEET NORTH  
AND 2270 FEET EAST OF SOUTH WEST  
CORNER OF SECTION 32

DIVERSION POINT NO 2 690 FEET NORTH  
AND 2250 FEET EAST FROM SOUTH WEST  
CORNER OF SECTION 32

 Primary Maple Cr.

 Supplemental Cow cr.

THE PURPOSE OF THIS MAP IS TO  
IDENTIFY THE LOCATION OF THE  
WATER RIGHT. IT IS NOT INTENDED  
TO PROVIDE INFORMATION RELATIVE  
TO THE LOCATION OF PROPERTY  
OWNERSHIP BOUNDARY LINES.



CLAIM OF BENEFICIAL USE  
 FOR: MARCIA C. RODINE  
 BY: DUANE W. KIRBY  
 T31S, R3W, W.M., SEC 32  
 TAX LOT 301  
 DATE: JUNE 27, 2006  
 APPLICATION NO T-9470



SCALE: 1" = 1320'

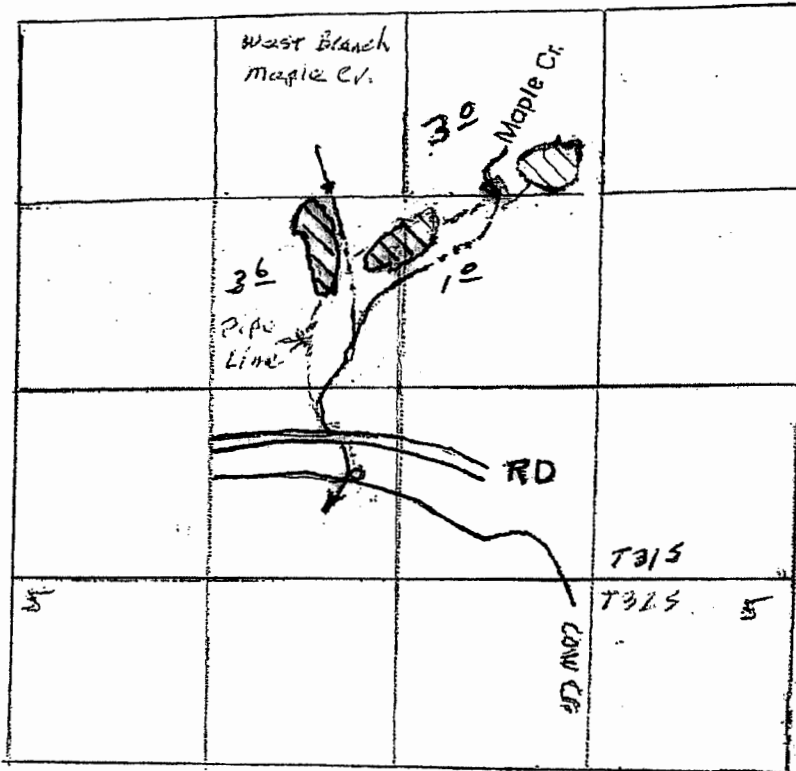

RECEIVED BY OWRD

SEP 29 2016

SALEM, OR

 SUPPLEMENTAL COW CR.

**Point of Diversion:** COW CREEK - 690 ft. N. and 2250 ft. E. all from the SW corner Section 32



THE PURPOSE OF THIS MAP IS TO IDENTIFY THE LOCATION OF THE WATER RIGHT. IT IS NOT INTENDED TO PROVIDE INFORMATION RELATIVE TO THE LOCATION OF PROPERTY OWNERSHIP BOUNDARY LINES.