

Sent to  
water resource  
1/28/06

CLAIM OF BENEFICIAL USE  
FOR: MARCIA C. RODINE  
BY: DUANE W. KIRBY  
T31S, R3W, W.M., SEC 32  
TAX LOT 301  
DATE: JUNE 27, 2006  
APPLICATION NO T-9470

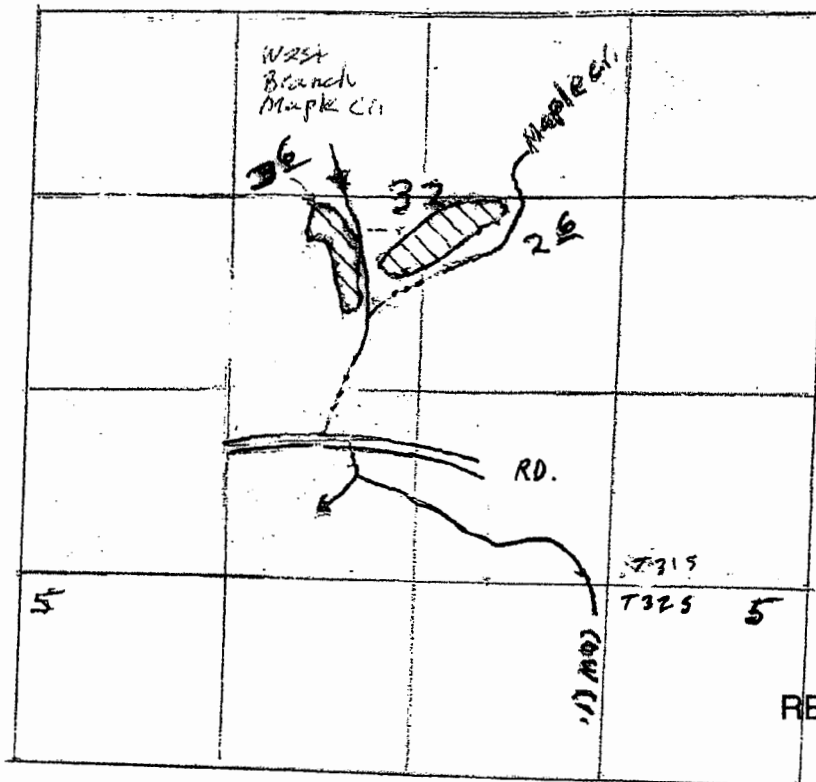

SCALE: 1" = 1320'



RECEIVED BY OWRD

SEP 29 2016

SALEM, OR

**Point of Diversion:** Portable pumping plant located along West Branch of Maple Creek (Special Order Vol. 9 pg. 358)

WEST BRANCH MAPLE CR.



THE PURPOSE OF THIS MAP IS TO IDENTIFY THE LOCATION OF THE WATER RIGHT. IT IS NOT INTENDED TO PROVIDE INFORMATION RELATIVE TO THE LOCATION OF PROPERTY OWNERSHIP BOUNDARY LINES.