

RECEIVED

SEP 15 1992

T.7S., R.1W. & R.2W., W.M.

WATER RESOURCES DEPT.
SALEM, OREGON

RECEIVED

SEP 15 1992

WATER RESOURCES DEPT.
SALEM, OREGON

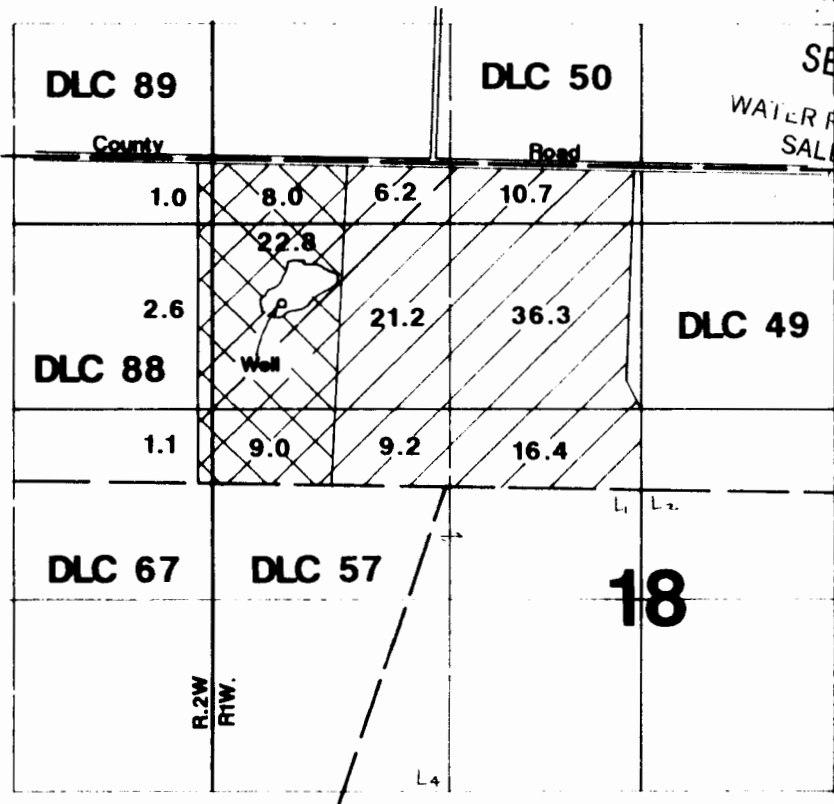

1" = 1320'

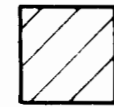

Suppl. Supply for 100.0 acres



Add'l Supply for 44.5 acres

Well located 530'S & 490'E from NW corner of Section 18.

Final Proof Survey

Application #G-12260

Permit #G-11269

In Name Of

Melvin King



Surveyed on August 29, 1992 by J. Grimm

THIS MAP WAS PREPARED FOR THE PURPOSE OF IDENTIFYING THE LOCATION OF A WATER RIGHT ONLY AND IS NOT INTENDED TO PROVIDE LEGAL DIMENSIONS OR LOCATION OF PROPERTY OWNERSHIP LINES.