

T.4S. R.2W. Sec. 8, 16 & 17, W.M.

RECEIVED

OCT 11 2016

WATER RESOURCES DEPT
SALEM, OREGON

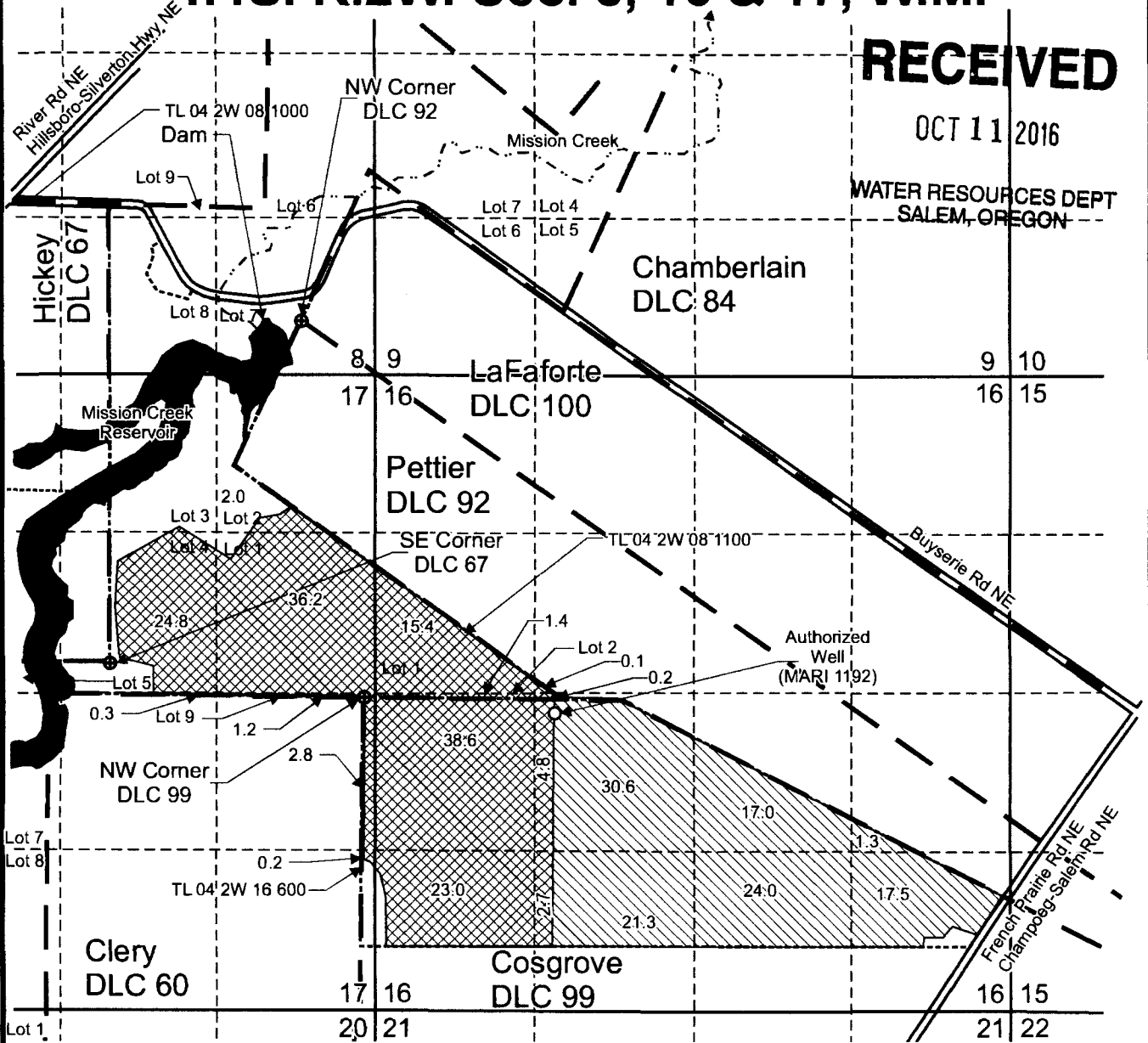

Authorized Well (MARI 1192) is located 130 feet south and 1,580 feet east from the NW corner, DLC 99.

 Area (111.7 Acres) irrigated under Certificate 36084, priority date February 7, 1964, not affected by this diminishment.

 Area (153.7 Acres) irrigated under Certificate 36084, priority date February 7, 1964, affected by this diminishment.

 Tax lot boundary

 Donation Land Claim boundary

 Irrigation main line

Scale: 1" = 1,320'

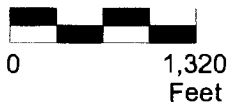

This map was prepared for the purpose of identifying the location of a water right only and is not intended to provide legal dimensions or location of property ownership lines.

Partial Diminishment Map
Certificate 36084

James N. Smith, LLC
T.4S. R.2W. Sec. 8, 16 & 17, W.M.

09/2016

Pacific Hydro-Geology Inc.

MCRScert26084DimMap.cdr