

RECEIVED

AUG 0 2011

WATER RESOURCES DEPT
SALEM, OREGON

SECTION 19, T 1 N, R 1 E, W.M.
APPLICATION S-80300, PERMIT S-51985
MULTNOMAH COUNTY

18 17
19 20

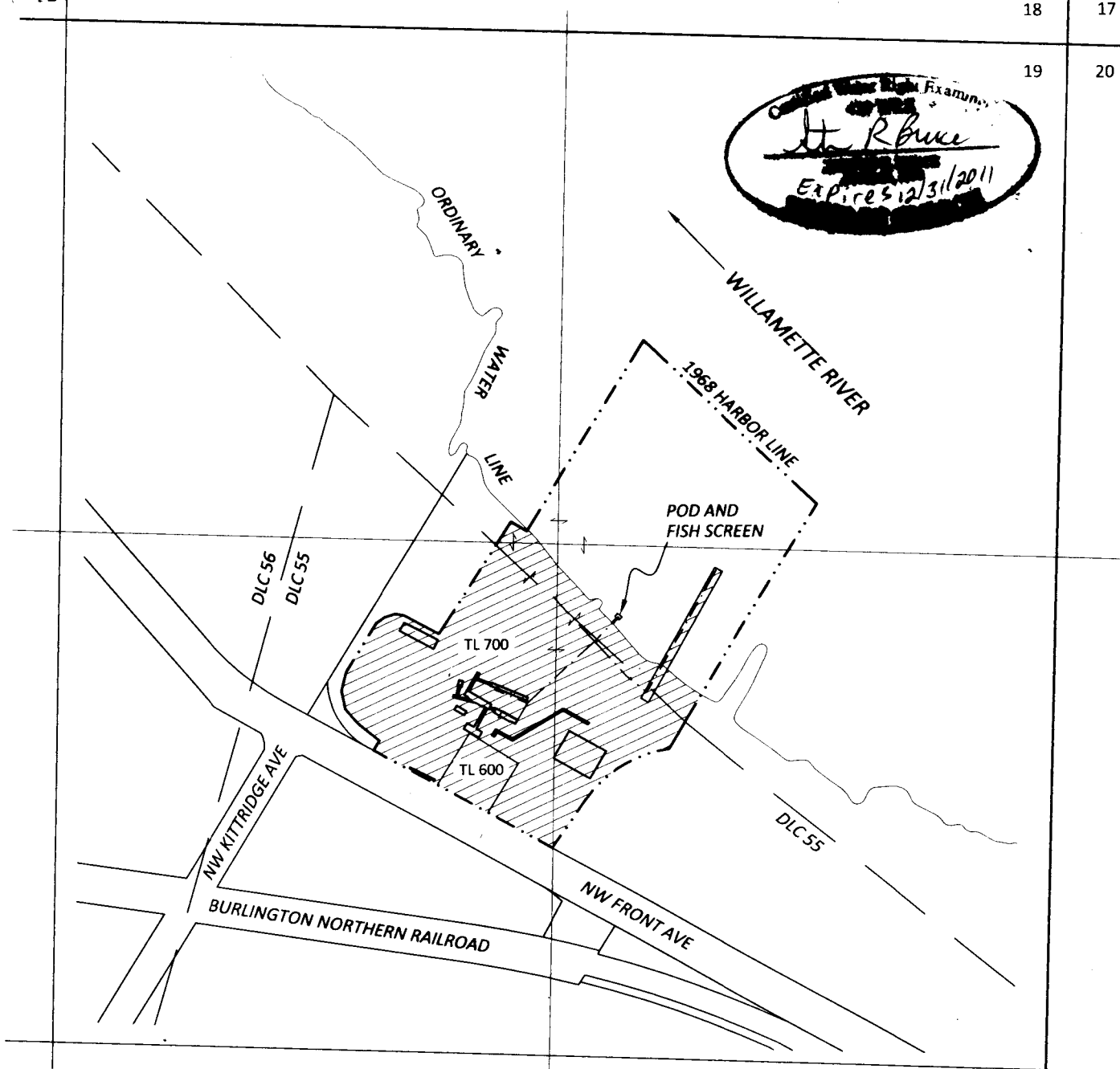

THIS MAP IS NOT INTENDED TO
PROVIDE LEGAL DIMENSIONS OR
LOCATIONS OF PROPERTY
OWNERSHIP LINES

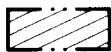

PLACE OF USE

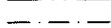

2 - INCH - DIAMETER PIPELINE

POD LOCATED 3,880 FT N AND 1,080 FT W
FROM SE CORNER OF SECTION 19

SITE INSPECTION CONDUCTED JUNE 13, 2011

SKOOKUM
WATER ASSOCIATES INC

P.O. BOX 80174
PORTLAND, OR 97280
(503) 319-8926

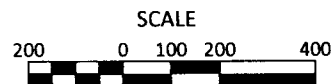

1 INCH = 400 FEET

FIGURE 1

CLAIM OF BENEFICIAL USE MAP
LAKESIDE INDUSTRIES, INC.

10039.001
JUNE 14, 2011
11048_SB.DWG