

# Claim of Beneficial Use

In The Name of

JAMES AND SHARON VAN LOAN

T26S-R03W-S10

Tax Lot: 200 AND 201

## DOMESTIC USE EXPANDED

Application: S-84158

Permit: S-54245

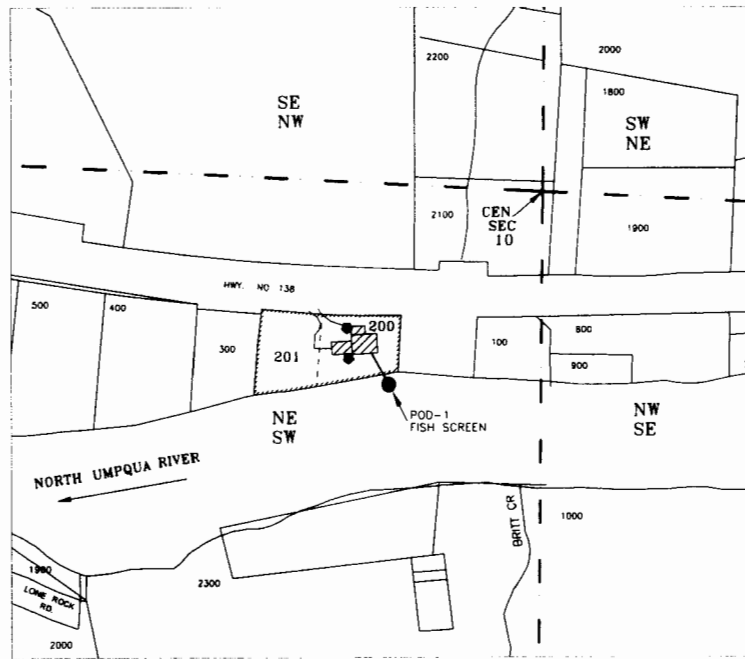

RECEIVED

WATER RIGHTS DIVISION

POD-1 & Fish Screen: More or less 404 feet South and 321 feet West from the center corner 1/4 corner of Section 10.

## DOMESTIC EXPANDED

EXPANDED ACREAGE IN LOTS 200 AND 201  
LOCATION WITHIN NOT SHOWN.

- DOMESTIC SPIGOT, 2 ATTACHED WITH ADAPTER FOR BACKFEED NOT SHOWN
- POD-1 and Fish Screen
- BURIED MAIN LINE 1-1/4" BLACK POLY.
- ▨ DOMESTIC
- ▭ TAX LOT'S EXPANDED BOUNDARY ACREAGE.

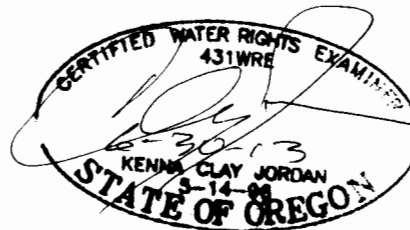

NORTH

1" = 400'

This map is not intended to provide legal dimensions and/or locations of property ownership lines.

Locations per 1/4 1/4 are derived by assumed fit of aerial photo orientation to ground surveys and/or tax assessor maps.

**JORDAN ENGINEERING**  
460 JORDAN LANE  
ROSEBURG, OREGON 97471  
(541) 673-1931

05-23-11