

T8S, R40E, Sections 9, 10 and 16, W.M.

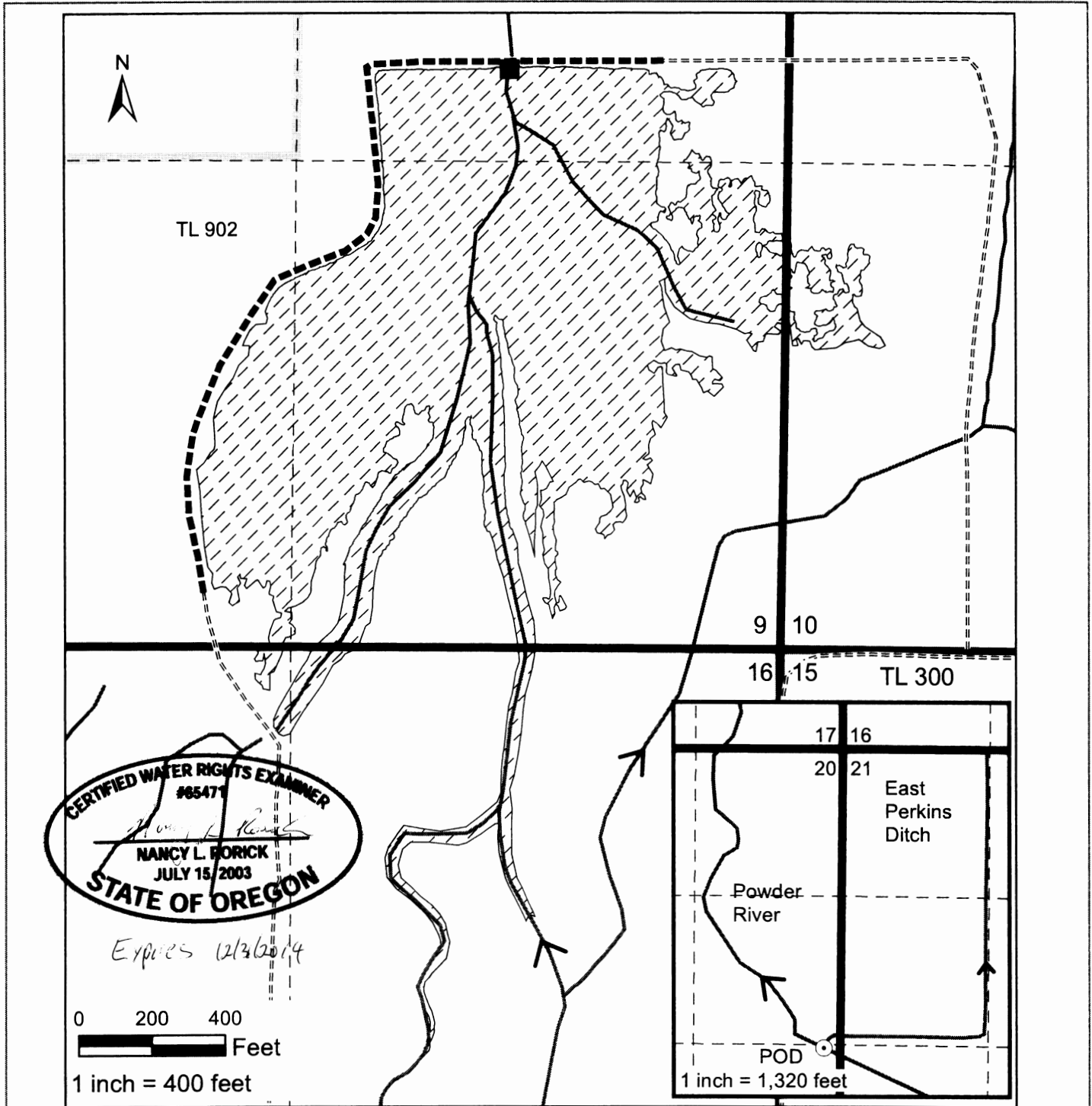

- Pond B
- Weir and measuring point
- Tax lot line
- Quarter quarter line
- Section line
- Dirt road
- Ditch / Constructed waterway
- Berm

This map is not intended to provide legal dimensions or locations of property ownership lines.

The Perkins Ditch POD on the Powder River is located 2660 feet south and 140 feet west of the NE corner of Section 20, T8S, R40E.

The dam is located 735 west and 1,585 feet north of the southeast corner of Section 9, T8S, R40E.

Claim of Beneficial Use, Pond B  
 Permit R13080 and Application R84544  
 Tax Lot 902  
 Baldock Slough, LLC  
 map prepared by  
 Nancy Rorick Consulting