

**RECEIVED**

SEP 25 1996

WATER RESOURCES DEPT.  
SALEM, OREGON

T. 2 N., R. 11 E., WM

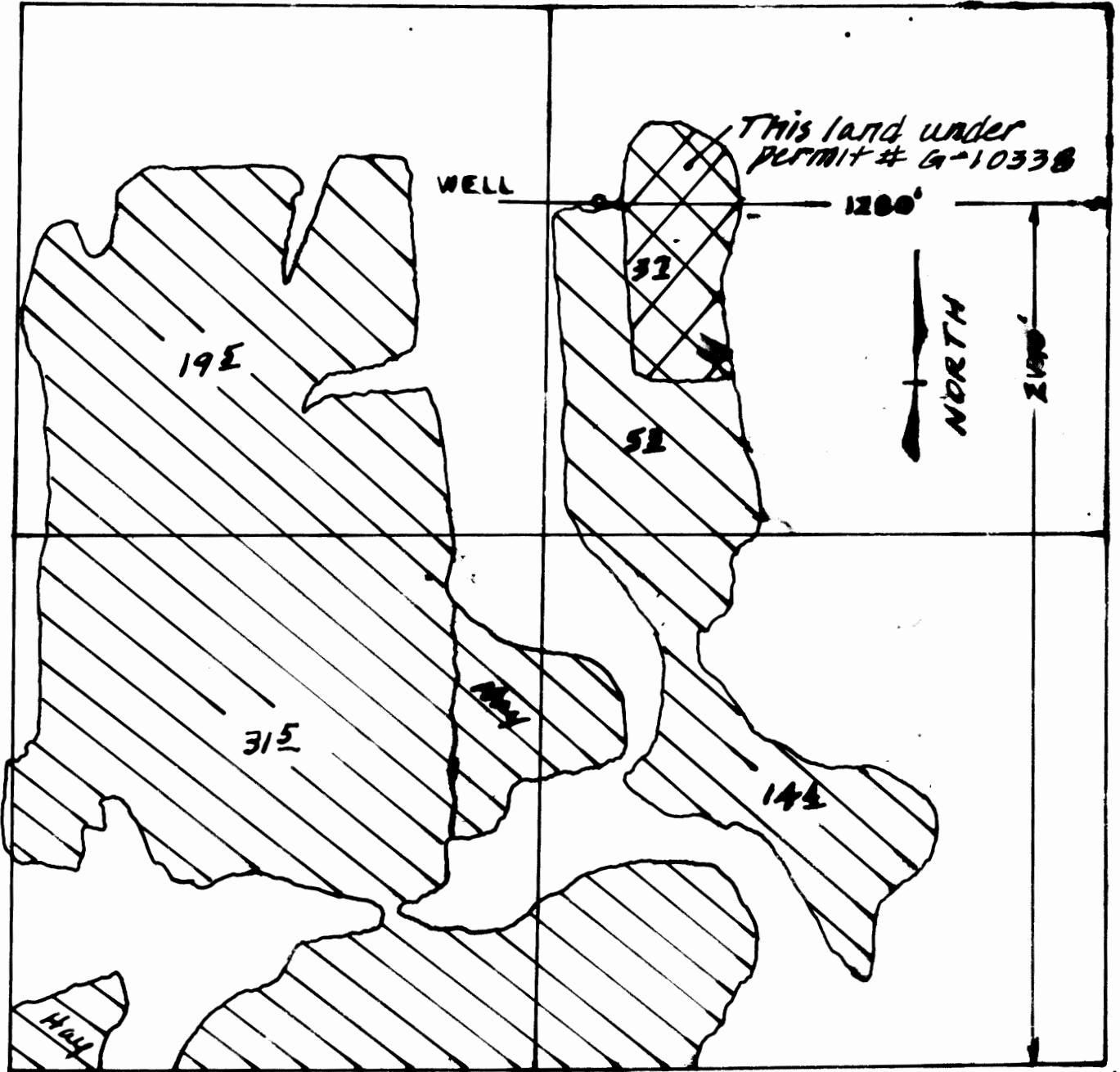

5/4 CORNER  
SEC 12

**FINAL PROOF SURVEY  
UNDER**

APPLICATION # G-11733  
~~PERMIT # G-11733~~  
IN THE NAME OF:  
KENNETH HUDSON

Surveyed 9/20/96 by Daryl Ingebo

SCALE: 1" = 400'