

RECEIVED BY OWRD

AUG 27 2012

SALEM, OR



SCALE: 1" = 1320'

T.13S., R.29E.

FD BRASS CAP

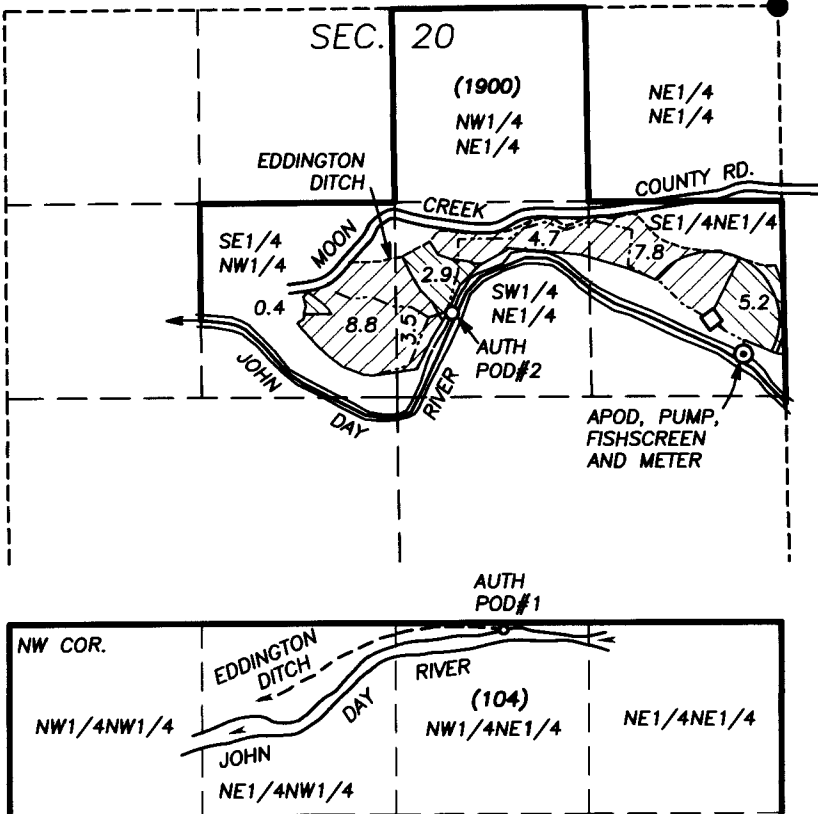

AUTHORIZED POD NO. 1 IS 50' SOUTH & 3380' EAST OF THE NW CORNER SEC. 27  
 AUTHORIZED POD NO. 2 IS 2110' SOUTH & 2240' WEST OF THE NE CORNER SEC. 20  
 ADDITIONAL POD IS 2400' SOUTH AND 250' WEST OF THE NE CORNER SEC. 20

**FINAL PROOF SURVEY**  
 UNDER  
**APPLICATION T-8533**  
**PERMIT NO. SPECIAL ORDER**  
**VOL. 55, PAGE 1295**  
 IN NAME OF  
**JAMES P. & ELNA I. BLANCHET**

- AUTHORIZED POD
- APOD-PUMP, FISH SCREEN & FLOWMETER
- CENTER PIVOT

PLACE OF USE

- FIRST RIGHT
- SECOND RIGHT

- DITCH
- BURIED MAIN LINE

( ) TAX LOT NO.

BY

ROBERT D. BAGETT  
 217 N. CANYON BLVD.  
 JOHN DAY, OREGON  
 (541) 575-1251

JULY 16, 2012

NOTE: THE PREPARATION OF THIS MAP WAS FOR THE PURPOSE OF IDENTIFYING THE LOCATION OF THE PROPOSED WATER RIGHT AND HAS NO INTENT TO PROVIDE DIMENSIONS OR LOCATION OF PROPERTY OWNERSHIP LINES.

