

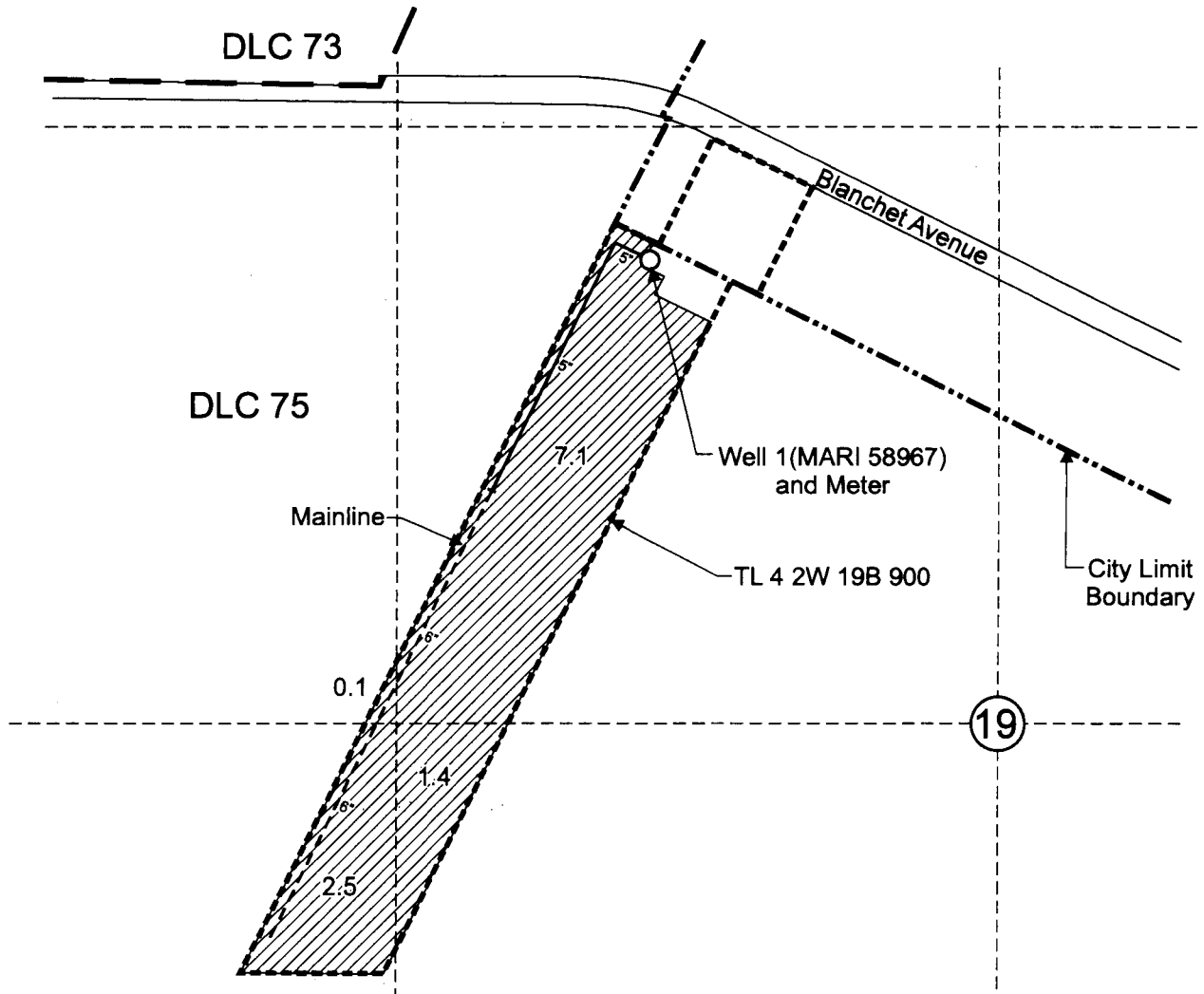



# T.4S. R.2W. Section 19, W.M.



Well 1 (MARI 58967) is located 1,020 feet north and 760 feet west from the C 1/4 corner, Section 19.

 Area (11.1 Acres) irrigated under Application G-15905, Permit G-15520.

-  Tax lot boundary
-  Buried irrigation mainline
-  Above-ground irrigation mainline

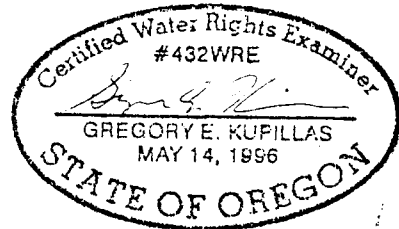

EXPIRATION DATE: 6/30/2011

Scale: 1" = 400'

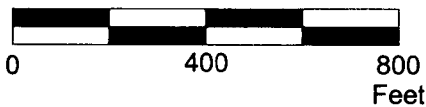

This map was prepared for the purpose of identifying the location of a water right only and is not intended to provide legal dimensions or location of property ownership lines.



DrescherCOBUMap.cdr

Pacific Hydro-Geology Inc.

4/2011 - bgp

**Claim of Beneficial Use Map**  
Application G-15905, Permit G-15520

Dan and Jodi Drescher  
T.4S. R.2W. Section 19, W.M.